



SCHEDULE OF OFFSITE WORKS - Site off B863	Action
1. Improvements to existing access.	

Schedule 16

KEY

- THC Site
- Access
- Wayleaves
- Works for Third Parties

Rev. 7th March

- Scottish Water Main
- Scottish Water Sewer

Symbol	Label	Dimension
	11,000 volt overhead line	
	Low voltage overhead line	
	Low voltage underground cables	
	High voltage underground cables	
	Telephone Facilities	
	Duct Facilities	

Scale 1 : 1000

SERVICE	DESCRIPTION
NATURAL GAS	N/A
WATER	SCOTTISH WATER (WERNEISS) REF W5/DW/M/A 18.24.28428 DATE 11/02/04
DPG (CLASSROOMS)	NO OFF SITE WORKS
CEL (HEATING)	NO OFF SITE WORKS
BT	
ELECTRICITY (KITCHEN)	

SCHEDULE OF OFFSITE WORKS - Riverside Road Site	Action
1. Access roadway from Riverside Road.	
2. Provision crossing of Riverside Road.	
3. Modify existing access on Riverside Road.	
4. Modify Access Centre car park.	
5. Footpath link to Leisure Centre.	
6. Upgrade footpath link to sports field.	
7. Upgrade footpath link to sports field.	
8. Surface Water outfall to River Urvan.	
9. Four Water sewer connection to Scottish Water system.	
10. Four Water sewer connection to Scottish Water system.	
11. Buried access to adjacent dwelling.	
12. Buried water services across Riverside Road.	
13. Scottish Water connection from public highway to site.	
14. Existing LV cable from River Bank pole to existing S&SE sub-station in Riverside Drive.	
15. Existing LV cable from River Bank pole to existing S&SE sub-station in Riverside Drive.	
16. New HV cable laid from River Bank pole to existing S&SE sub-station in Riverside Drive.	

Site off B863 - Offsite Works, Wayleaves and Accesses 1:1000

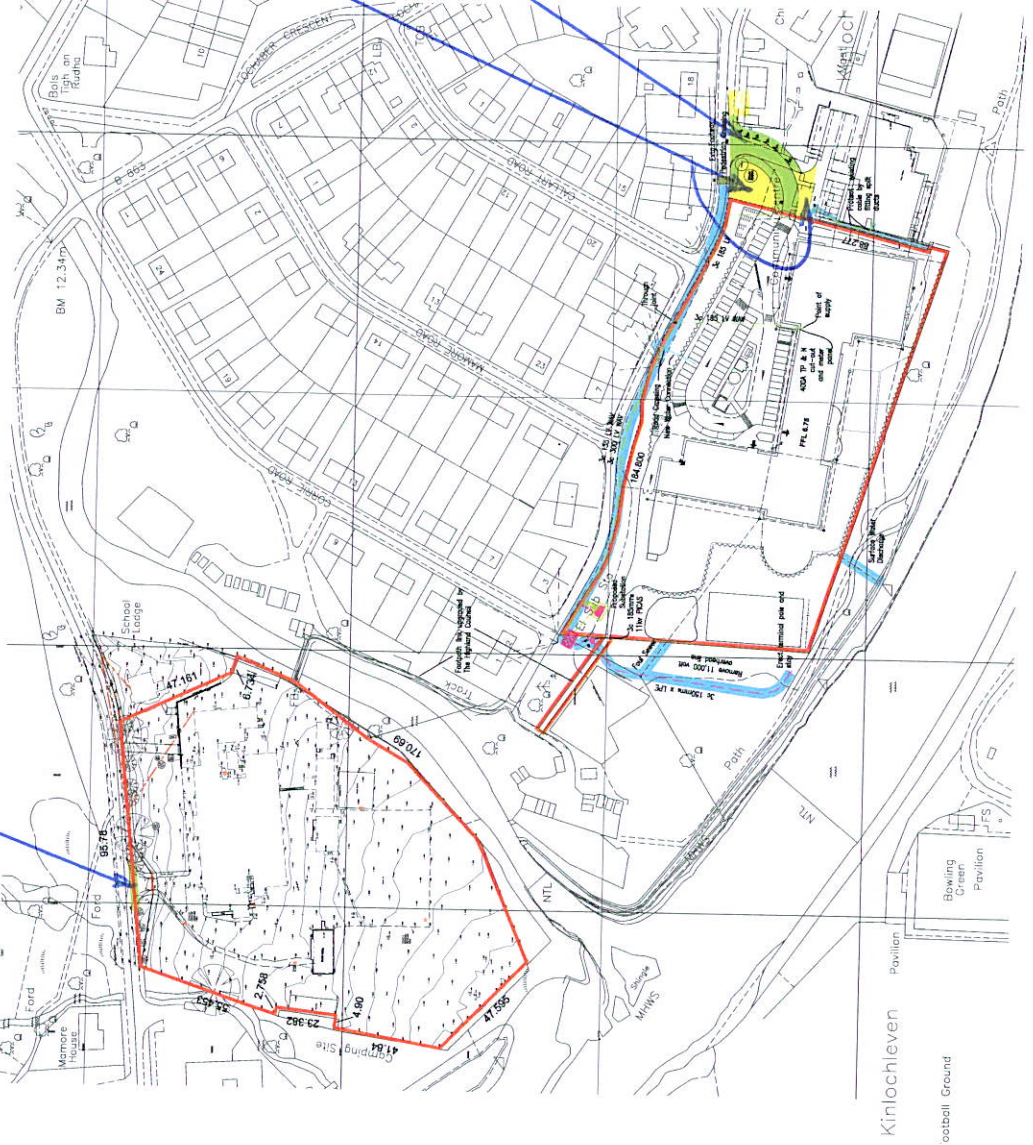

Riverside Road Site - Offsite Works, Wayleaves and Accesses 1:1000

B. Boundary of Riverside Road site extracted along footpath.

15.11.05
A. Wallace White & Carter, 11/11/05
scaled. Schedules for offsite works incorporated and third party works areas amended/added. Various notes added.

19.03.05
Date By

A.F. Cruden Associates
Consulting Engineers
24 Inverness Way IOU
Inverness IV1 1QU
Tel: 01463 719200
Fax: 01463 719201
email: crudenaf@aol.com

Client:
ALPHA SCHOOLS/
THE EDUCATION
DEPARTMENT
HIGHLAND SCHOOLS PPP2

Project:
KINLOCHLEVEN COMBINED
PRIMARY & SECONDARY SCHOOL

Drawing

OFF-SITE WORKS

Issue	PLANNING
Drawing No.	CA3278/KNFS/PW/19
Drawn By	DAC
Date	15.09.05
Scale	1:1000
Rev.B	

This drawing is copyright of A.F. Cruden Associates