



# CARRBRIDGE

BOAT OF GARTEN - DUTHIL

ADOPTED PLAN

SEPTEMBER 1997

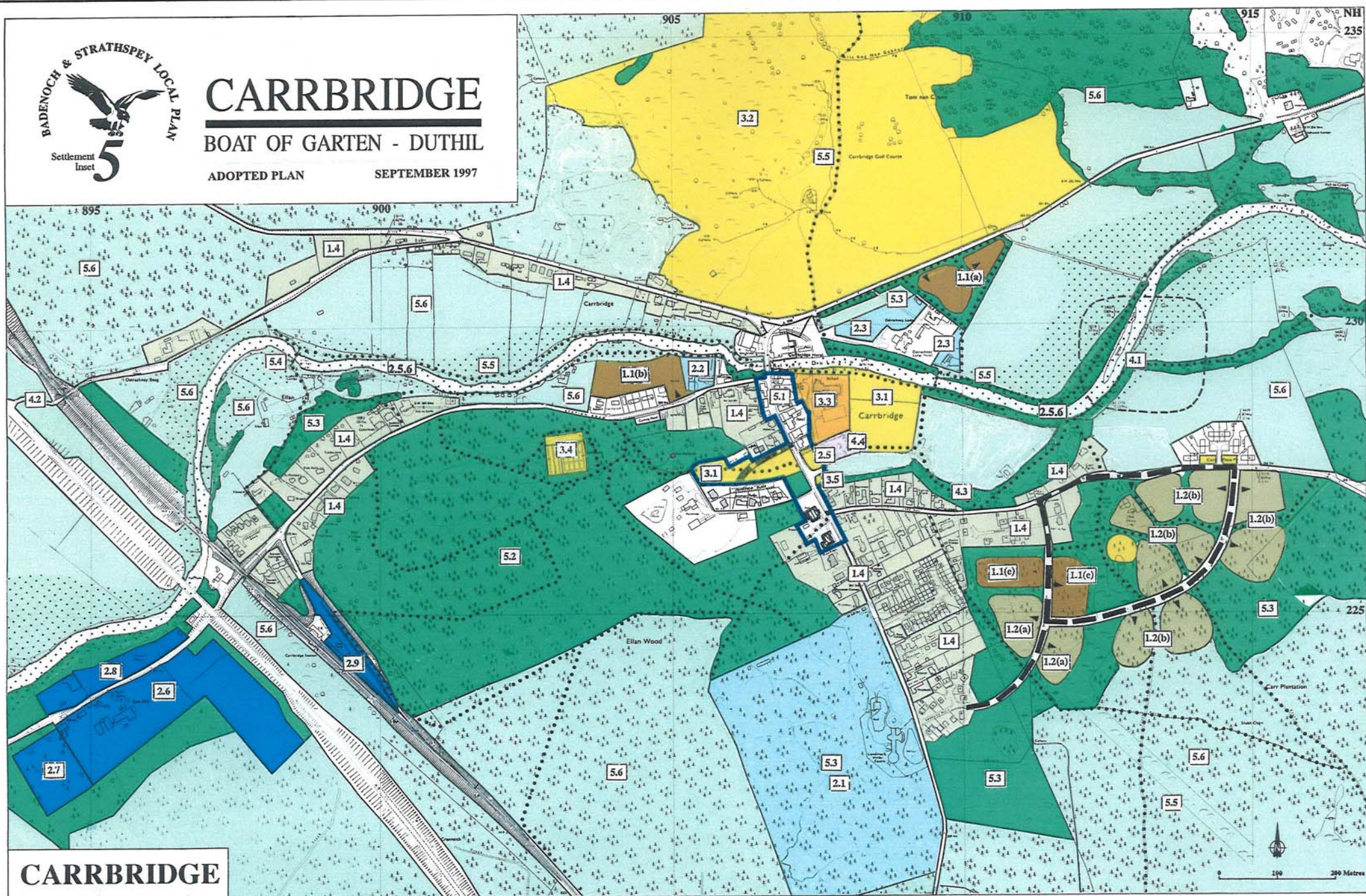

**CARRBRIDGE**

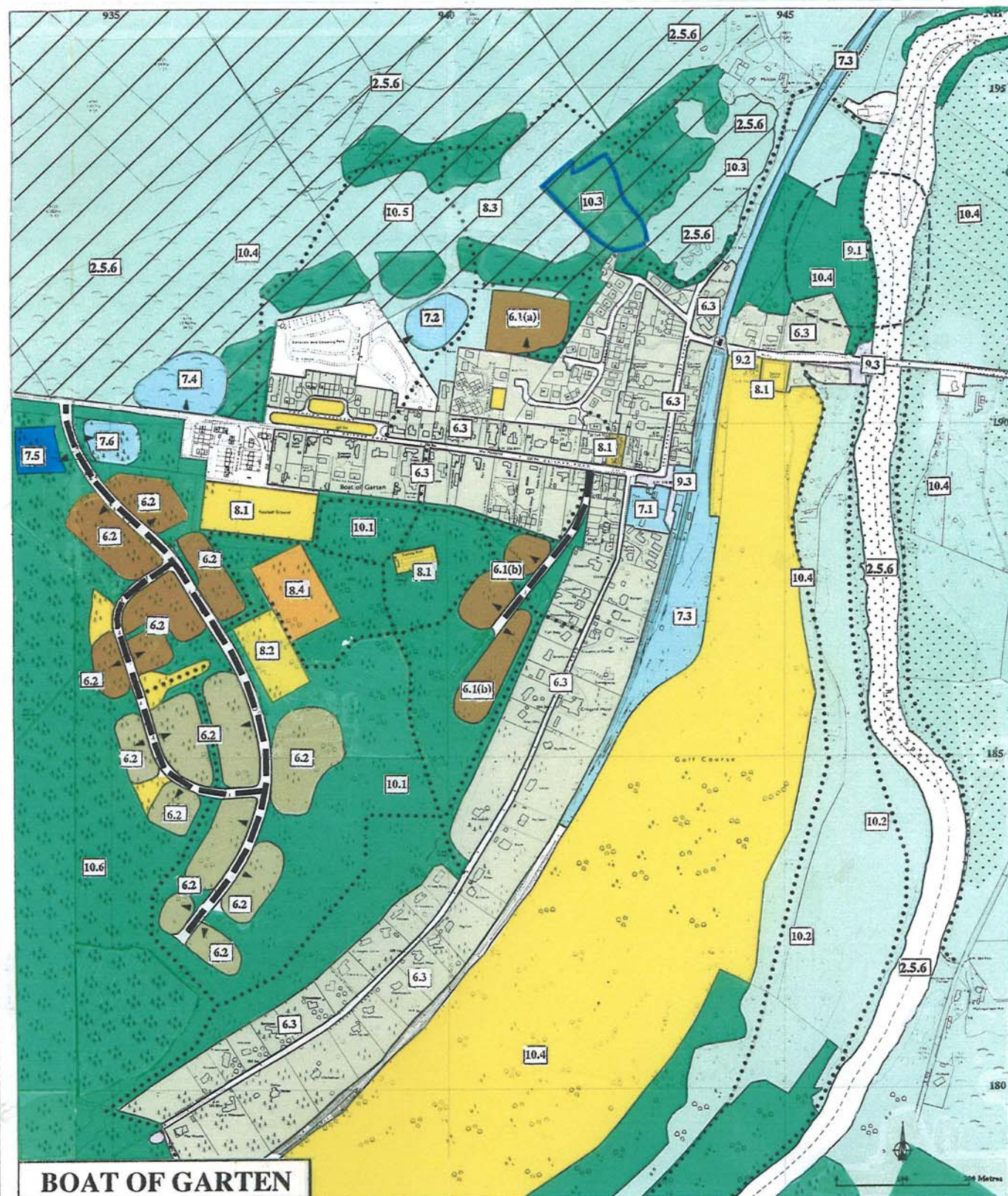

**BOAT OF GARTEN**

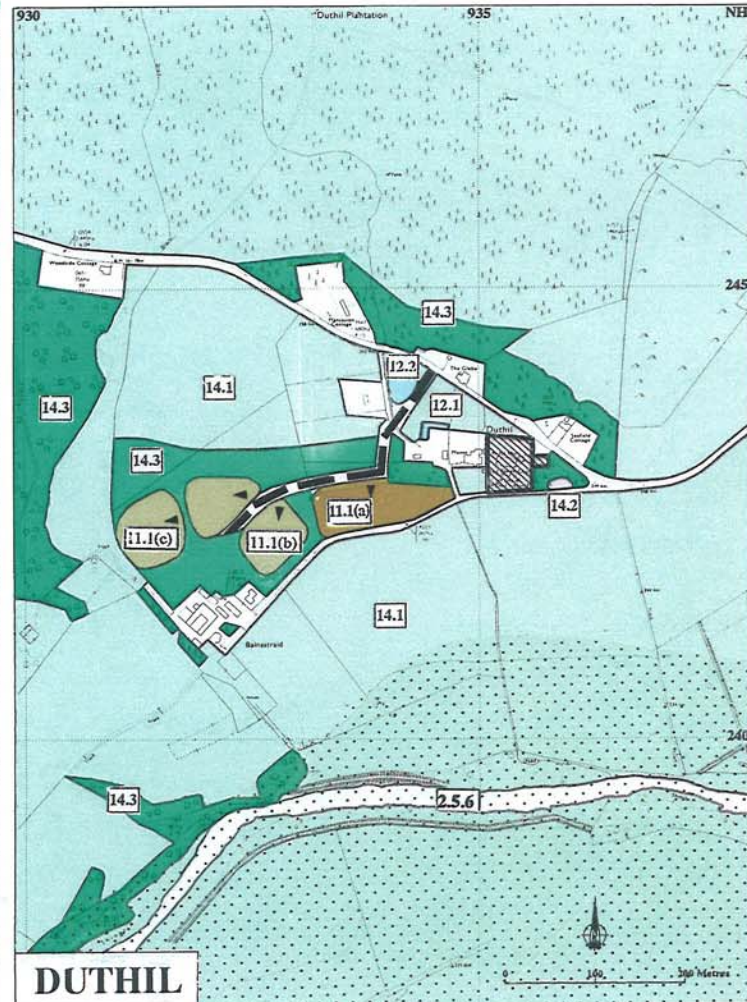

**DUTHIL**

**HOUSING**

- New Development
- Long Term
- Infill

**EMPLOYMENT**

- Business / Industry
- Commerce / Tourism

**COMMUNITY**

- Recreation / Open Space
- Public Buildings
- Footpaths

**SERVICES**

- Roads
- Car Park
- Sewage Treatment Safeguarding

**ENVIRONMENT**

- Listed Buildings
- Amenity Woodland
- Forestry / Restraint
- Flood Risk
- Enhancement
- Other Nature Conservation Sites

THE HIGHLAND COUNCIL  
JOHN D. RENNILSON  
DIRECTOR OF PLANNING  
Tel. 01463 702250