

1. ALL DIMENSIONS IN METRES UNLESS OTHERWISE NOTED. DO NOT SCALE.
2. ALL LEVELS IN METRES AND REDUCED TO CHART DATUM UNLESS OTHERWISE NOTED.
3. THIS DRAWING TO BE READ IN CONJUNCTION WITH LISTED REFERENCE DRAWINGS:
 UHRD-ACM-ZZ-GE-MT-10112,
 UHRD-ACM-ZZ-GE-MT-10113,
 UHRD-ACM-ZZ-GE-MT-10114,
 UHRD-ACM-ZZ-GE-MT-10116.
4. CONTOURS HAVE BEEN GENERATED FROM ASPECT BATHYMETRIC SURVEY CARRIED OUT 14/12/2017 AND TOPOGRAPHIC SURVEY CARRIED OUT BY PROPERTY & LAND SURVEYS (HLS) LTD ON 09/02/2017.
5. GROUND INVESTIGATION INFORMATION HAS BEEN GENERATED FROM INVESTIGATION CARRIED OUT BY HOLEQUEST BETWEEN 04/07/2017 - 01/08/2017.
6. DS03, DS04 AND DS05 IS GENERATED FROM GROUND INVESTIGATION INFORMATION CARRIED OUT BY ASPECT SURVEYS 2nd & 3rd APRIL 2018.
7. ALL COORDINATES ARE IN WGS 1984 GEOGRAPHICAL SYSTEM. DEGREES DECIMAL MINUTES.
8. THIS DRAWING SHALL BE READ IN CONJUNCTION WITH MARINE SCOTLAND'S PRE DISPOSAL RESULTS FORM.

FOR INFORMATION ONLY

| ISSUE/REVISION | | |
|----------------|----------|-------------|
| I/R | DATE | DESCRIPTION |
| | | |
| | | |
| | | |
| | | |
| | | |
| | | |
| | | |
| | | |
| | | |
| | | |
| | | |
| P01 | 22/02/19 | First Issue |
| I/R | DATE | DESCRIPTION |

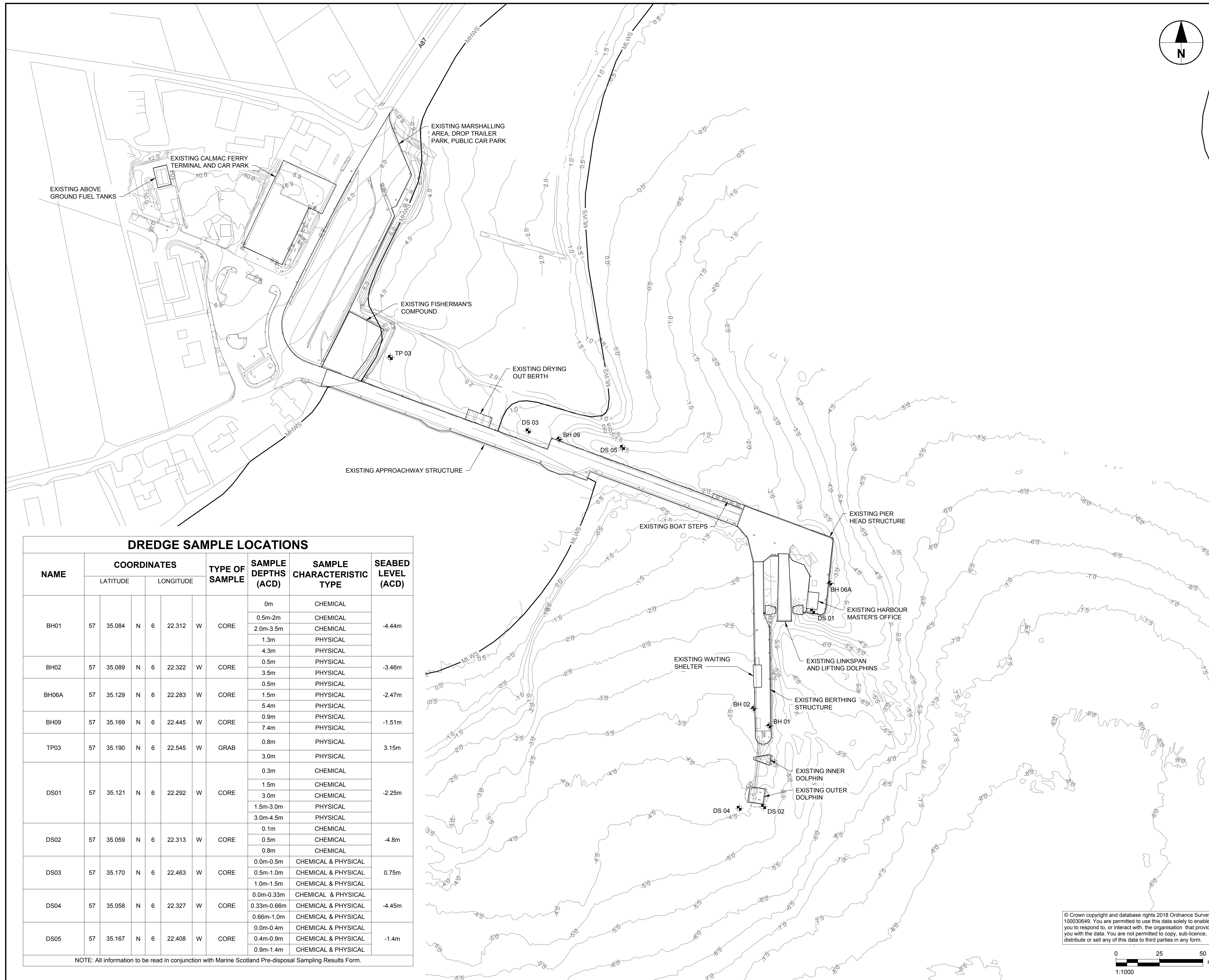

DREDGE SAMPLE LOCATIONS

| NAME | COORDINATES | | TYPE OF SAMPLE | SAMPLE DEPTHS (ACD) | SAMPLE CHARACTERISTIC TYPE | SEABED LEVEL (ACD) | | | |
|-------|-------------|-----------|----------------|---------------------|----------------------------|--------------------|-------------|---------------------|--------|
| | LATITUDE | LONGITUDE | | | | | | | |
| BH01 | 57 | 35.084 | N 6 | 22.312 | W | CORE | 0m | CHEMICAL | -4.44m |
| | | | | | | | 0.5m-2m | CHEMICAL | |
| | | | | | | | 2.0m-3.5m | CHEMICAL | |
| | | | | | | | 1.3m | PHYSICAL | |
| BH02 | 57 | 35.089 | N 6 | 22.322 | W | CORE | 0.5m | PHYSICAL | -3.46m |
| | | | | | | | 3.5m | PHYSICAL | |
| | | | | | | | 4.3m | PHYSICAL | |
| BH06A | 57 | 35.129 | N 6 | 22.283 | W | CORE | 0.5m | PHYSICAL | -2.47m |
| | | | | | | | 1.5m | PHYSICAL | |
| | | | | | | | 5.4m | PHYSICAL | |
| BH09 | 57 | 35.169 | N 6 | 22.445 | W | CORE | 0.9m | PHYSICAL | -1.51m |
| | | | | | | | 7.4m | PHYSICAL | |
| TP03 | 57 | 35.190 | N 6 | 22.545 | W | GRAB | 0.8m | PHYSICAL | 3.15m |
| | | | | | | | 3.0m | PHYSICAL | |
| DS01 | 57 | 35.121 | N 6 | 22.292 | W | CORE | 0.3m | CHEMICAL | -2.25m |
| | | | | | | | 1.5m | CHEMICAL | |
| | | | | | | | 3.0m | CHEMICAL | |
| | | | | | | | 1.5m-3.0m | PHYSICAL | |
| DS02 | 57 | 35.059 | N 6 | 22.313 | W | CORE | 0.1m | CHEMICAL | -4.8m |
| | | | | | | | 0.5m | CHEMICAL | |
| | | | | | | | 0.8m | CHEMICAL | |
| DS03 | 57 | 35.170 | N 6 | 22.463 | W | CORE | 0.0m-0.5m | CHEMICAL & PHYSICAL | 0.75m |
| | | | | | | | 0.5m-1.0m | CHEMICAL & PHYSICAL | |
| | | | | | | | 1.0m-1.5m | CHEMICAL & PHYSICAL | |
| DS04 | 57 | 35.058 | N 6 | 22.327 | W | CORE | 0.0m-0.33m | CHEMICAL & PHYSICAL | -4.45m |
| | | | | | | | 0.33m-0.66m | CHEMICAL & PHYSICAL | |
| | | | | | | | 0.66m-1.0m | CHEMICAL & PHYSICAL | |
| | | | | | | | 0.0m-0.4m | CHEMICAL & PHYSICAL | |
| DS05 | 57 | 35.167 | N 6 | 22.408 | W | CORE | 0.4m-0.9m | CHEMICAL & PHYSICAL | -1.4m |
| | | | | | | | 0.9m-1.4m | CHEMICAL & PHYSICAL | |

NOTE: All information to be read in conjunction with Marine Scotland Pre-disposal Sampling Results Form.

© Crown copyright and database rights 2018 Ordnance Survey
 100030649. You are permitted to use this data solely to enable
 you to respond to, or interact with, the organisation that provided
 you with the data. You are not permitted to copy, sub-licence,
 distribute or sell any of this data to third parties in any form.

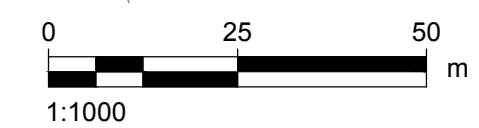

This drawing has been prepared for the use of AECOM's client. It may not be used, modified, reproduced or relied upon by third parties, except as agreed by AECOM or as required by law. AECOM accepts no responsibility and denies any liability whatsoever, to any party that uses or relies on this drawing without AECOM's express written consent. All measurements must be obtained from the stated dimensions.