

ROSS & CROMARTY EAST LOCAL PLAN

(As Continuing in Force, July 2015)

PLANA IONADAIL ROS IS CHROMBAIDH AN EAR

InsetMaps



ADOPTED PLAN ▼ FEBRUARY 2007

Provisions of Local Plan map(s) as continuing in force, July 2015

The provisions of the Proposals Map (including any inset contained in or accompanying it and the policies and proposals shown on such inset) and related notations, referencing and explanatory text, only to the extent to which those provisions show, illustrate or explain any provision of the local plan which is continued in force by the Parliamentary Order*, but also only to the extent detailed in the Retention Schedule - at the front of this version of the Local Plan - as still continuing in force from July 2015 (following adoption of the Inner Moray Firth Local Development Plan).

**(The Town and Country Planning (Continuation in force of Local Plans (Highland) (Scotland) Order 2012)*

Rural Settlements		Written Statement			Written Statement
Ardeer	Page 32	Page 33	Ardeer	Page 32	Page 33
Ara	Page 10	Page 34	Ara	Page 10	Page 34
Ardross	Page 20	Page 34	Ardross	Page 20	Page 34
Ardross Mains	Page 20	Page 34	Ardross Mains	Page 20	Page 34
Cuillich	Page 20	Page 34	Cuillich	Page 20	Page 34
Balblair	Page 30	Page 34	Balblair	Page 30	Page 34
Blairninich	Page 30	Page 34	Blairninich	Page 30	Page 34
Barbraville	Page 30	Page 34	Barbraville	Page 30	Page 34
Croftnacreich	Page 30	Page 34	Croftnacreich	Page 30	Page 34
St. Martys Mains	Page 30	Page 34	St. Martys Mains	Page 30	Page 34
Ardeer	Page 32	Page 33	Ardeer	Page 32	Page 33
Easter Kinkell	Page 40	Page 35	Easter Kinkell	Page 40	Page 35
Ferintosh	Page 50	Page 35	Ferintosh	Page 50	Page 35
Gorstan	Page 50	Page 35	Gorstan	Page 50	Page 35
Jemimaville	Page 50	Page 35	Jemimaville	Page 50	Page 35
Kilcoy	Page 60	Page 35	Kilcoy	Page 60	Page 35
Killen	Page 60	Page 35	Killen	Page 60	Page 35
Milton - Redcastle	Page 60	Page 35	Milton - Redcastle	Page 60	Page 35
Mounthigh	Page 70	Page 35	Mounthigh	Page 70	Page 35
Newhall	Page 70	Page 35	Newhall	Page 70	Page 35
Newton Of Kinkell	Page 70	Page 35	Newton Of Kinkell	Page 70	Page 35

Major Land Allocations		Written Statement
Alness Point	Page 12	Page 37
Delny	Page 12	Page 37
Evanton (Highland Deephaven)	See A1 Sheet	Page 37
Fendom	Page 12	Page 38
Fearn/Hilton of Cadboll	Page 12	Page 39
Logg Point	Page 13	Page 38

Main Settlements		Written Statement
Achnasheen	Page 14	Page 44
Ardeer	Page 32	Page 45
Ardeer	Page 32	Page 49
Conon Bridge	See A1 Sheet	Page 52
Conon	Page 15	Page 55
Cromarty	Page 16	Page 57
Culbokie	Page 17	Page 60
Dingwall	See A1 Sheet	Page 60
Edderton	Page 18	Page 60
Evanton	See A1 Sheet	Page 60
Fortrose	See A1 Sheet	Page 72
Rosemarkie	See A1 Sheet	Page 76
Tain	Page 20	Page 79
Tain	Page 20	Page 80
Inver	Page 20	Page 82
Inver	Page 20	Page 83
Kildary	Page 21	Page 86
Marybank	Page 21	Page 87
Maryburgh	See A1 Sheet	Page 87
Milton (of Kildary)	Page 22	Page 87
Muir of Ord	See A1 Sheet	Page 92
Munlochy	Page 23	Page 95
North Kessock	See A1 Sheet	Page 97
Portmahomack	Page 24	Page 99
Strathpeffer	Page 24	Page 101
Strathpeffer	See A1 Sheet	Page 103
Tain	See A1 Sheet	Page 107
Tore	Page 26	Page 110

The Plan is divided into the following sections:

Rural Settlements	Pages 1 - 11
Major Land Allocations	Pages 12 - 13
Main Settlements	Pages 14 - 26
Spatial Elements of the Strategy	Page 27

The maps relating to these sections are found in this map booklet.

The following maps are found in folded A1 or A0 size sheets:

Proposals Map	Invergordon
Analysis Map A & B	Maryburgh
Alness	Muir of Ord
Avoch	North Kessock
Conon Bridge	Strathpeffer
Dingwall	Tain
Evanton/Highland Deephaven	
Fortrose	
Rosemarkie	

RETAINED IN PART:

BACKGROUND POLICIES

BP1
The Council will favour development subject to detailed design and servicing factors.

BP2
The Council will permit development unless this would be likely to have a significantly adverse effect on, or be significantly adversely affected by, the features for which the area has been designated. Where it is concluded that any such adverse effects are likely to arise, development will only be permitted where it is considered that these would be outweighed by social or economic benefits.

BP3
The Council will only approve development if there are no significant adverse effects on heritage, amenity, public health and safety interests.

BP4
The Council will not favour development unless there are over-riding environmental or public health and safety grounds, unless there are imperative reasons of overriding public interest including those of a social or economic nature.

Conservation Area (BP2)

SETTLEMENT POLICIES

Settlement Boundary
The Council will maintain a strong presumption against sporadic development outwith settlement boundaries in order to protect their landscape setting or avoid adversely affecting their longer-term expansion.

Town/Village Centre
The Council will encourage town centre uses appropriate to the settlement's role in the hierarchy.

Housing
The Council will safeguard the function and character of established residential areas and will encourage appropriate development.

Business
The Council will maintain or promote business/tourism.

Industry
The Council will maintain or promote industrial uses.

Special Uses
The Council will expect other uses mainly of a community, service or tourist related nature to be maintained or developed where stated.

Expansion
The Council will encourage development in accordance with a comprehensive master plan and will presume against piecemeal proposals.

Amenity
The Council will safeguard these areas from development not associated with their purpose or function.

Action Area/Special Initiative

7 Site/Area Reference

OTHER

Road / Rail

Access

Cycle Route/Footpath

INSET 7 : ACHNASHEEN

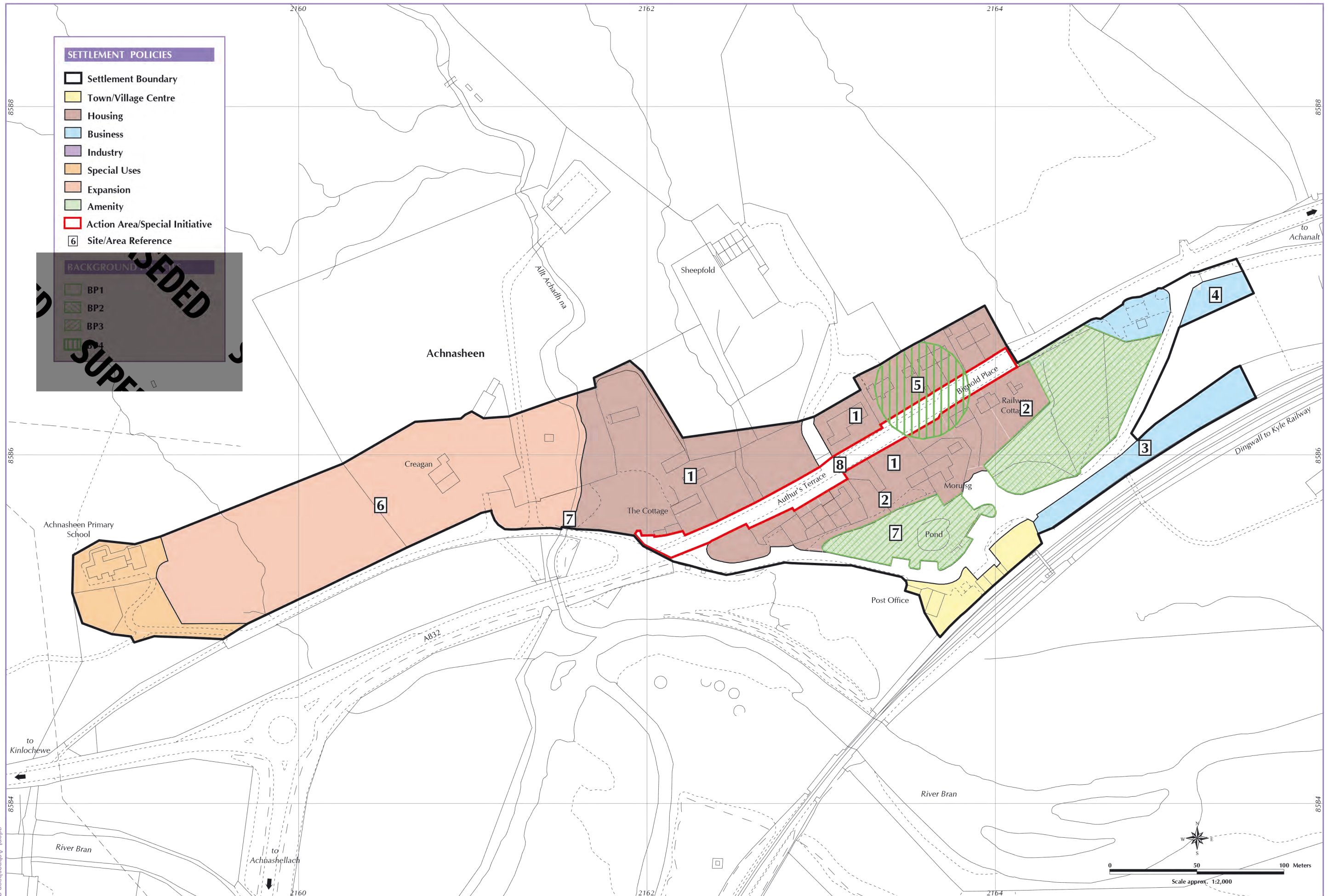

© Crown Copyright. The Highland Council 100023369.
All OS base maps are the most up-to-date available to The Highland Council at the time of the production of this Local Plan

(As Continuing in Force, July 2015)



ROSS & CROMARTY EAST LOCAL PLAN