

Site Forms

YOUR DETAILS	
Your Name (and organisation if applicable)	J P M Fraser
Your Address / Contact Details	C/O Allied Souter and Jaffrey
Landowner's Name (if known / applicable)	J P M Fraser
Agent (if applicable)	C S Webster of Allied Souter and Jaffrey
Agent's Address / Contact Details (if applicable)	Allied Souter and Jaffrey
	209 High Street
	Elgin
	IV30 1DJ Tel: 01343547481 caroline.webster@alliedsurveyorsscotland.co.uk

DETAILS OF SITE SUGGESTED	
Site Address	Site 3 –Site adjacent to Balmacaan Road, Drumdrochit
Site/Local Name (if different from above)	
Site Size (hectares)	3 Acres
Grid Reference (if known)	
Proposed Use (e.g. housing, affordable housing, employment, retail, waste, gypsy traveller, utility, community, retained public open space)	8 proposed low density dwelling house sites, retaining the existing residential settlement pattern of the area.
Proposed Non Housing Floorspace / Number of Housing Units (if	8 dwelling houses proposed

known/applicable)	
Map	(please attach a map of the site ideally on an Ordnance Survey base)

If you wish to suggest a site that should <u>not</u> be built on, fill in this form	
REASONS WHY YOUR SITE SHOULD BE SAFEGUARDED FROM BUILDING	
How do the public enjoy the space - e.g. used for dog walking, children's play?	
What makes the site more special than other areas in the village/town?	
Does the site have attractive or rare features such as mature trees, historical significance or protected wildlife?	

Landowners, developers and/or agents wishing to suggest a site should fill in the following form and as much as possible of the strategic environmental assessment form (at the end of this document) which assesses the environmental affects of possible development sites.

If you wish to suggest a site that should be built on, fill in this form	
REASONS FOR YOUR DEVELOPMENT SITE SUGGESTION	
How can the site be serviced? (give details of proposed access, foul drainage, surface water and water supply arrangements)	Foul water and water supply would by way of a connection to the existing mains. Surface water would be to separate individual surface water soakaways. Access would be by means of one main access point taken off Balmacaan Road, with a minor access road thereafter leading to the individual house sites.

FORM CONTINUES BELOW

REASONS FOR YOUR DEVELOPMENT SITE SUGGESTION

<p>What are the site's constraints and how can they be resolved or reduced? (e.g. does the site flood, are there protected species present, will good farmland be lost, will the local landscape be affected, will valued trees be felled, are any other heritage features likely to be affected?)</p>	<p>There is no agricultural benefit to the land and there are no trees on the site. Footpaths will be introduced to connect the site with the existing path network</p>
<p>What benefits will result to the wider community from the site's development? (e.g. will there be more or better jobs, will the land be put to a more productive use, will the development increase infrastructure capacity for others, will more affordable houses result, is there an unmet demand for the development?)</p>	<p>The proposal will provide essential residential sites for the community, utilising an area of ground within an established residential area, benefiting from all the existing infrastructure which will contribute to and strengthening the local community, reflecting the 2008 'Drumadrochit Futures' Planning Brief. In addition to this the formal establishment of footpaths and cycle ways, linking in with the local core path network, will further strengthen the amenity of the area. The formation of streets within the site, incorporating the principles of 'Designing Streets' will add to the established community and provide good quality safe spaces to live in.</p>
<p>What impact will there be on travel patterns from the site's development? (e.g. will more or less people engage in active and healthy travel (walk / cycle) or go by public transport as a result of the site's development rather than travel by private car?)</p>	<p>The proposal will have no impact on the existing travel patterns as it is centrally located within an established community.</p>
<p>Is the site well connected? (e.g. will the average travel time to community and commercial facilities reduce or increase as a result of the site's development, is the proposed use compatible with existing / proposed surrounding uses?)</p>	<p>The site is within an established residential area and the proposed use is compatible with the existing surrounding uses.</p>
<p>Is the site energy efficient? (e.g. will the site allow for energy efficient siting, layout, building design and local renewable energy source connection?)</p>	<p>The dwellings would maximise the available solar gain by positioning and construction materials. The proposed construction should also maximise the energy efficiency in terms of heat loss etc.</p>
<p>What other negative impacts will the development have and how will they be resolved or offset? (e.g. will the site's development increase any form of pollution or decrease public safety?)</p>	<p>The proposal does not have any negative impacts. The sites will be low density with screening and planting introduced to minimise any visual impact.</p>

STRATEGIC ENVIRONMENTAL ASSESSMENT FORM

Landowners, developers and/or agents wishing to suggest a site should fill in as much as possible of the following form. Strategic environmental assessment of local development plan sites is now a statutory requirement and considers the possible environmental effects of development proposals. We will check your answers and fill in any gaps.

No.	Issue	Detailed Explanation	Answer	Any Proposed Mitigation Measures (how will you reduce or offset the effects of your development?)
1	<p>a) Will the site safeguard any existing open space within the area?</p> <p>b) Will the site enable high quality open space to be provided within the area?</p>	<p>Will the site have any impact on useable public open space (such as parks, playing fields etc) or any opportunities to create additional public open space?</p>	<p>a)&b)The site is within an established residential area. The impact on the area would be minimal due to the low density housing proposed. Any development would include planting and screening where necessary which will enhance the local amenity.</p>	<p>Sensitive positioning of sites would minimise the impact and maximise the amenity value. The introduction of a footpath, with screening and planted backdrop, will also contribute to safeguarding the existing amenity with the preservation of all boundary stone dykes.</p>
2	<p>Will the site encourage and enable provision for active travel (walking, cycling and public transport use)?</p>	<p>Is any part of the site within 400m straight line distance of any community/commercial building? or will development provide a community/commercial building within walking distance of existing residential areas? - Are there opportunities to create new walking/cycling routes or improve existing routes?</p>	<p>The site is within the community of Drumnadrochit and within walking distance of the other residential areas and commercial buildings.</p>	
3	<p>Does the site provide an opportunity for you to provide a financial contribution towards encouraging more sustainable travel patterns?</p>	<p>For example, can a subsidy to a local bus route be provided?</p>	<p>The site will be encouraging and introducing a sustainable travel pattern through the introduction of paths and pavements to connect the development with the existing residential areas and commercial premises.</p>	
4	<p>Will the site involve “off site” road improvements that will contribute to road safety?</p>	<p>Is the site likely to improve the local road network such as junctions or crossings?</p>	<p>The proposal will include the introduction of traffic management measures and speed control.</p>	

5	Is there scope for road safety measures as part of the development of the site?	Will development incorporate on-site traffic calming measures (e.g. speed bumps) or street lighting? Will it incorporate the principles of Designing Streets available via: http://www.scotland.gov.uk/Publications/2010/03/22120652/0	The site is accessed from an established residential Road. The formation of streets within the site, incorporating the principles of 'Designing Streets' will add to the established community and provide good quality safe spaces to live in.	
6	Is the site near any existing "bad neighbour" uses?	Will the site be negatively affected by any neighbouring use? (bad neighbour uses include those that affect residential property by way of fumes, vibration, noise, artificial lighting etc). Is the site affected by any of the Physical Constraints identified in the Council's Physical Constraints: Supplementary Guidance?	None known	
7	Are there any contaminated land issues affecting the site?	Are you aware if the site has been previously used for industrial or any other uses likely to cause contamination?	None Known	
8	a) Is the site on derelict, vacant or other land that has previously been used? b) Is the site on greenfield land?	a) Has the site been identified in Scottish Government's Vacant and Derelict Land Survey (which can be found here: http://scotland.gov.uk/Publications/2010/01/26135819/0) or has the land got an existing use? b) Will the site be located on presently undeveloped land e.g. presently or capably used for agriculture, forestry or amenity purposes?	a) None Known b) The site is a piece of disused ground with no agricultural benefit	b) The development would be restricted to 8 low density sites, sensitively positioned, reflecting the existing neighbouring settlement pattern. Stone dyke boundaries will be retained, with the introduction of one access point.
9	Is the site within the current settlement boundary?	Is the site within any identified settlement boundary in the Local Plan? Is it allocated for any uses?	The site is located within the settlement boundary of Drumnadrochit.	
10	Will the site affect the distinctiveness and special qualities of the present landscape character or affect any landscape designation?	Does the site conform with the Landscape Capacity Assessment (if available)? Will the site result in the removal of valued landscape features or negatively affect any key views? Is it located within or would otherwise affect a National Scenic Area or Special Landscape	Minimal	The development would be restricted to 8 low density sites, sensitively positioned, reflecting the existing neighbouring settlement pattern. Stone dyke boundaries will be retained with the introduction of

		Area, having regard to their special qualities?		one access point. Key views will also be retained.
11	Will the site affect any areas with qualities of wildness? (that is land in its original natural state?)	Are you aware if the site is inside or likely to affect an area of Wild Land? (These areas are identified on Map 3 of SNH's Policy Statement, Wildness in Scotland's Countryside) and areas of Remote Coast identified by the Council, or an area of wildness identified in the draft Wild Land Supplementary Guidance?	No.	
12	Will the site affect a conservation area?	Is the site inside or likely to affect the character of a confirmed Conservation Area?	No.	
13	Will the site impact on any listed building and/or its setting?	Is there a listed building or a part of the setting "area" of a listed building within the site?	No.	
14	Will the site affect a site identified in the Inventory of Gardens and Designed Landscapes?	Is any part of the site inside the outer boundary of an Inventory "entry" or will the site affect the setting of an "entry"?	No.	
15	Will the site affect any locally important archaeological sites identified in the Historic Environment Record?	Does the site contain any features identified in the HER? If yes, will the site affect the feature?	No.	
16	Will the site impact on any Scheduled (Ancient) Monument and/or its setting?	Is there any SAM within the site boundary or will a SAM be affected?	No.	
17	a) Will the site affect any natural heritage designation or area identified for its importance to nature conservation? b) Will the site affect any	a) Is any part of the site inside or likely to affect the designation (SAC, SPA, SSSI, NNR, Ramsar) or Local Nature Conservation Site? b) Is any part of the site within or likely to	a) No. b) No.	

	other important habitat for the natural heritage?	affect non-statutory features identified as being of nature conservation importance e.g. Ancient, Semi-Natural or Long-Established Woodland Inventory sites, priority BAP habitats, habitats included on the Scottish Biodiversity List, non-designated habitats listed in Annex 1 of EC Habitats Directive?		
18	a) Will the site affect any protected species? b) Will the site affect any other important species for the natural heritage?	a) Will the site affect any European Protected Species, Badgers and species (birds, animals and plants) protected under the Wildlife and Countryside Act 1981 as amended. If such a species may be present on or near the site, a survey should be carried out to inform this assessment (for which a licence from SNH may be required) b) Will the site affect species listed in the UK and Local BAPs, the Scottish Biodiversity List and relevant annexes of the EC Habitats Directive?	a) We do not believe so but will ensure any guidelines are strictly adhered to. b) We do not believe so but will ensure any guidelines are strictly adhered to.	
19	Is the site proposed to provide any form of renewable energy?	For example, will the site provide or be capable of providing a district heating system, solar panels or a wind turbine?	The dwellings will have some form of renewable energy designed into them, such as solar panels.	
20	Is any part of the site at risk from fluvial or coastal flooding as shown on SEPA's flood map or from local knowledge?	Are you aware of any part of the site being within the 1 in 200 year flood risk contour as identified by SEPA? (which can be found here: http://www.sepa.org.uk/flooding/flood_risk_maps/view_the_map.aspx)	No.	
21	Will development of the site result in the need for changes in land form and level? If yes, how will soil and drainage issues be addressed?	Will there be any change in rate, quantity, quality of run-off plus groundwater impact on or off site? If so, will these affect priority habitats, especially blanket bog?	There will be no need to change the land form or level.	
22	Is there a watercourse, loch or sea within or	Will there be any culverting, diversion or channelling of existing watercourses?	No.	

	adjacent to the site? If yes, how will the water environment be protected from development?			
23	Will the site offer opportunities for sustainable waste management?	Will the waste produced by the site be minimised and processed close to source in a sustainable way?	Yes - Rainwater harvesting could be introduced into the proposals.	
24	Can the site be connected to the public water and sewerage system?	Can the site be connected at reasonable cost? If not, what alternative is proposed?	Yes it is proposed that the sites will be connected to the existing mains systems	
25	Will the site require alteration to the local landform?	Can the site (including access) be developed without significant re-contouring etc.? Will access tracks and parking areas have significant cut and fill?	No re-contouring will be required.	
26	Will the site affect or be affected by coastal erosion or natural coastal processes?	This will be noted on any relevant shoreline management plan.	No.	
27	Is the site sheltered from the prevailing wind and does it have a principal aspect between SW and SE?	Will development make best use of the site in terms of energy efficiency?	The site is sheltered and can be designed to maximise the SW & SE aspects	
28	Will the site have any impact upon local air quality?	Is the site near areas of employment or close to public transport? Such developments are less likely to result in additional traffic which may contribute to air pollution.	No.	
29	Will the site have an impact on light pollution levels?	Is it likely that the Council policy likely will require street lighting at this location? Are there proposals for floodlighting on the site?	No – the site is within a residential area.	
30	a) Will it the site affect the present green network of the area?	a) Will the site affect features that currently provide for the movement of species and/or people e.g. woodland, hedgerows, field margins, watercourses, coastlines, tree belts,	a) There will be a minor affect.	a) The development would be restricted to 8 low density sites, sensitively positioned, reflecting the existing neighbouring settlement

	b) Will the site provide opportunities to enhance the present green network of the area?	greenspace? b) Will connectivity of natural features or open space and paths used for public amenity be improved? Will existing fragmentation of habitats and open spaces be improved? Will species be enabled to move where at present there is an obstacle?	b) The green network should be retained	pattern. Stone dyke boundaries will be retained. b) The low density will retain any green network of the area with the introduction of screening and planting.
31	Will the site provide opportunities for people to come into contact with and appreciate nature/natural environments?	Is the site close to (within 1.5km) an opportunity to come into contact with nature/natural environments e.g. Local Nature Reserves, local greenspace, green networks? Are there proposals which will increase opportunities to come into contact with nature/natural environments?	Yes - The site will be encouraging and introducing a sustainable travel pattern through the introduction of footpaths providing an opportunity to people to come into contact with and appreciate nature.	
32	a) Will the site affect any core paths or right of way? b) Will the site affect any other existing paths or outdoor access opportunities? c) Will the allocation provide new access opportunities within the site and linking to the path network beyond the site?	a) Is a diversion of a core path or right of way required? Will there be any impact on the usability of a core path or right of way? b) Will it affect an existing path in the Highland Path Record? Will it provide additional access opportunities or adversely affect access opportunities afforded by the Land Reform (Scotland) Act 2003? c) Will new paths be created within and beyond the site? Will any existing paths be improved e.g. to increase accessibility to a wider range of users? Will the site help to realise priorities identified in the Council's outdoor access strategy or aspirational paths identified in the core path plans?	a) No b) No. c) Yes - The proposal would include the formation of footpaths, with an emphasis on the local core path network.	
33	Will the site have an impact on the geodiversity of the area?	Are you aware if the site lies within or adjacent to an un-notified Geological Conservation Review site or Local Geodiversity Site? (or other site with geodiversity value e.g. distinctive landforms,	We do not believe so.	

		areas with natural processes, rock exposures for study?)		
34	Will soil quality and capability of the site be adversely affected?	Will the site result in a loss of soil due to development or removal of good quality soil from the site? Is the site on land identified as Prime Quality Agricultural Land?	No.	
35	Is the site on peatland?	Is the site within or functionally connected to an area of peatland? Would the allocation involve the disturbance of peat? If yes, how would impacts on peatland be avoided or minimised? Would any tree felling be required?	No.	
36	Will the site have any affect on the viability of a crofting unit?	Does the site represent a significant loss of good quality inbye crofting land or common grazing land?	No.	

Inner Moray Firth Local Development Plan

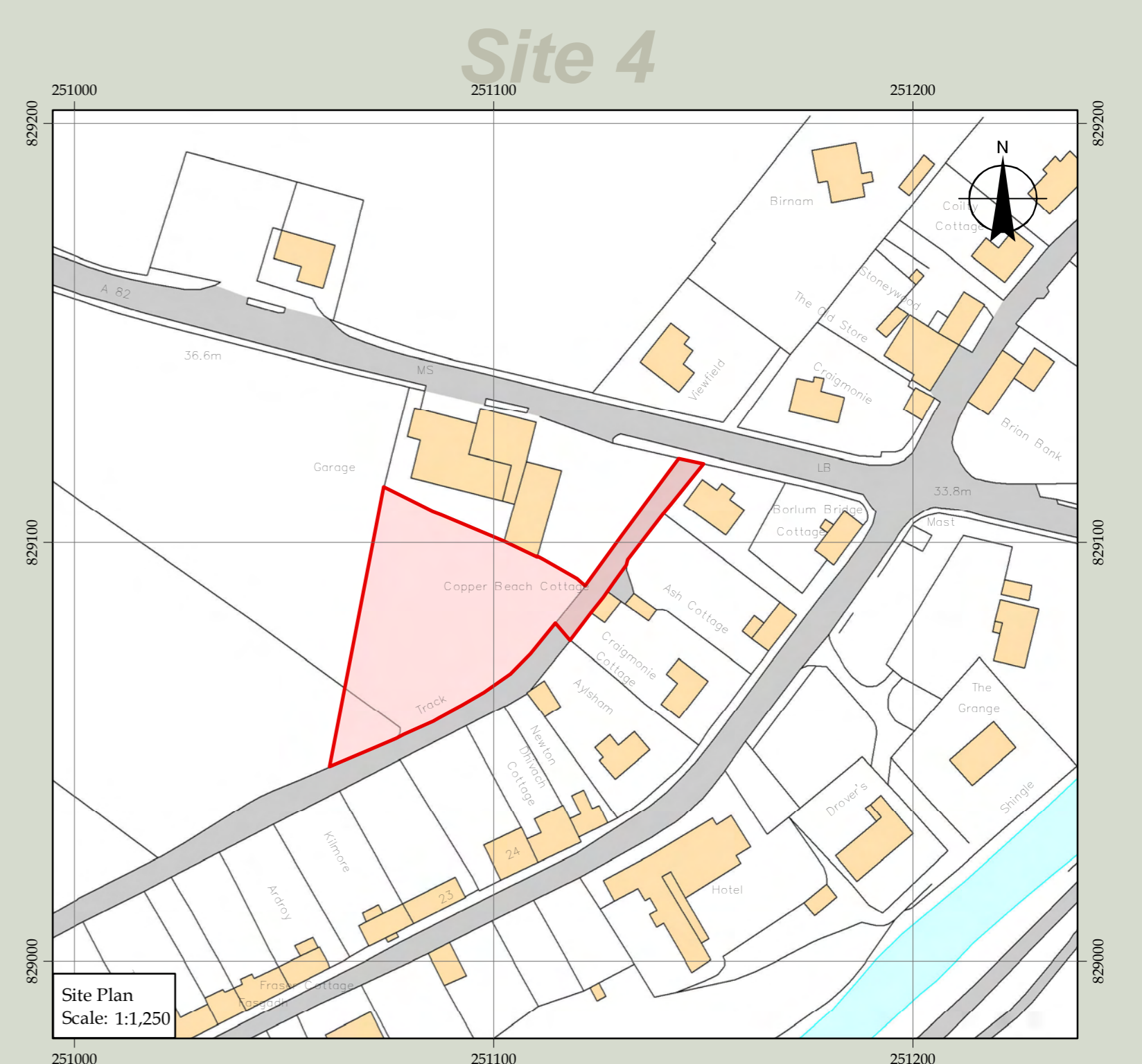
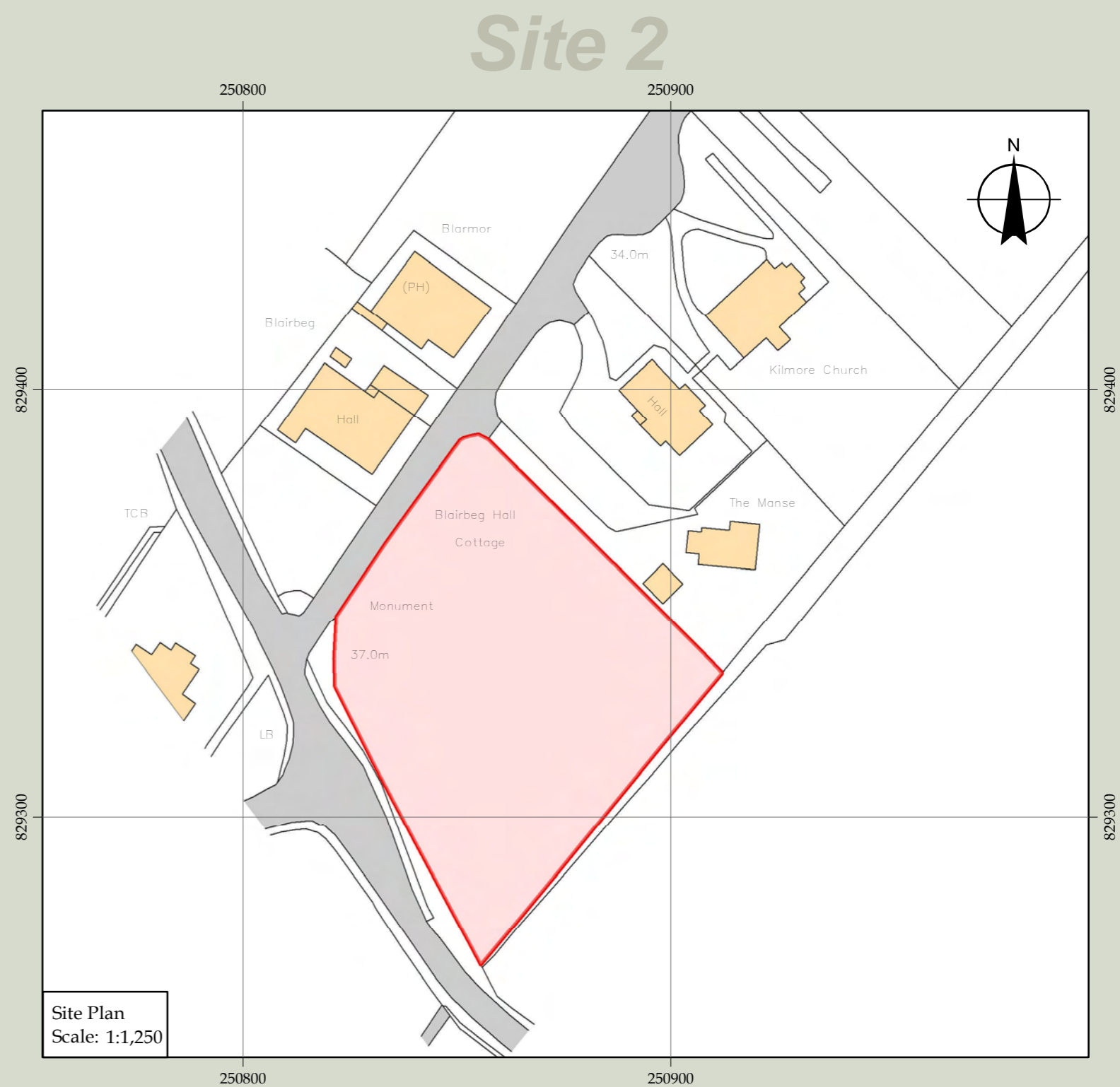
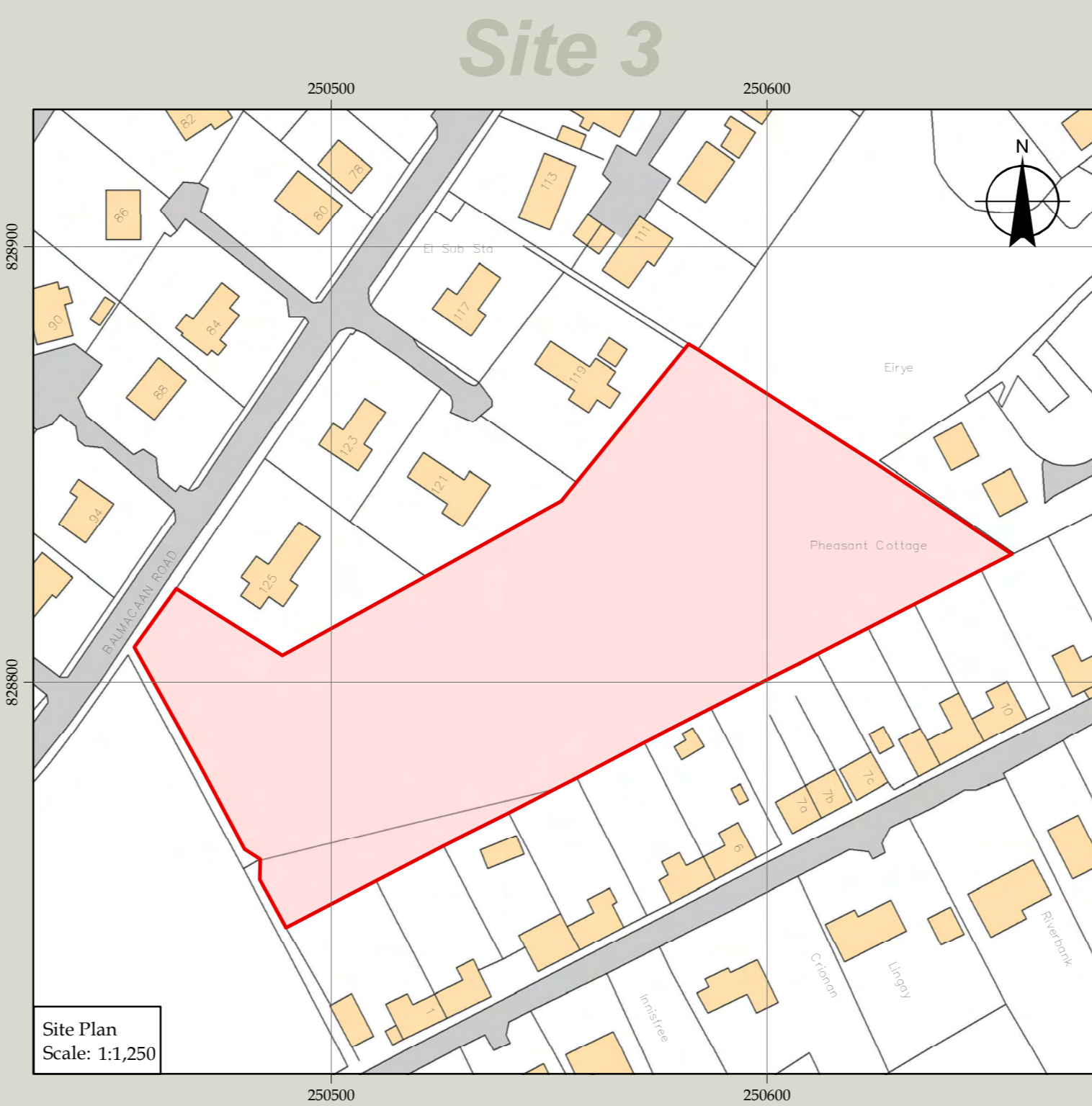
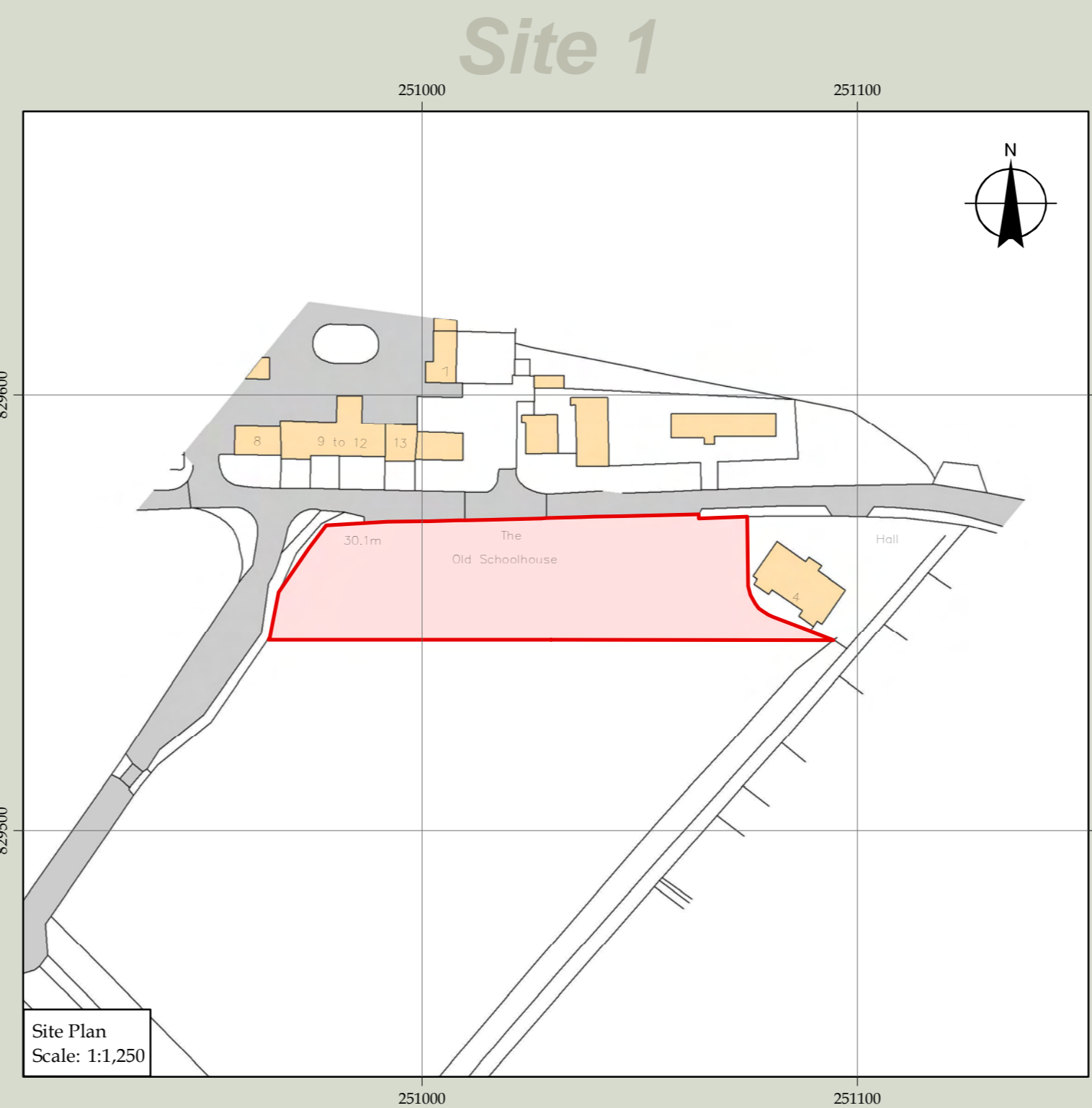
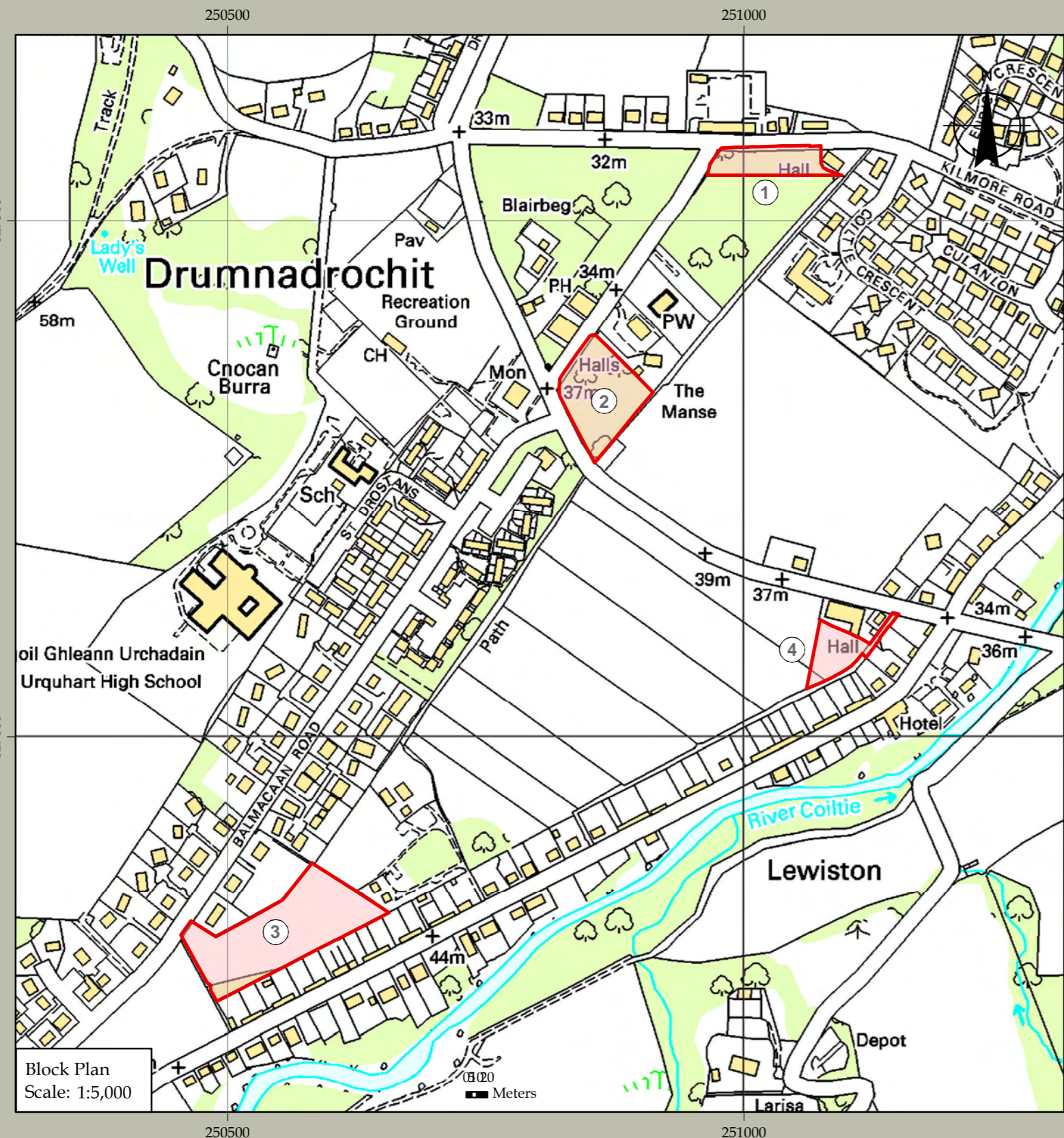

JPM Fraser
Zoning of Land in Drumnadrochit
Inner Moray Firth Local Development Plan

Drawn by: CEC	Date: 20/01/2011	Scale: as noted
Checked by: CSW	Ref: 2514 - GIS - 01	Rev: A

Plan prepared by **BOWLERS**

This plan is based upon the Ordnance Survey map with the sanction of the Controller of H.M. Stationery Office. © Crown Copyright. OS Licence Number 100017943
This plan is published for convenience only. Although it is thought to be correct its accuracy cannot be guaranteed. Do not scale from this plan.