

Site Forms

YOUR DETAILS	
Your Name (and organisation if applicable)	I Mackay Esq
Your Address / Contact Details	Leanach Farm
	Culloden Moor
	Inverness IV1 2EH
Landowner's Name (if known / applicable)	As above
Agent (if applicable)	Colin Armstrong Associates
Agent's Address / Contact Details (if applicable)	Lyle House Pavilion 1
	Fairways Business Park
	Inverness
	IV2 6AA

DETAILS OF SITE SUGGESTED	
Site Address	Leanach Farm Culloden Moor
Site/Local Name (if different from above)	Area of land fronting the Leanach Cross roads junction and adjacent to No 1 Leanach Cottages to the west towards Nairnside.
Site Size (hectares)	0.345Ha
Grid Reference (if known)	E275045/N844982
Proposed Use (e.g. housing, affordable housing, employment, retail, waste, gypsy traveller, utility, community, retained public open space)	Private residential
Proposed Non Housing Floorspace / Number of Housing Units (if known/applicable)	3 no detached dwelling houses
Map	Drawing no 0972/003 attached.

If you wish to suggest a site that should <u>not</u> be built on, fill in this form	
REASONS WHY YOUR SITE SHOULD BE SAFEGUARDED FROM BUILDING	
How do the public enjoy the space - e.g. used for dog walking, children's play?	
What makes the site more special than other areas in the village/town?	
Does the site have attractive or rare features such as mature trees, historical significance or protected wildlife?	

Landowners, developers and/or agents wishing to suggest a site should fill in the following form and as much as possible of the strategic environmental assessment form (at the end of this document) which assesses the environmental effects of possible development sites.

If you wish to suggest a site that should be built on, fill in this form	
REASONS FOR YOUR DEVELOPMENT SITE SUGGESTION	
How can the site be serviced? (give details of proposed access, foul drainage, surface water and water supply arrangements)	Access directly from public road from Leanach Crossroads junction to Nairnside. Mains water supply available with foul drainage by septic tank and small treatment plant with surface water via attenuation taken to communal surface water pond/reservoir to south on Leanach Farm land.

FORM CONTINUES BELOW

REASONS FOR YOUR DEVELOPMENT SITE SUGGESTION

<p>What are the site's constraints and how can they be resolved or reduced? (e.g. does the site flood, are there protected species present, will good farmland be lost, will the local landscape be affected, will valued trees be felled, are any other heritage features likely to be affected?)</p>	<p>Site does not flood, no trees will be affected since there are none on site and no other visible heritage features deemed to be affected. 0.3 ha of land will be lost to a farm comprising an overall agricultural area of 140 Ha and given that the proposed development will be next to the existing settlement area around the Leanach Cross roads there will be little discernable difference to the local landscape.</p>
<p>What benefits will result to the wider community from the site's development? (e.g. will there be more or better jobs, will the land be put to a more productive use, will the development increase infrastructure capacity for others, will more affordable houses result, is there an unmet demand for the development?)</p>	<p>Land will be more productive if only to generate more Council Tax revenue. Affordable housing would not be an option given the small number of units proposed but the land owned would allow a greater density if affordable housing was deemed appropriate for this area. As in other similar possible site areas around Inverness there was and will be after the economic recovery likely to be a demand for housing in this settlement area and indeed the Highland Council identified part of the area now proposed for development as being within the Leanach settlement boundary area in 2001.</p>
<p>What impact will there be on travel patterns from the site's development? (e.g. will more or less people engage in active and healthy travel (walk / cycle) or go by public transport as a result of the site's development rather than travel by private car?)</p>	<p>No change to existing travel patterns expected.</p>
<p>Is the site well connected? (e.g. will the average travel time to community and commercial facilities reduce or increase as a result of the site's development, is the proposed use compatible with existing / proposed surrounding uses?)</p>	<p>Deemed to be close in commuter terms to Inverness and proposed use is similar to existing settlement developments in immediate area.</p>
<p>Is the site energy efficient? (e.g. will the site allow for energy efficient siting, layout, building design and local renewable energy source connection?)</p>	<p>Individual plot areas have a main aspect to the south east/south west and as such should be able to allow the adoption of energy efficient layouts and associated design to take advantage of energy renewable sources.</p>
<p>What other negative impacts will the development have and how will they be resolved or offset? (e.g. will the site's development increase any form of pollution or decrease public safety?)</p>	<p>No known negative impacts likely to result from proposed development.</p>

STRATEGIC ENVIRONMENTAL ASSESSMENT FORM

Landowners, developers and/or agents wishing to suggest a site should fill in as much as possible of the following form. Strategic environmental assessment of local development plan sites is now a statutory requirement and considers the possible environmental effects of development proposals. We will check your answers and fill in any gaps.

No	Issue	Detailed Explanation	Answer	Any Proposed Mitigation Measures (how will you reduce or offset the effects of your development?)
1	<p>a) Will the site safeguard any existing open space within the area?</p> <p>b) Will the site enable high quality open space to be provided within the area?</p>	<p>Will the site have any impact on useable public open space (such as parks, playing fields etc) or any opportunities to create additional public open space?</p>	<p>Given the overall land area owned, the far greater part would still be open agricultural space as at present, but not public open space as such.</p> <p>As mentioned above the area proposed is surrounded by open agricultural space.</p>	
2	<p>Will the site encourage and enable provision for active travel (walking, cycling and public transport use)?</p>	<p>Is any part of the site within 400m straight line distance of any community/commercial building? or will development provide a community/commercial building within walking distance of existing residential areas?</p> <p>- Are there opportunities to create new walking/cycling routes or improve existing routes?</p>	<p>Within 400 metres of a restaurant/pub and walking and cycling possible with a regular public bus route within the same distance.</p>	
3	<p>Does the site provide an opportunity for you to provide a financial contribution towards encouraging more sustainable travel patterns?</p>	<p>For example, can a subsidy to a local bus route be provided?</p>	<p>Very doubtful given the small number of units proposed.</p>	
4	<p>Will the site involve "off site" road improvements that will</p>	<p>Is the site likely to improve the local road network such as junctions or crossings?</p>	<p>No.</p>	

	contribute to road safety?			
5	Is there scope for road safety measures as part of the development of the site?	Will development incorporate on-site traffic calming measures (e.g. speed bumps) or street lighting? Will it incorporate the principles of Designing Streets available via: http://www.scotland.gov.uk/Publications/2010/03/22120652/0	No.	
6	Is the site near any existing "bad neighbour" uses?	Will the site be negatively affected by any neighbouring use? (bad neighbour uses include those that affect residential property by way of fumes, vibration, noise, artificial lighting etc). Is the site affected by any of the Physical Constraints identified in the Council's Physical Constraints: Supplementary Guidance?	No.	
7	Are there any contaminated land issues affecting the site?	Are you aware if the site has been previously used for industrial or any other uses likely to cause contamination?	No.	
8	a) Is the site on derelict, vacant or other land that has previously been used? b) Is the site on greenfield land?	a) Has the site been identified in Scottish Government's Vacant and Derelict Land Survey (which can be found here: http://scotland.gov.uk/Publications/2010/01/26135819/0)or has the land got an existing use? b) Will the site be located on presently undeveloped land e.g. presently or capably used for agriculture, forestry or amenity purposes?	No. Yes, as it is currently agricultural land albeit partly within the Highland Council Leanach Local Plan settlement area.	
9	Is the site within the current settlement boundary?	Is the site within any identified settlement boundary in the Local Plan? Is it allocated for any uses?	Partly as mentioned above.	
10	Will the site affect the distinctiveness and special qualities of the	Does the site conform with the Landscape Capacity Assessment (if available)? Will the site result in the	Deemed to have no effect on surrounding landscape.	

	present landscape character or affect any landscape designation?	removal of valued landscape features or negatively affect any key views? Is it located within or would otherwise affect a National Scenic Area or Special Landscape Area, having regard to their special qualities?		
11	Will the site affect any areas with qualities of wildness? (that is land in its original natural state?)	Are you aware if the site is inside or likely to affect an area of Wild Land? (These areas are identified on Map 3 of SNH's Policy Statement, Wildness in Scotland's Countryside) and areas of Remote Coast identified by the Council, or an area of wildness identified in the draft Wild Land Supplementary Guidance?	No.	
12	Will the site affect a conservation area?	Is the site inside or likely to affect the character of a confirmed Conservation Area?	Believed to on the periphery of the Culloden Moor Conservation Area.	
13	Will the site impact on any listed building and/or its setting?	Is there a listed building or a part of the setting "area" of a listed building within the site?	No.	
14	Will the site affect a site identified in the Inventory of Gardens and Designed Landscapes?	Is any part of the site inside the outer boundary of an Inventory "entry" or will the site affect the setting of an "entry"?	No.	
15	Will the site affect any locally important archaeological sites identified in the Historic Environment Record?	Does the site contain any features identified in the HER? If yes, will the site affect the feature?	No.	
16	Will the site impact on any Scheduled (Ancient) Monument and/or its setting?	Is there any SAM within the site boundary or will a SAM be affected?	No.	
17	a) Will the site affect any natural heritage designation or area identified for its	a) Is any part of the site inside or likely to affect the designation (SAC, SPA, SSSI, NNR, Ramsar) or Local Nature Conservation Site?	No.	

	importance to nature conservation? b) Will the site affect any other important habitat for the natural heritage?	b) Is any part of the site within or likely to affect non-statutory features identified as being of nature conservation importance e.g. Ancient, Semi-Natural or Long-Established Woodland Inventory sites, priority BAP habitats, habitats included on the Scottish Biodiversity List, non-designated habitats listed in Annex 1 of EC Habitats Directive?	No.	
18	a) Will the site affect any protected species? b) Will the site affect any other important species for the natural heritage?	a) Will the site affect any European Protected Species, Badgers and species (birds, animals and plants) protected under the Wildlife and Countryside Act 1981 as amended. If such a species may be present on or near the site, a survey should be carried out to inform this assessment (for which a licence from SNH may be required) b) Will the site affect species listed in the UK and Local BAPs, the Scottish Biodiversity List and relevant annexes of the EC Habitats Directive?	No. No.	
19	Is the site proposed to provide any form of renewable energy?	For example, will the site provide or be capable of providing a district heating system, solar panels or a wind turbine?	Solar panels only anticipated.	
20	Is any part of the site at risk from fluvial or coastal flooding as shown on SEPA's flood map or from local knowledge?	Are you aware of any part of the site being within the 1 in 200 year flood risk contour as identified by SEPA? (which can be found here: http://www.sepa.org.uk/flooding/flood_risk_maps/view_the_map.aspx)	No.	
21	Will development of the site result in the need for changes in	Will there be any change in rate, quantity, quality of run-off plus groundwater impact on or off site? If so, will these affect	No.	

	land form and level? If yes, how will soil and drainage issues be addressed?	priority habitats, especially blanket bog?		
22	Is there a watercourse, loch or sea within or adjacent to the site? If yes, how will the water environment be protected from development?	Will there be any culverting, diversion or channelling of existing watercourses?	No.	
23	Will the site offer opportunities for sustainable waste management?	Will the waste produced by the site be minimised and processed close to source in a sustainable way?	Anticipated Council waste removal arrangements.	
24	Can the site be connected to the public water and sewerage system?	Can the site be connected at reasonable cost? If not, what alternative is proposed?	Mains water available at normal charges but drainage by septic tank/treatment plant as noted above.	
25	Will the site require alteration to the local landform?	Can the site (including access) be developed without significant re-contouring etc.? Will access tracks and parking areas have significant cut and fill?	No.	
26	Will the site affect or be affected by coastal erosion or natural coastal processes?	This will be noted on any relevant shoreline management plan.	No	
27	Is the site sheltered from the prevailing wind and does it have a principal aspect between SW and SE?	Will development make best use of the site in terms of energy efficiency?	Principal aspect and open from southeast to southwest and plots are of a size that would allow use of the natural elements for energy efficiency.	
28	Will the site have any impact upon local air quality?	Is the site near areas of employment or close to public transport? Such developments are less likely to result in additional traffic which may contribute to air pollution.	No.	
29	Will the site have an impact on light	Is it likely that the Council policy likely will require street lighting at this location? Are	No.	

	pollution levels?	there proposals for floodlighting on the site?		
30	<p>a) Will it the site affect the present green network of the area?</p> <p>b) Will the site provide opportunities to enhance the present green network of the area?</p>	<p>a) Will the site affect features that currently provide for the movement of species and/or people e.g. woodland, hedgerows, field margins, watercourses, coastlines, tree belts, greenspace?</p> <p>b) Will connectively of natural features or open space and paths used for public amenity be improved? Will existing fragmentation of habitats and open spaces be improved? Will species be enabled to move where at present there is an obstacle?</p>	<p>No.</p> <p>No.</p>	
31	Will the site provide opportunities for people to come into contact with and appreciate nature/natural environments?	Is the site close to (within 1.5km) an opportunity to come into contact with nature/natural environments e.g. Local Nature Reserves, local greenspace, green networks? Are there proposals which will increase opportunities to come into contact with nature/natural environments?	Site is close to Culloden Battlefield and the associated facilities there as well as a number of immediately accessible woodland/moor walkways.	
32	<p>a) Will the site affect any core paths or right of way?</p> <p>b) Will the site affect any other existing paths or outdoor access opportunities?</p> <p>c) Will the allocation provide new access opportunities within the site and linking to the path network beyond the site?</p>	<p>a) Is a diversion of a core path or right of way required? Will there be any impact on the usability of a core path or right of way?</p> <p>b) Will it affect an existing path in the Highland Path Record? Will it provide additional access opportunities or adversely affect access opportunities afforded by the Land Reform (Scotland) Act 2003?</p> <p>c) Will new paths be created within and beyond the site? Will any existing paths be improved e.g. to increase accessibility to a wider range of users? Will the site</p>	<p>No.</p> <p>No.</p> <p>No.</p>	

		help to realise priorities identified in the Council's outdoor access strategy or aspirational paths identified in the core path plans?		
33	Will the site have an impact on the geodiversity of the area?	Are you aware if the site lies within or adjacent to an un-notified Geological Conservation Review site or Local Geodiversity Site? (or other site with geodiversity value e.g. distinctive landforms, areas with natural processes, rock exposures for study?)	No.	
34	Will soil quality and capability of the site be adversely affected?	Will the site result in a loss of soil due to development or removal of good quality soil from the site? Is the site on land identified as Prime Quality Agricultural Land?	No. Land is normally grassed for sheep and or cattle but not deemed prime quality land.	
35	Is the site on peatland?	Is the site within or functionally connected to an area of peatland? Would the allocation involve the disturbance of peat? If yes, how would impacts on peatland be avoided or minimised? Would any tree felling be required?	No.	
36	Will the site have any affect on the viability of a crofting unit?	Does the site represent a significant loss of good quality inbye crofting land or common grazing land?	No.	

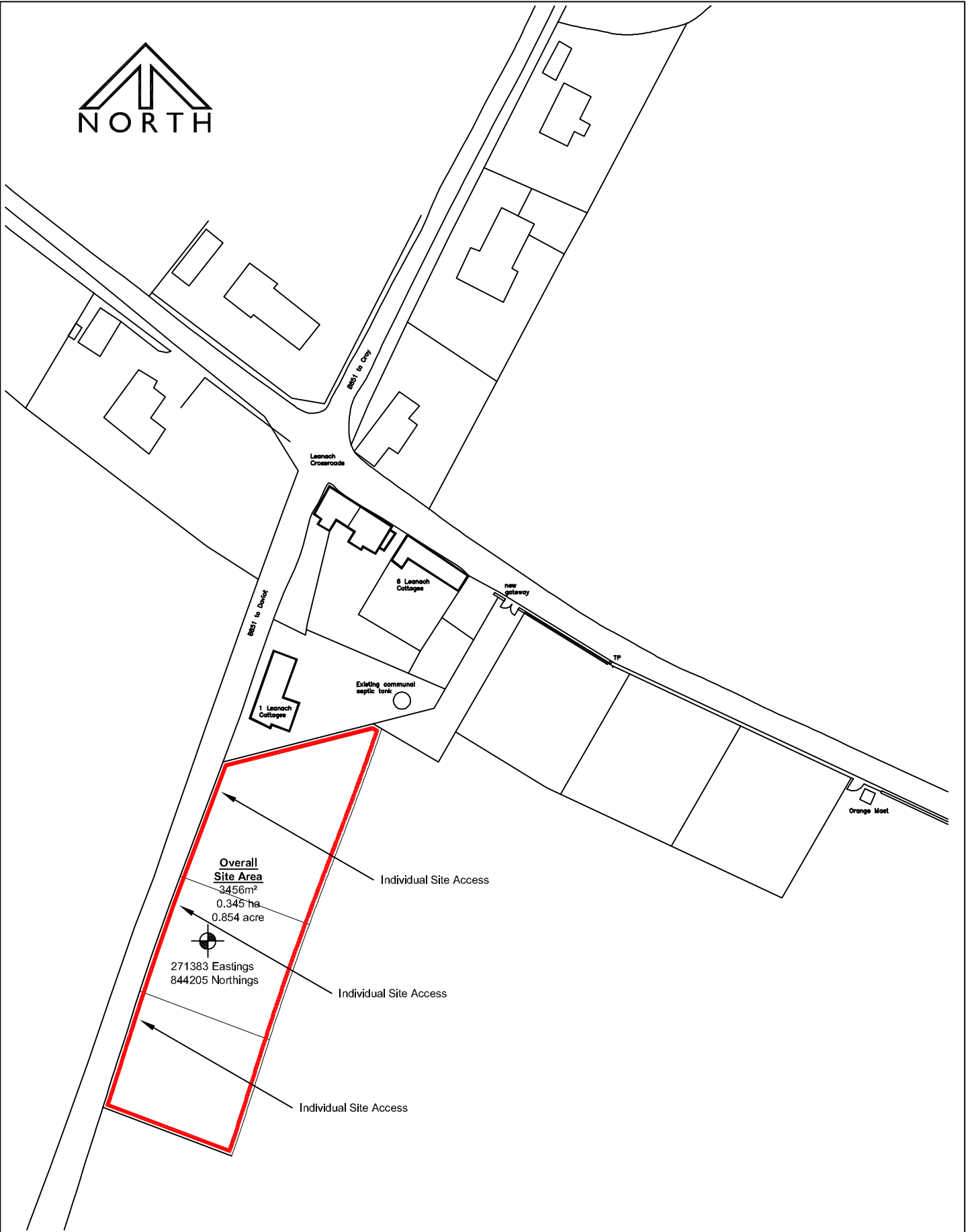

Overall Site Area
3456m²
0.345 ha
0.854 acre

271383 Eastings
844205 Northings

Individual Site Access

Individual Site Access

Individual Site Access

Scale 1:1250 @ A4

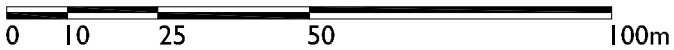

Areas & Dimensions 'or thereby'

Job Reference: 0972

Drawing Number: 0972 - 003

Address: Proposed Site at

Leinach Farm, Inverness

Scale: 1:1250 @ A4

Date: 21st April 2011