

Phase 1

1: 1250

PHASE 1: Establish temporary playground, undertake demolition survey to janitors house and community building, re-furbish janitor house and community building for use as temporary site office / welfare, divert existing drainage from proposed building footprint and make new connection to combined sewer on Ackergill Street
 KEY DATES:
 February 2014 to April 2014

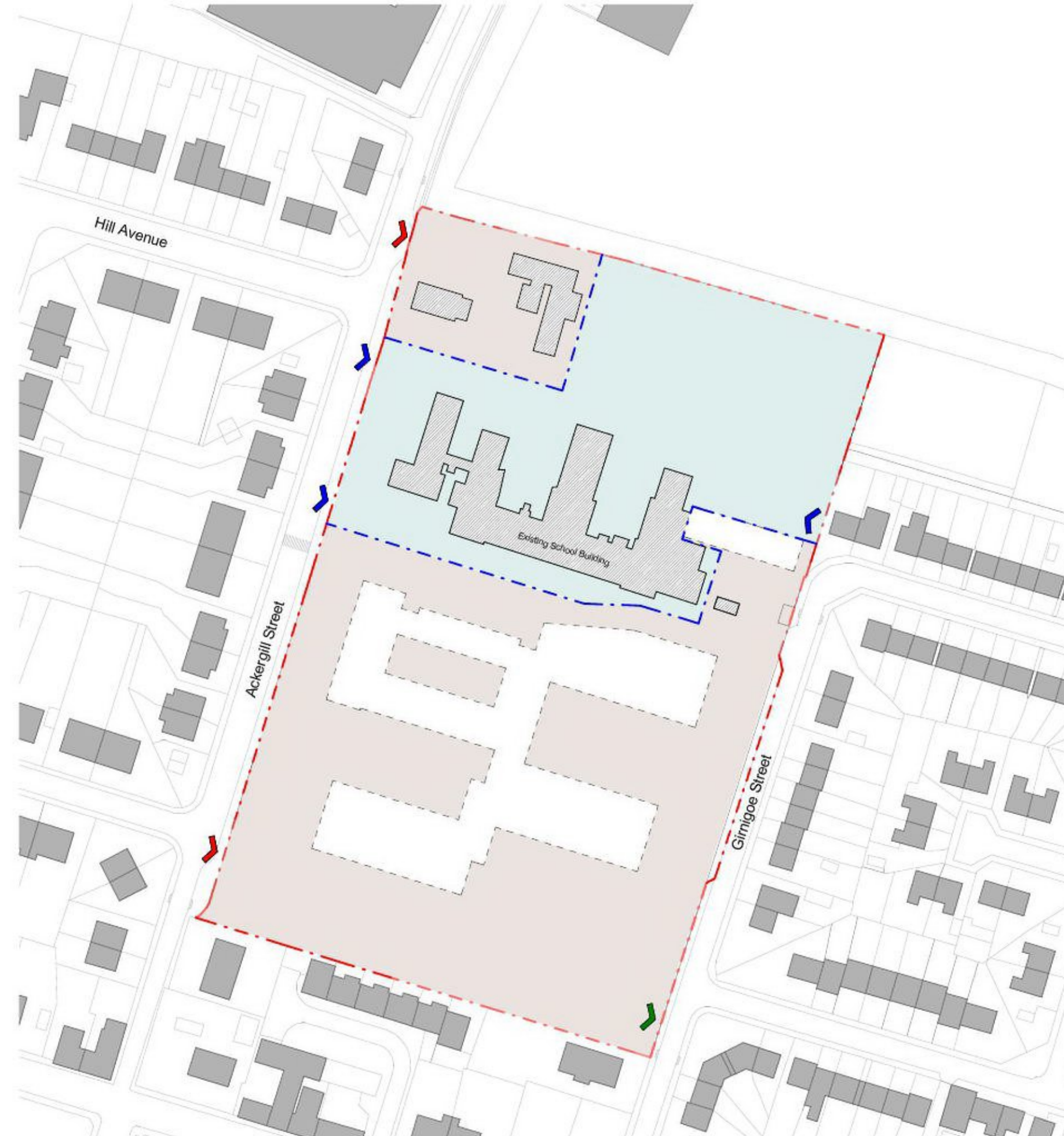

Phase 2

1: 1250

PHASE 2: Construction of new build primary school, energy centre and landscaping
 KEY DATES:
 May 2014 to July 2015

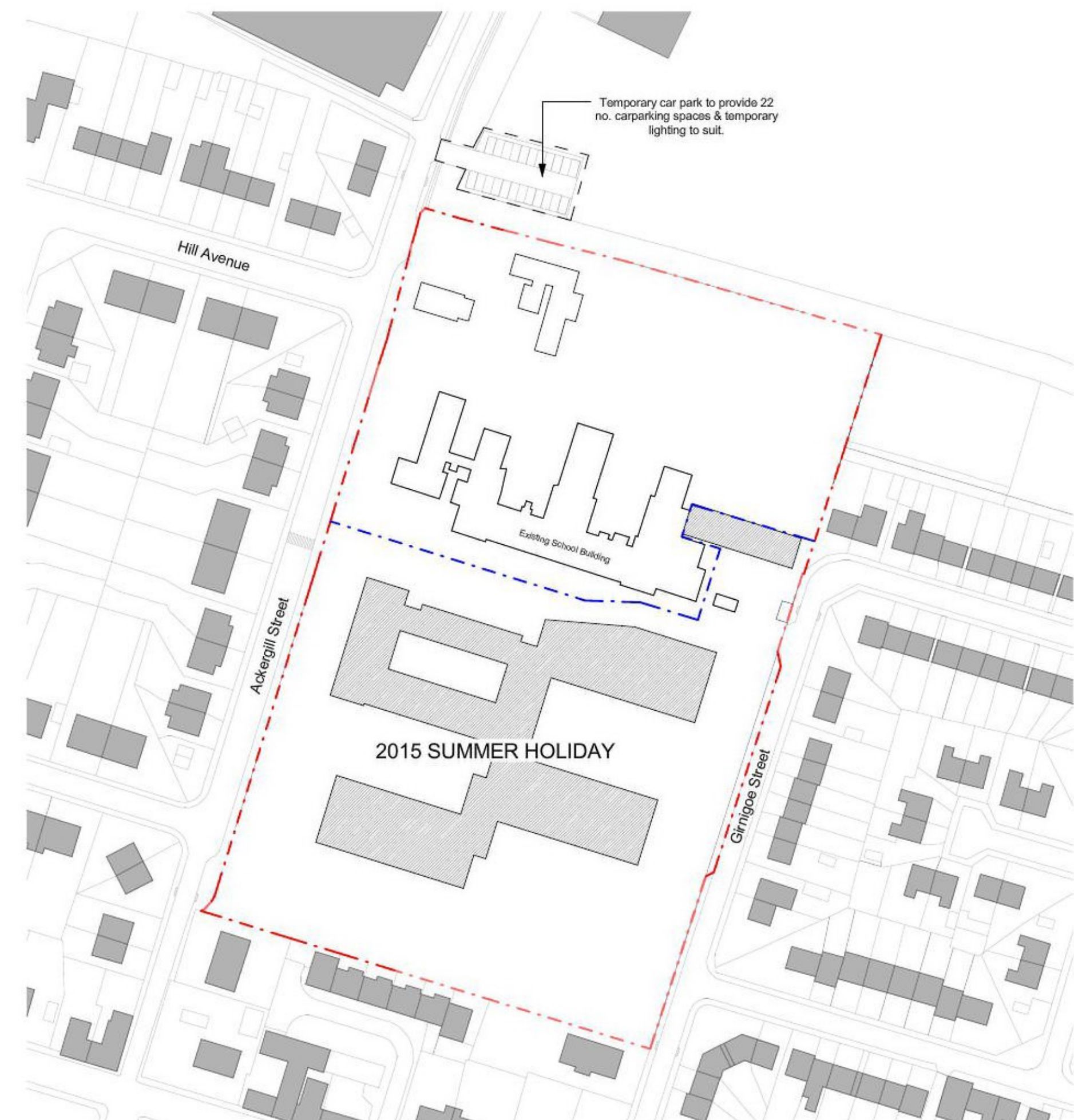

2015 Summer Holiday

1: 1250

2015 SUMMER HOLIDAY:
 School decant
 Demolition surveys, reports & HSE notification of asbestos removal (if required)
 Construct temporary staff & visitor car park to north of School boundary

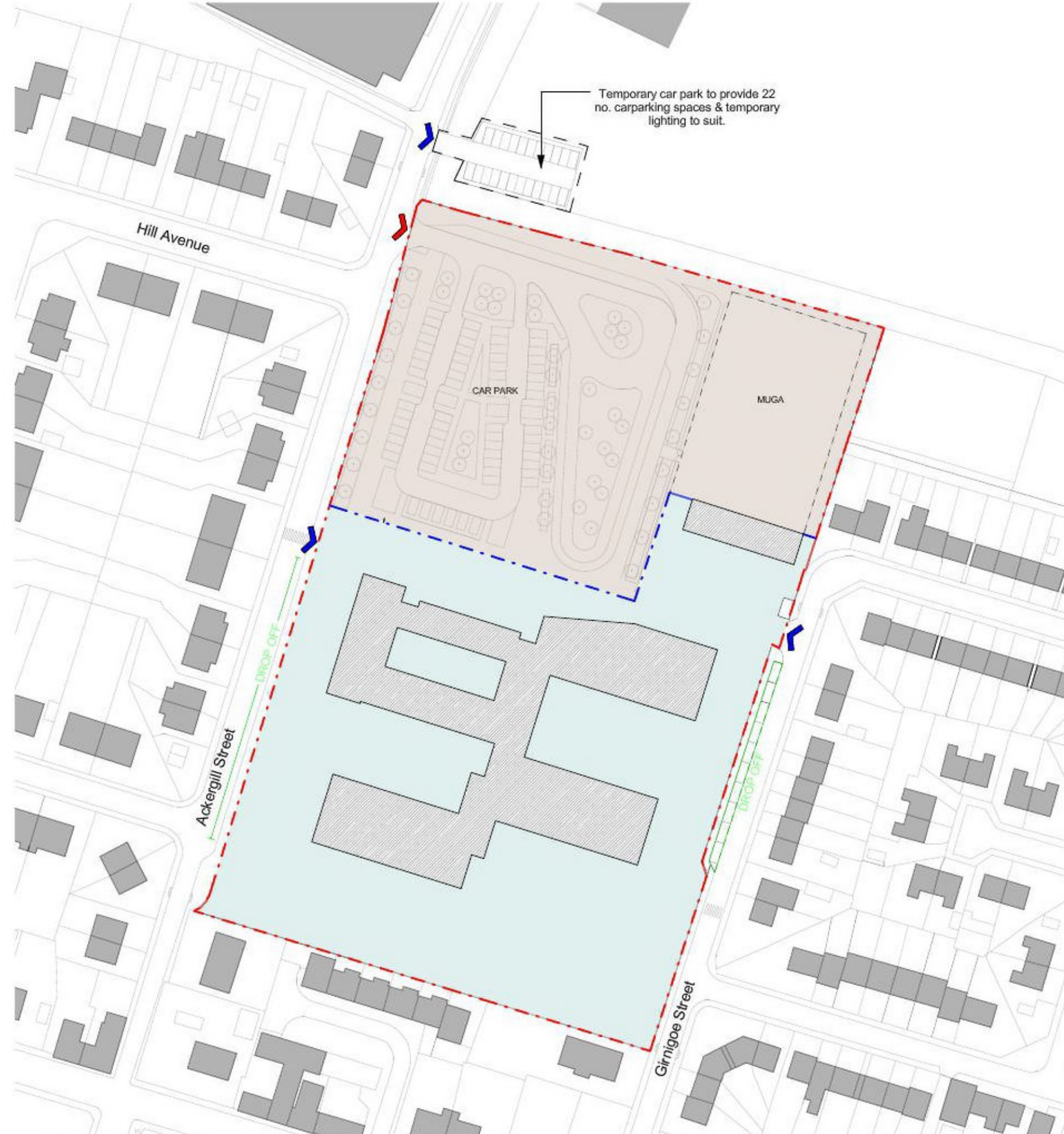

Phase 3

1: 1250

PHASE 3: Construction of new car park, drop off and MUGA
 KEY DATES:
 August 2015 to February 2016

The use of this data by the recipient acts as an agreement of the following statements. Do not use this data if you do not agree with any of the following statements:-

All drawings are based upon site information supplied by third parties and as such their accuracy cannot be guaranteed. All features are approximate and subject to clarification by a detailed topographical survey, statutory service enquiries and confirmation of the legal boundaries.

The controlled version of this drawing should be viewed in DWG or PDF format not DWG or other formats.

Where this drawing has been based upon Ordnance Survey data, it has been reproduced under the terms of Ryder Licence No. 110000144. Reproduction of this drawing in whole or in part is prohibited without the prior permission of Ordnance Survey.

Do not scale the drawing. Use figured dimensions in all cases. Check all dimensions on site. Report any discrepancies in writing to Ryder before proceeding.

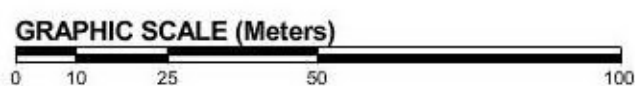

- Construction Access
- School Access
- Construction Egress
- Live School Area
- Construction Work Phase

Revision Date Drawn By

04 20/01/2014 DBU

Issue for information
 Extent of temporary playground increased

Revision Date Drawn By

03 9/1/2014 BDo

Issue for planning
 Drawing updated in line with Miller Construction phasing strategy

Revision Date Drawn By

02 13/12/2013 BDo

Issue for information
 Drawing updated in line with Miller Construction phasing strategy

Revision Date Drawn By

01 25/09/2013 BDo

Issue for planning

Amendment

Status

Preliminary

Project

Hub North

Wick North of the River PS

Drawing

Site Phasing Strategy

Project No. Drawing No.

2409.02 270-01-Rev04

Scale at A1 Drawn By

As indicated BDO