

SECTION 14-14

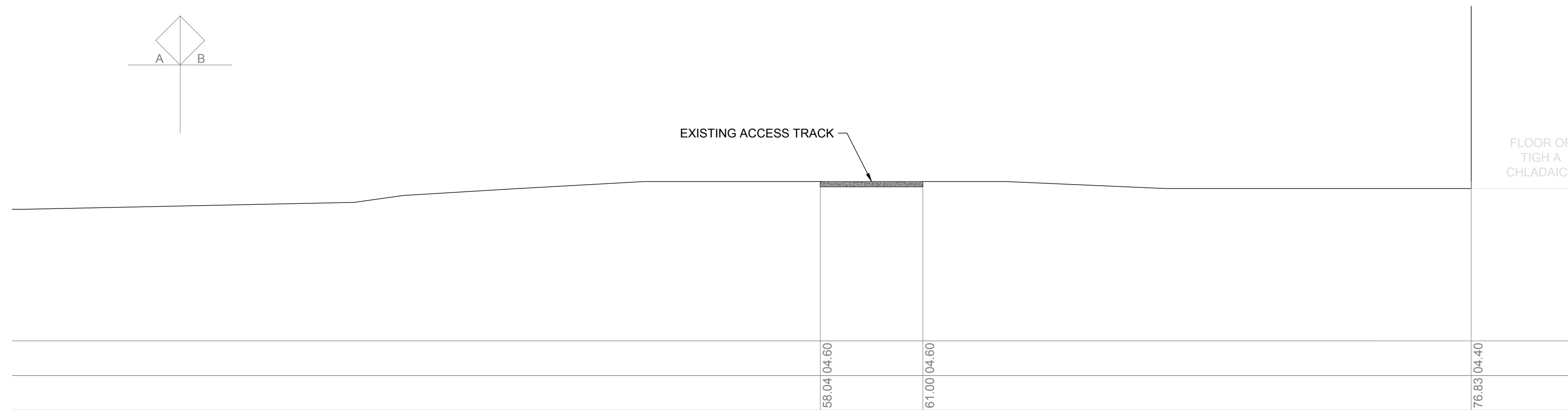

SECTION 14-14 CONTINUED



SECTION 15-15

- Rock Armour side slopes
- Shared Cyclepath/Footpath
- Flood Embankment
- Reprofiled Ground
- Access Track (Unsurfaced)
- Access Track (Surfaced Concrete)
- Access Track (Surfaced Asphalt)
- Existing Ground

- General Notes**
- All dimensions shown are in metres unless otherwise stated and levels in metres to Ordnance Datum.
  - Do not scale from this drawing.
  - This drawing is to be read in conjunction with:
    - 2013s7413-JBAU-00-00-DR-C-1001 - Chainage 0 to 2179.36m
    - 2013s7413-JBAU-00-00-DR-C-1002 - Chainage 0 to 76.80m
    - 2013s7413-JBAU-00-00-DR-C-1003 - Chainage 76.80 to 216.60m
    - 2013s7413-JBAU-00-00-DR-C-1004 - Chainage 216.60 to 334.41m
    - 2013s7413-JBAU-00-00-DR-C-1005 - Chainage 334.41 to 471.90m
    - 2013s7413-JBAU-00-00-DR-C-1006 - Chainage 471.90 to 595.52m
    - 2013s7413-JBAU-00-00-DR-C-1007 - Chainage 595.52 to 720.51m
    - 2013s7413-JBAU-00-00-DR-C-1008 - Chainage 720.51 to 842.19m
    - 2013s7413-JBAU-00-00-DR-C-1009 - Chainage 842.19 to 942.70m
    - 2013s7413-JBAU-00-00-DR-C-1010 - Chainage 942.70 to 1091.89m**
    - 2013s7413-JBAU-00-00-DR-C-1011 - Chainage 1091.89 to 1209.17m
    - 2013s7413-JBAU-00-00-DR-C-1012 - Chainage 1209.17 to 1335.97m
    - 2013s7413-JBAU-00-00-DR-C-1013 - Chainage 1335.97 to 1474.34m
    - 2013s7413-JBAU-00-00-DR-C-1014 - Chainage 1474.34 to 1589.43m
    - 2013s7413-JBAU-00-00-DR-C-1015 - Chainage 1589.43 to 1697.69m
    - 2013s7413-JBAU-00-00-DR-C-1016 - Chainage 1697.69 to 1824.43m
    - 2013s7413-JBAU-00-00-DR-C-1017 - Chainage 1824.43 to 1952.82m
    - 2013s7413-JBAU-00-00-DR-C-1018 - Chainage 1952.82 to 2080.00m
    - 2013s7413-JBAU-00-00-DR-C-1019 - Chainage 2080.00 to 2179.36m
    - 2013s7413-JBAU-00-00-DR-C-2001 - Flood Embankment Cross Sections 1 of 10
    - 2013s7413-JBAU-00-00-DR-C-2002 - Flood Embankment Cross Sections 2 of 10
    - 2013s7413-JBAU-00-00-DR-C-2003 - Flood Embankment Cross Sections 3 of 10
    - 2013s7413-JBAU-00-00-DR-C-2004 - Flood Embankment Cross Sections 4 of 10
    - 2013s7413-JBAU-00-00-DR-C-2005 - Flood Embankment Cross Sections 5 of 10
    - 2013s7413-JBAU-00-00-DR-C-2007 - Flood Embankment Cross Sections 7 of 10
    - 2013s7413-JBAU-00-00-DR-C-2008 - Flood Embankment Cross Sections 8 of 10
    - 2013s7413-JBAU-00-00-DR-C-2009 - Flood Embankment Cross Sections 9 of 10
    - 2013s7413-JBAU-00-00-DR-C-2010 - Flood Embankment Cross Sections 10 of 10
    - 2013s7413-JBAU-00-00-DR-C-3001 - Glenkingie Street Secondary Flooding Pumping Station - Plan and Schematic Long-Section
    - 2013s7413-JBAU-00-00-DR-C-3002 - Erracht Terrace Secondary Flooding Pumping Station - Plan and Schematic Long-Section
    - 2013s7413-JBAU-00-00-DR-C-3003 - Kilmalie Road Secondary Flooding Pumping Station - Plan and Schematic Long-Section
  - These plans are in accordance with the requirements of section 60 and Schedule 2 of the Flood Risk Management (Scotland) Act 2009.
  - The location, horizontal and vertical extents of the operations may vary by those limits (where applied) as noted in the Description of the Flood Protection Scheme.
  - The locations of any known services shown on drawing are approximate and for guidance only.
  - Diversion of any statutory undertaker apparatus will be carried out by or on behalf of the statutory undertaker under its own statutory powers.

Rev.:	Date	Drawn	N.T.	Designed	N.T.	Checked	I.F.	Approved	R.D.
1									

Comments: Revised in line with comments (THC/ JBA)

Client Approval: A - Approved, B - Approved with Revisions, C - Do Not Use

Purpose of Issue: For Consultation, Status: S4

**JBA consulting**

Unit 2.1  
Quantum Court  
Research Avenue South  
Heriot Watt University  
Edinburgh  
EH14 4AP  
United Kingdom  
www.jbaconsulting.com  
t +44 (0)131 3192940  
f +44 (0)845 8627772  
e info@jbaconsulting.com

Offices at Coleshill, Doncaster, Edinburgh, Exeter, Glasgow, Haywards Heath, Isle of Man, Leeds, Limerick, Newcastle upon Tyne, Newport, Peterborough, Salford, Skipton, Tadcaster, Thirsk, Wallingford and Warrington

**Project** Caol & Lochside Flood Protection Scheme

**Title** Flood Embankment Cross Sections 6 of 10 for

**Client** The Highland Council  
Comhairle na Gàidhealtachd

The property of this drawing and design vested in Jeremy Benn Associates Ltd. It shall not be reproduced in whole or in part, nor disclosed to a third party, without the prior written consent of Jeremy Benn Associates Ltd.

Scale	1:100 @ A1	Drawn:	S. Brandon	05/05/2017
		Designed:	N. Tourigny	05/05/2017
		Checked:	I. Ferguson	05/05/2017
		Approved:	R. Dobson	05/05/2017

Project Number: 2013s7413  
Drawing Number: 2013s7413-JBAU-00-00-DR-C-2006  
Revision: 1