

Map of Kingussie (Small Scale)

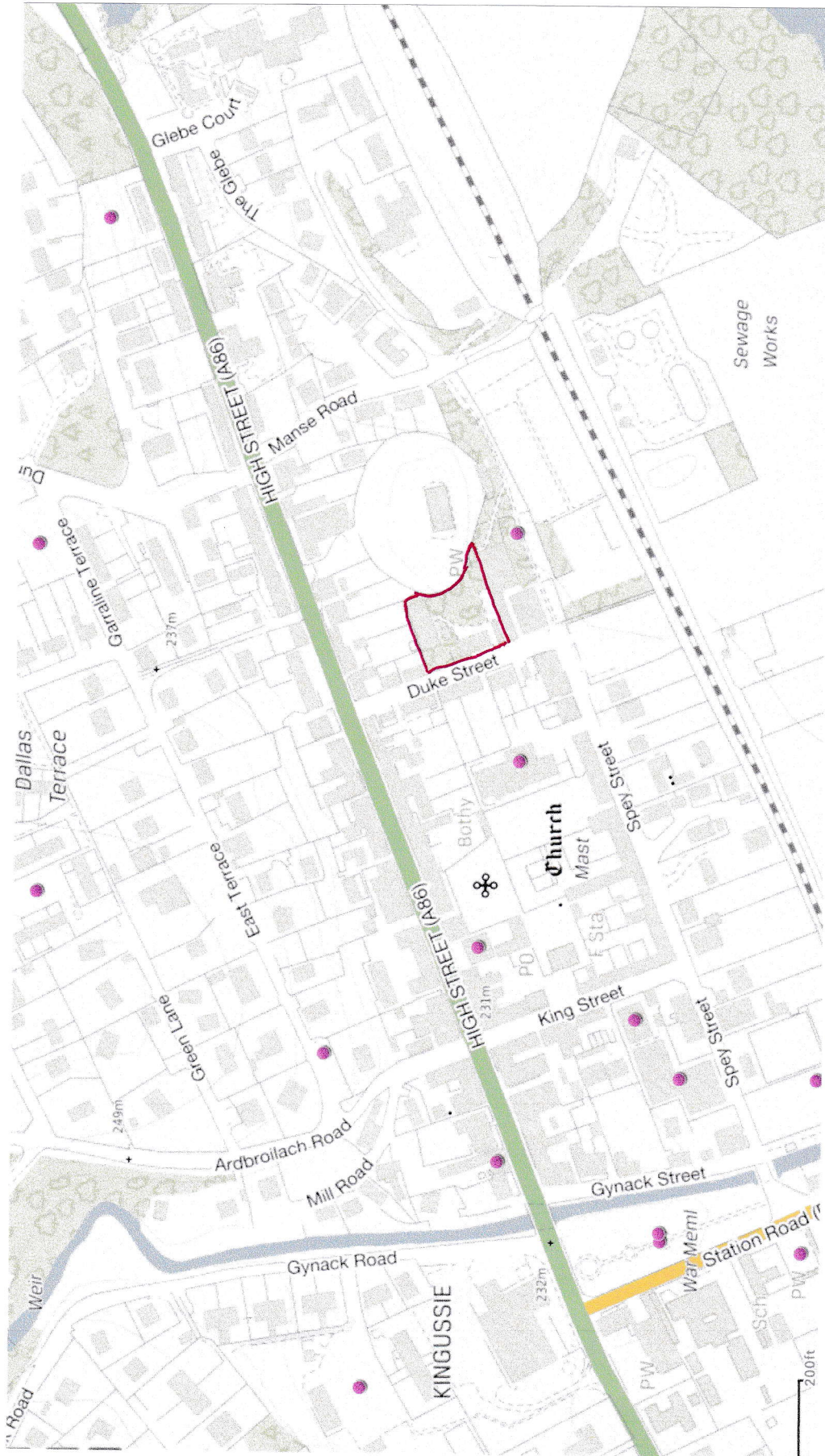

Map of Kingussie (Large Scale)

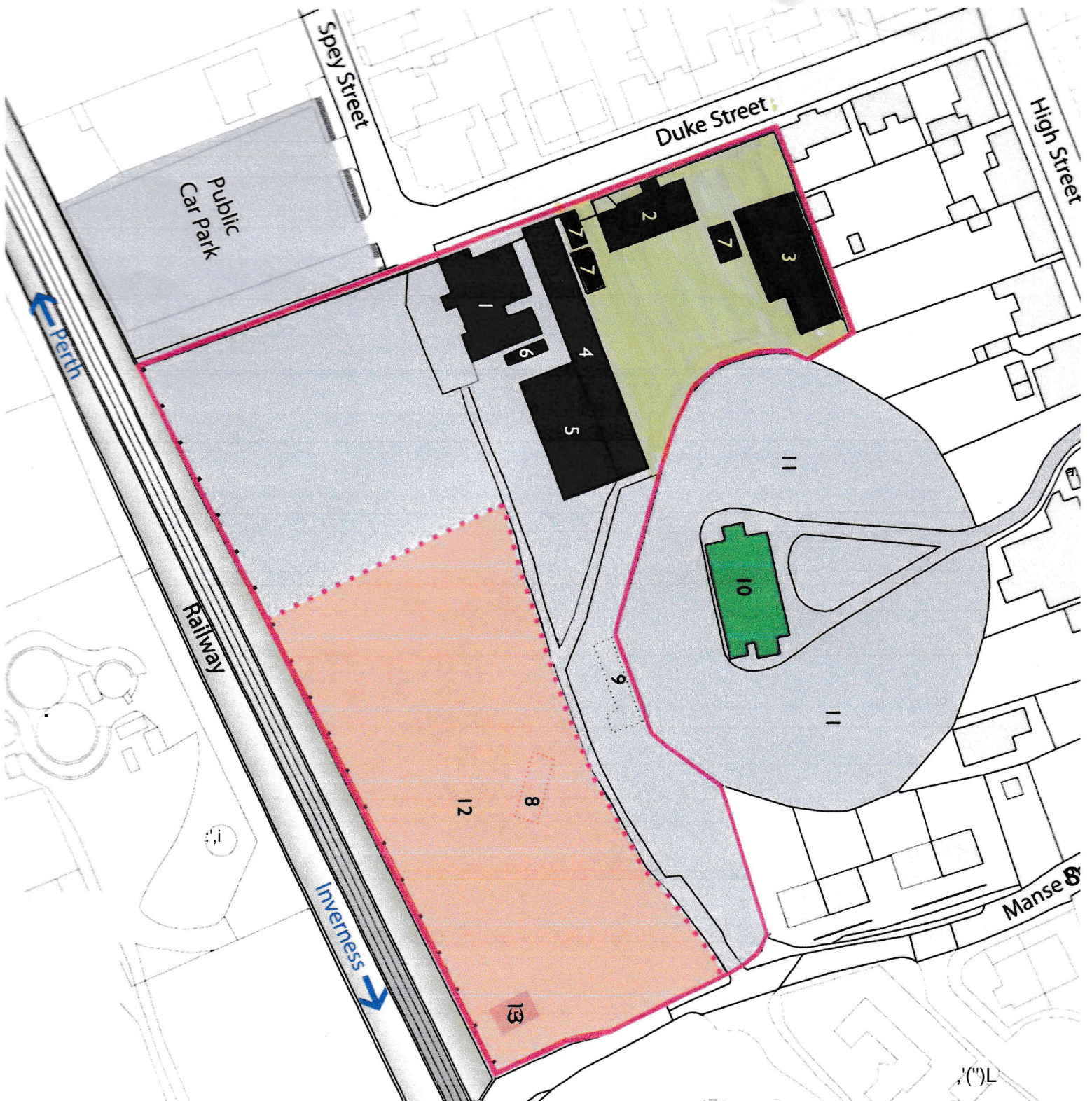

LAND OWNERSHIP
 The site is currently owned by Highland Council. The adjacent 100m square plot is owned by The Council of Scotland Buildings Parish (Ordnance Survey Burial Ground), Newmarket Ball (Haymarket), Highland Council.

KEY:

1. Pitmain Lodge
2. MacRobert House
3. Museum Store
4. Farming Museum
5. Open Barn (dismantled)
6. Portaloo Toilets
7. Shed
8. Blackhouse (dismantled)
9. Old Dairy/Coach House (ruin)
10. Kingussie Parish Church
11. Burial Ground
12. Allotments & Growing Spaces
13. Community Shed

