

LOCATION PLAN  
SCALE 1:50,000

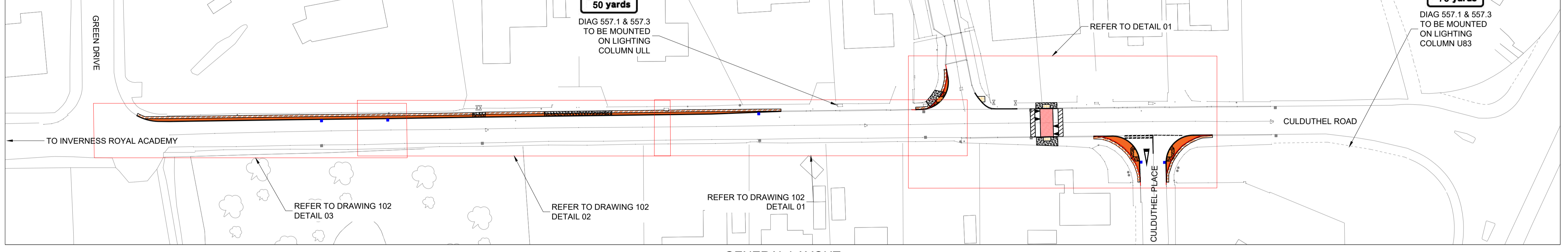

GENERAL LAYOUT  
SCALE 1:500

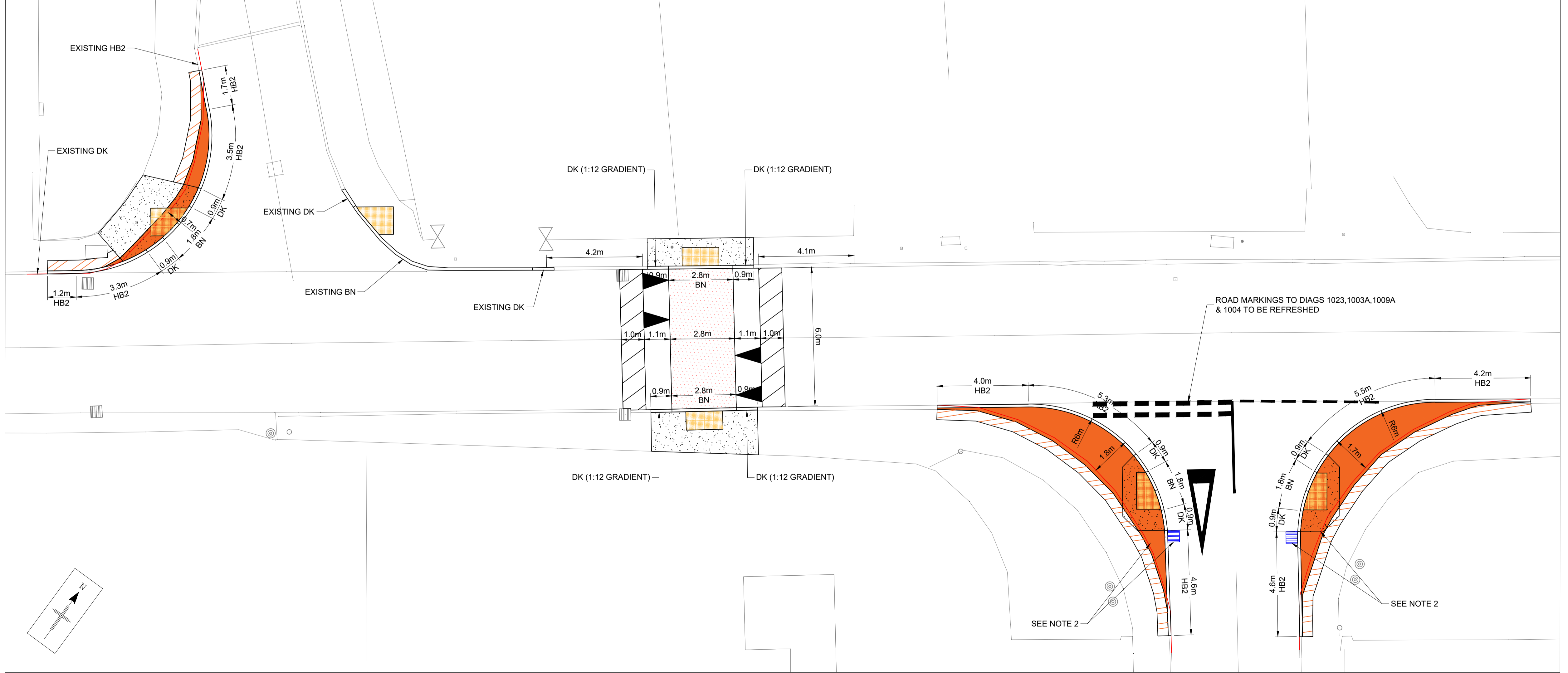

DETAIL 01  
SCALE 1:100

COPYRIGHT, DESIGNS and PATENTS ACT 1988:  
THIS DRAWING MAY NOT BE REPRODUCED, COPIED OR USED IN ANY WAY WITHOUT THE WRITTEN PERMISSION OF THE DIRECTOR OF DEVELOPMENT AND INFRASTRUCTURE.  
© THE HIGHLAND COUNCIL  
© CROWN COPYRIGHT AND DATABASE RIGHTS 2019 OS 100023369. YOU ARE GRANTED A NON-EXCLUSIVE, ROYALTY FREE, REVOCABLE LICENCE SOLELY TO VIEW THE LICENSED DATA FOR NON-COMMERCIAL PURPOSES FOR THE PERIOD WHICH THE HIGHLAND COUNCIL MAKES IT AVAILABLE. YOU ARE NOT PERMITTED TO COPY, SUB-LICENSE, DISTRIBUTE, SELL OR OTHERWISE MAKE AVAILABLE THE LICENSED DATA TO THIRD PARTIES IN ANY FORM. THIRD PARTY RIGHTS TO ENFORCE THE TERMS OF THIS LICENCE SHALL BE RESERVED TO THE OS.

DO NOT SCALE FROM DRAWING.  
ALL DIMENSIONS ARE IN mm UNLESS OTHERWISE STATED.

- NOTES
- LEGEND:
    - RED ANTI-SKID SURFACE
    - PROPOSED FOOTPATH EXTENSION
    - 450mm TIE IN TO EXISTING FOOTPATH
    - FOOTPATH TO BE REGRADED
    - TACTILE PAVING TILES (400 X 400mm)
    - EXISTING FRONT FACE OF KERB
  - BN - BULLNOSE KERB  
HB2 - HALF BATTERED KERB  
DK - DROPPER KERB  
FOR KERB DETAILS SEE DRAWING 104 -DETAILS 04
  - PROPOSED GULLY TO TIE INTO EXISTING PIPE.  
EXISTING GULLY TO BE REMOVED AND BACKFILLED WITH TYPE 1 MATERIAL.

CONSULTATION ISSUE

01	CONSULTATION ISSUE	CF	BS	08/12/20
REV	REVISION DETAILS	DRAWN BY	CHECK BY	DATE



PROJECT DESIGN UNIT  
COUNCIL BUILDINGS  
HIGH STREET  
DINGWALL IV15 9QN

PHONE: 01349 868800  
E-MAIL: PDU.DT2@highland.gov.uk

PROJECT  
**CYCLING, WALKING AND SAFER STREETS AT INVERNESS ROYAL ACADEMY**

TITLE  
**RAISED TABLE AND FOOTPATH IMPROVEMENTS**

SCALE	AS SHOWN	ORIGINAL SIZE	A1 (594 x 841)
DRAWN	CF	DATE	20/08/20
CHECKED	DRAFT	DATE	XX/XX/XX
PROJECT No.	YCHVS3036		
DRAWING No.	101	REVISION	01

T:\001\_Design Team 2003\_Small\_Schemes\_Projects\HAS3001 Safer Routes To School\2020 - 2021 Schemes\Inverness Royal Academy YAO0492 DRAWINGS\CAD\LIVE\IRA\_LIVE\_01.dwg 08/12/2020 ANSI A (6.50 x 11.00 inches)