

- Notes:**
- All work to comply with The Highland Council's - Standards for Road Construction Consent.
 - Prior to roads construction works, the appointed Contractor is to submit CBR test results and details of any capping requirements to the roads officer at The Highland Council who is processing the RCC application.
 - Road signs and markings to be in accordance with the Traffic Signs Regulations And General Directions (TSRGD) 2016.
 - The contractor is responsible for checking the line and level of existing services prior to the commencement of works. Any discrepancies from design information must be reported to the Site Manager and Site Engineer in writing.
 - Non-adopted areas to drain via porous paving or free draining gravel. Where parking areas or driveway's fall towards the adopted carriageway, a channel drain is to be provided to prevent water running onto adopted areas.

- Legend:**
- Road Gully (Connections to surface water sewer to be made with 'Y' branches)
 - Vehicle & pedestrian drop kerbs
 - Pedestrian Tactile Paving
 - Street Nameplate
 - Junction Visibility Splays

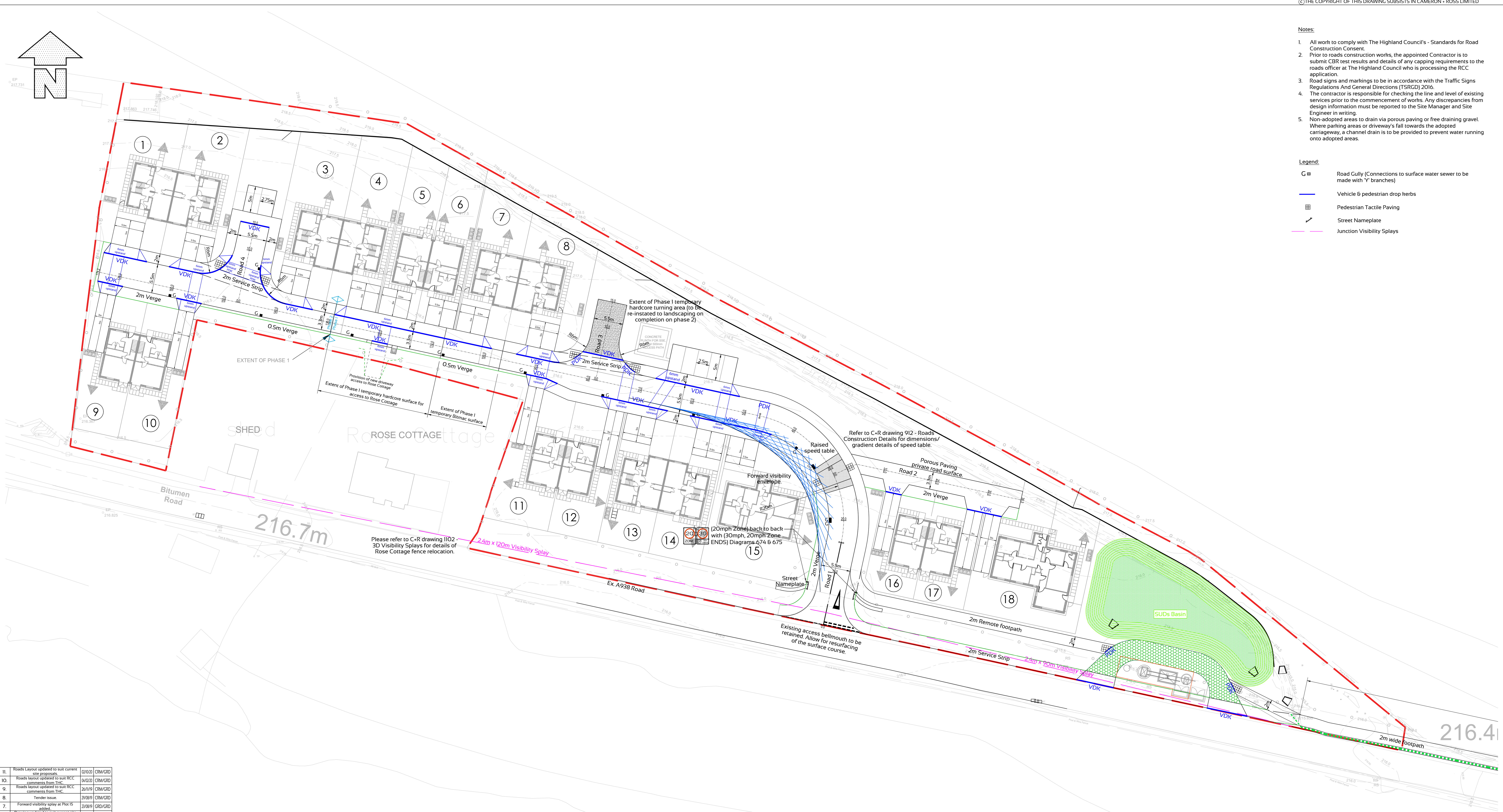

11.	Roads layout updated to suit current site proposals.	03/02	CRM/GRD
10.	Roads layout updated to suit RCC comments from THC.	04/02	CRM/GRD
9.	Roads layout updated to suit RCC comments from THC.	26/1/19	CRM/GRD
8.	Tender issue.	20/08/18	CRM/GRD
7.	Forward visibility splay at Plot 15 added.	20/08/18	GRD/GRD
6.	Drawing updated to suit current site layout.	20/11/18	CRM/GRD
5.	Drawing updated to suit current proposals.	26/06/18	CRM/GRD
4.	Drawing updated to suit current proposals.	04/04/18	CRM/GRD
3.	Roads layout updated to suit current site layout.	04/03/18	CRM/GRD
2.	Roads layout updated to suit current proposals.	07/03/18	CRM/GRD
1.	Red line boundary updated.	04/03/18	CRM/GRD
	INITIAL ISSUE	28/02/18	CRM/BAC
Rev	AMENDMENTS	Date	By

This drawing to be read in conjunction with:
 Drawing Nos.
 Site Schedule Nos.

Land North of Rose Cottage
 Duinain Bridge

Highland Housing Alliance

Proposed Roads Layout

Scale: 1:250 @ A0



CRM	Contact No.	Drawing No.	Rev.
BAC	1/181185	910	11.
GRD			

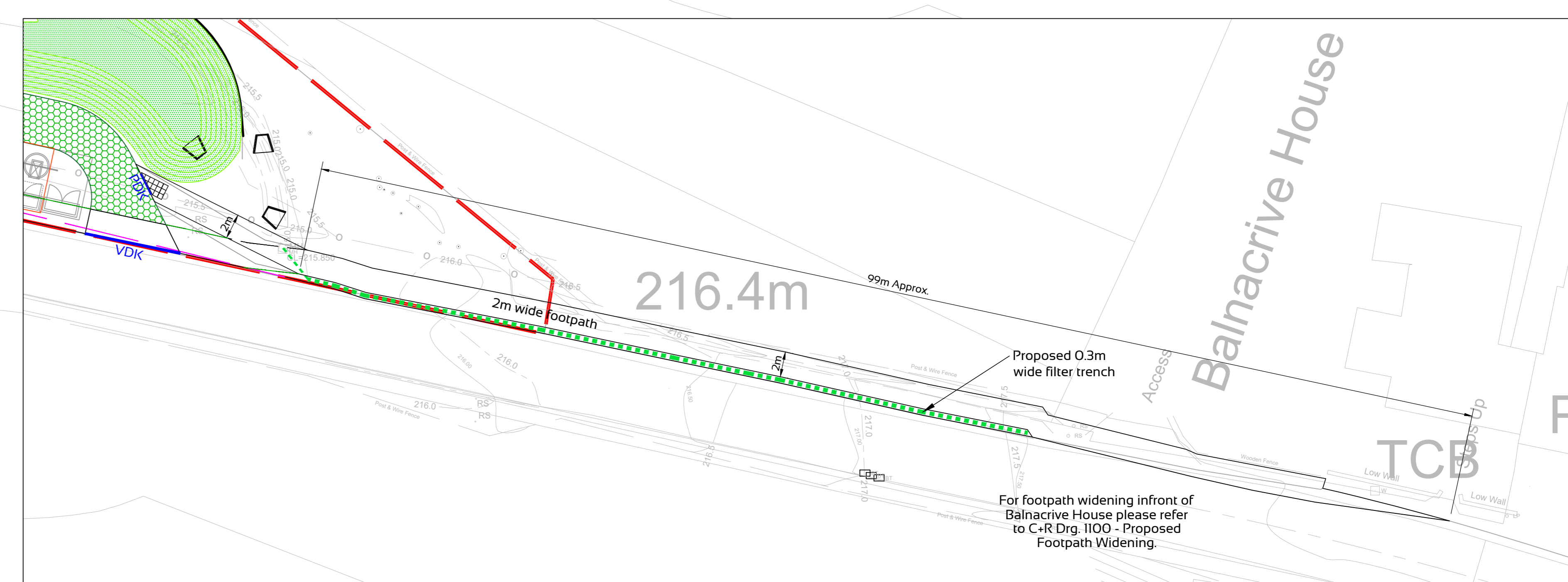

Broomie Knowe

For footpath widening in front of Balnacrive House please refer to C-R Dwg 1100 - Proposed Footpath Widening.