

LOCATION PLAN
SCALE 1:50,000

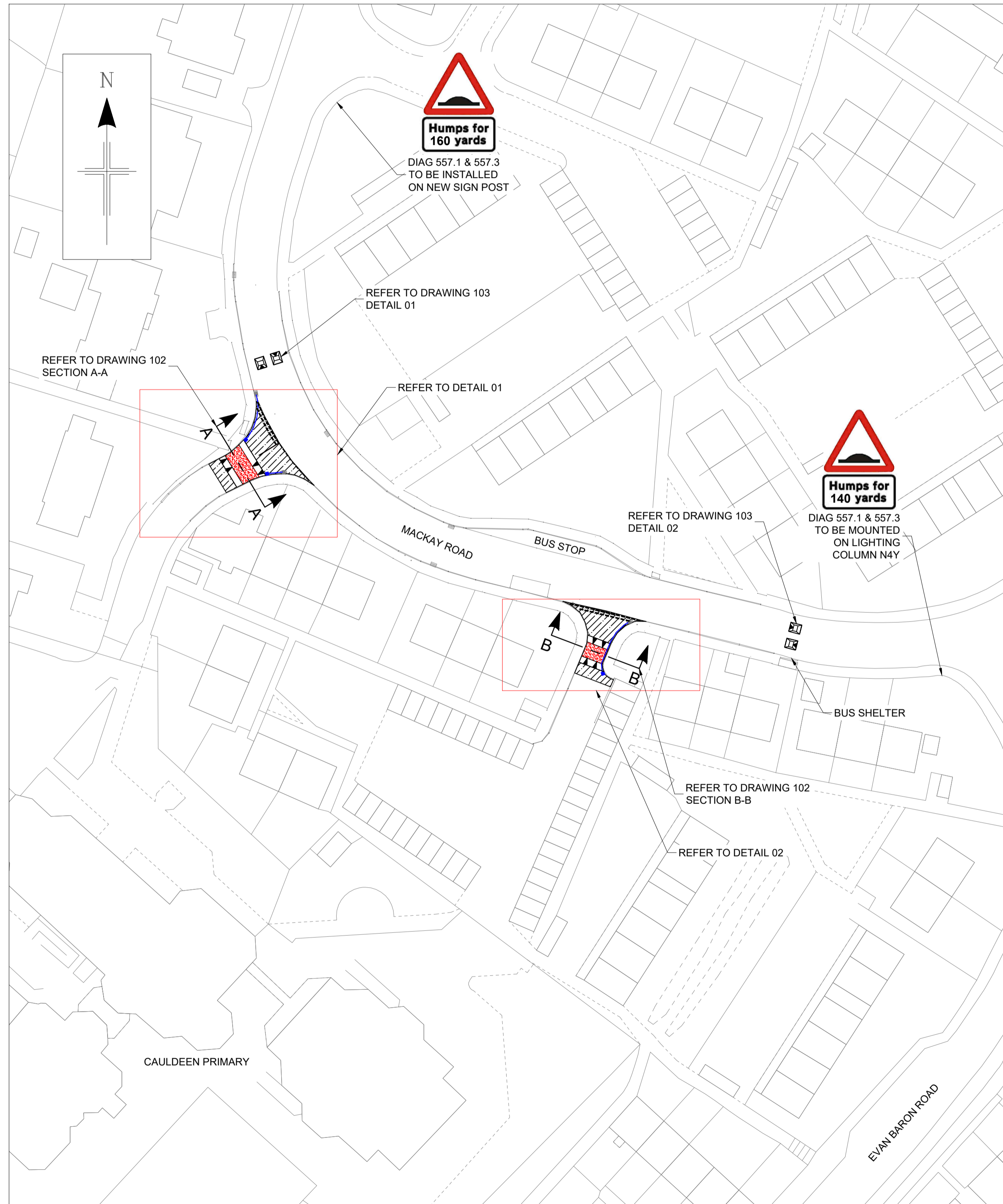

GENERAL LAYOUT
SCALE 1:500

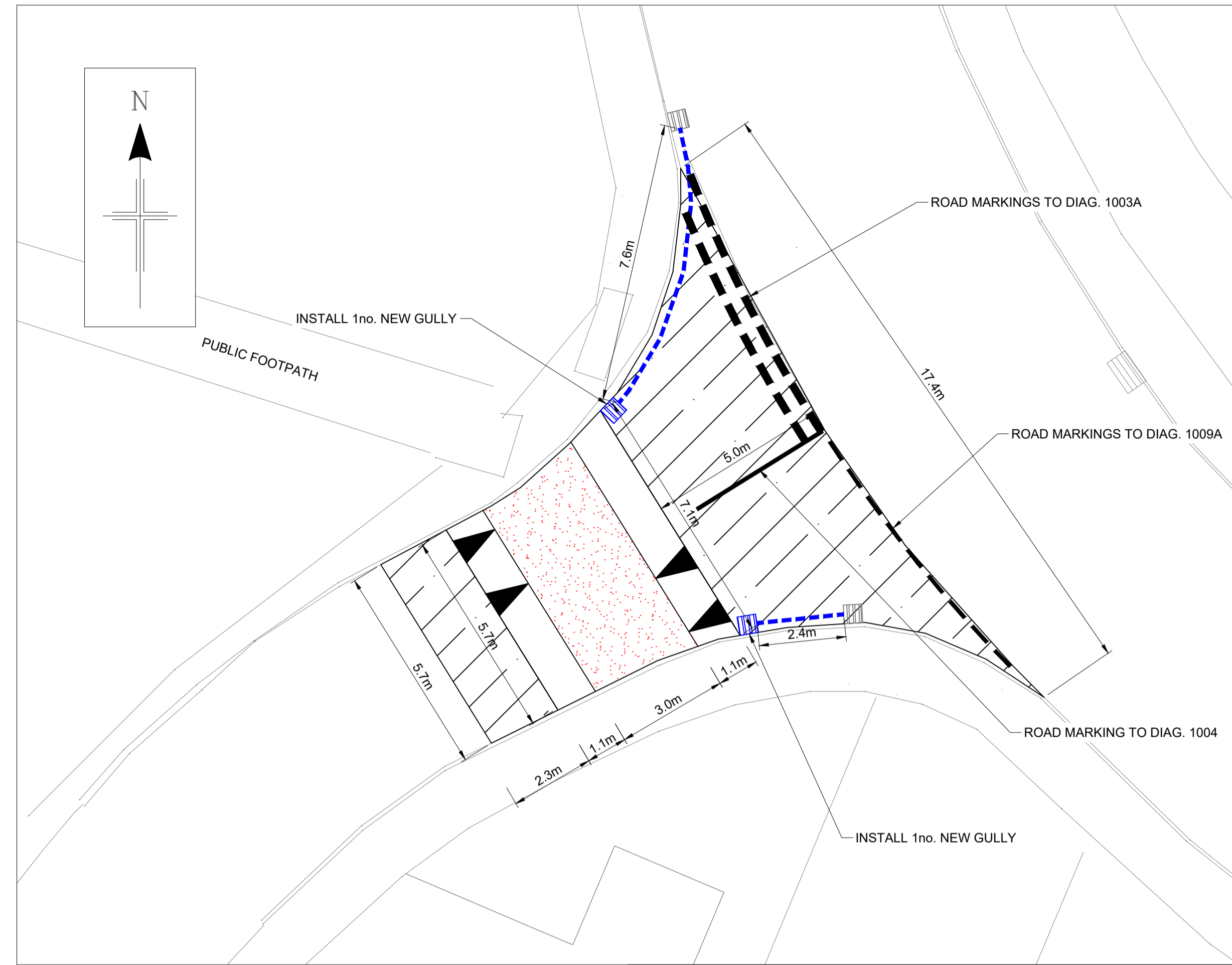

DETAIL 01
SCALE 1:100

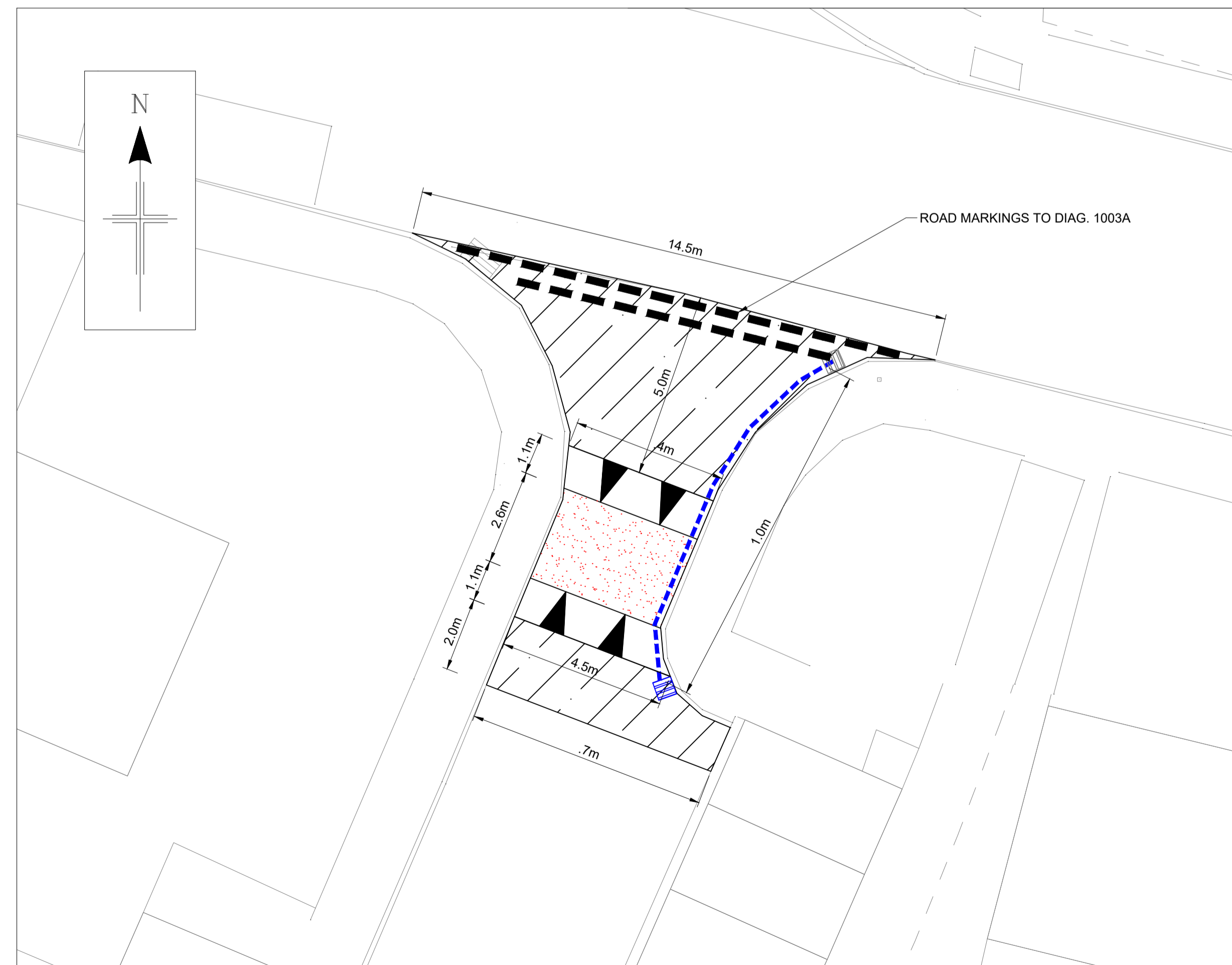

DETAIL 02
SCALE 1:100

COPYRIGHT, DESIGNS and PATENTS ACT 1988:
THIS DRAWING MAY NOT BE REPRODUCED, COPIED OR USED IN ANY WAY WITHOUT THE WRITTEN PERMISSION OF THE DIRECTOR OF DEVELOPMENT AND INFRASTRUCTURE.
© THE HIGHLAND COUNCIL
© CROWN COPYRIGHT AND DATABASE RIGHTS 2019 OS 100023369. YOU ARE GRANTED A NON-EXCLUSIVE, ROYALTY FREE, REVOCABLE LICENCE SOLELY TO VIEW THE LICENSED DATA FOR NON-COMMERCIAL PURPOSES FOR THE PERIOD WHICH THE HIGHLAND COUNCIL MAKES IT AVAILABLE. YOU ARE NOT PERMITTED TO COPY, SUB-LICENSE, DISTRIBUTE, SELL OR OTHERWISE MAKE AVAILABLE THE LICENSED DATA TO THIRD PARTIES IN ANY FORM. THIRD PARTY RIGHTS TO ENFORCE THE TERMS OF THIS LICENCE SHALL BE RESERVED TO THE OS.

DO NOT SCALE FROM DRAWING.
ALL DIMENSIONS ARE IN mm UNLESS OTHERWISE STATED.

- NOTES
1. LEGEND
- PROPOSED GULLY - ALLOW CONNECTION TO EXISTING GULLY
 - EXISTING GULLY
 - PROPOSED RAISED TABLE
 - AREA TO BE RESURFACED (111m² APPROX)

CONSULTATION ISSUE

01	CONSULTATION ISSUE	CF	BS	07/07/20
REV	REVISION DETAILS	DRAWN BY	CHECK BY	DATE



INFRASTRUCTURE & ENVIRONMENT

PROJECT DESIGN UNIT
COUNCIL BUILDINGS
HIGH STREET
DINGWALL IV15 9QN

PHONE: 01349 868800
E-MAIL: PDU.DT2@highland.gov.uk

PROJECT
CYCLING, WALKING AND SAFER STREETS AT CAULDEEN PRIMARY SCHOOL

TITLE
CROSSING IMPROVEMENTS

	SCALE AS SHOWN	ORIGINAL SIZE A1 (594 x 841)
DRAWN	CF	DATE 11/06/20
CHECKED	BS	DATE 07/07/20

PROJECT No. **YCHVS3017**
DRAWING No. **101** REVISION **01**

T:\001_Design Team 2\003_Small_Schemes_Projects\HAS3001 Safer Routes To School\2020 - 2021 Schemes\Cauldeen Primary - YCHVS3017\2 DRAWINGS\CAD\LIVE\YCHVS3017_LIVE_01.dwg 07/07/2020 ANSI A (8.50 x 11.00 inches)