

C:\Users\rosab\The Highland Council\Road Safety Team - Area\Munlochy Junction TRO 2022.dwg; 31/10/2022; ANSI A (8.50 x 11.00 inches)



LOCATION

This is the indicative plan for the foregoing order. The Highland Council (Munlochy Junction with the A9 Trunk Road) (Prohibition of Right Turn) ORDER 2022

Proper Officer

COPYRIGHT, DESIGNS and PATENTS ACT 1988:
This drawing may not be reproduced, copied or used in any way without the written permission of the Director of Development & Infrastructure.
© THE HIGHLAND COUNCIL

Notes

Reproduced from the Ordnance Survey mapping with the permission of the Controller of Her Majesty's Stationery Office © Crown Copyright.
Unauthorised reproduction infringes crown copyright and may lead to prosecution or civil proceedings.
The Highland Council 2015 100023369



Prohibited Manoeuvre

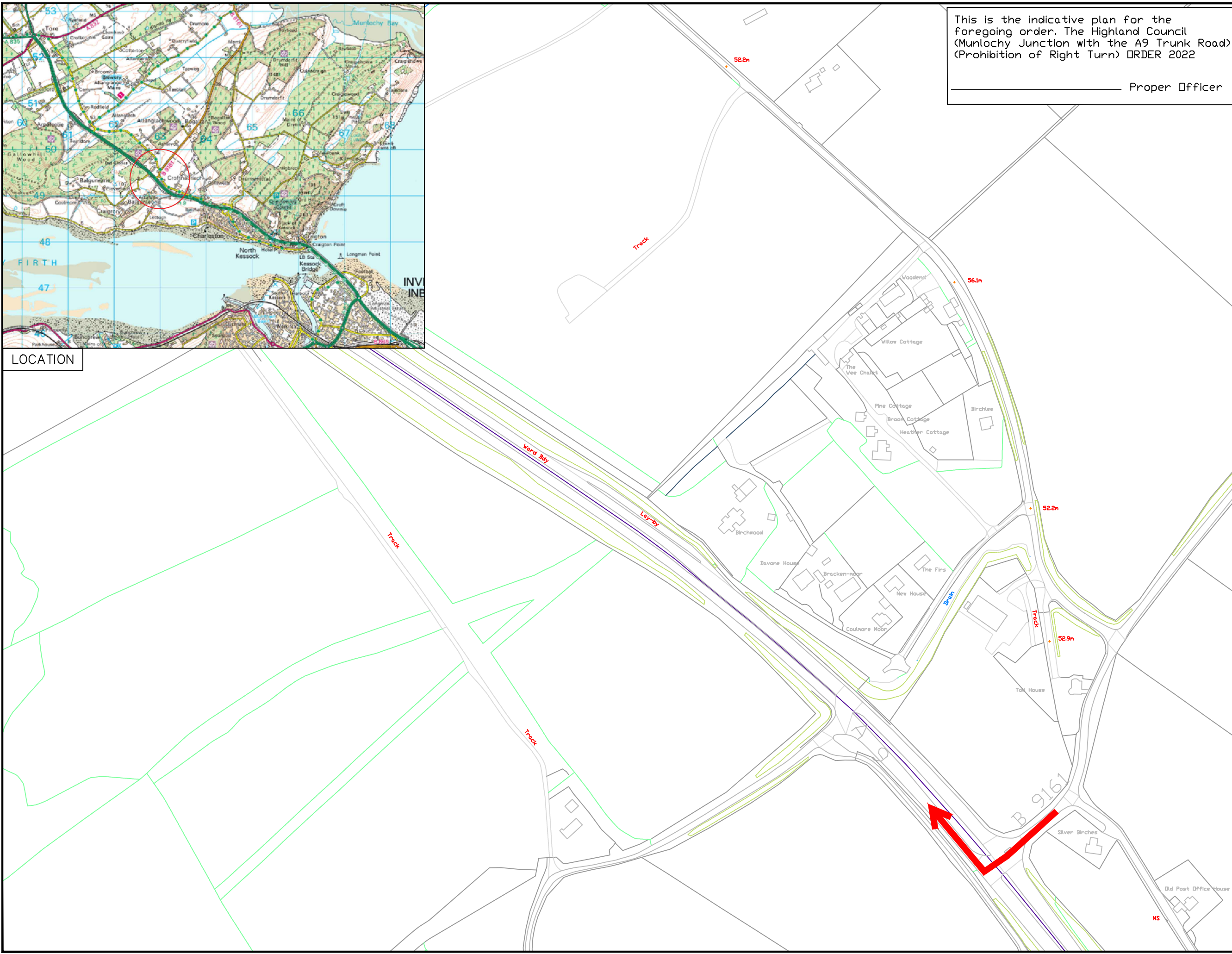

Revision	By	Check	Date	Surf.

Revision Details



INFRASTRUCTURE AND ENVIRONMENT

ROAD SAFETY TEAM
HQ
GLENURQUHART ROAD
INVERNESS IV3 5NX

Phone : 01463 702962
E-Mail : ross.barlett@highland.gov.uk

Project
Munlochy Junction
Proposed Prohibition of Right Turn

Title
Indicative Plan

Scale (at A1)
NTS

Drawn	RB	Date	31.10.2022
Checked	LM	Date	31.10.2022

Project No:	
Drawing No:	
Rev:	