

T:\001_Design Team 2\003_Small_Schemes_Projects\HAS3001 Safer Routes To School\2022 - 2023 Schemes\20 MPH Schemes\Invergordon\2 DRAWINGS\CAD\Live\YCHAS3012_INVERGORDON_LIVE_01.dwg 02/05/2023 ANSIA (8.50 x 11.00 inches)

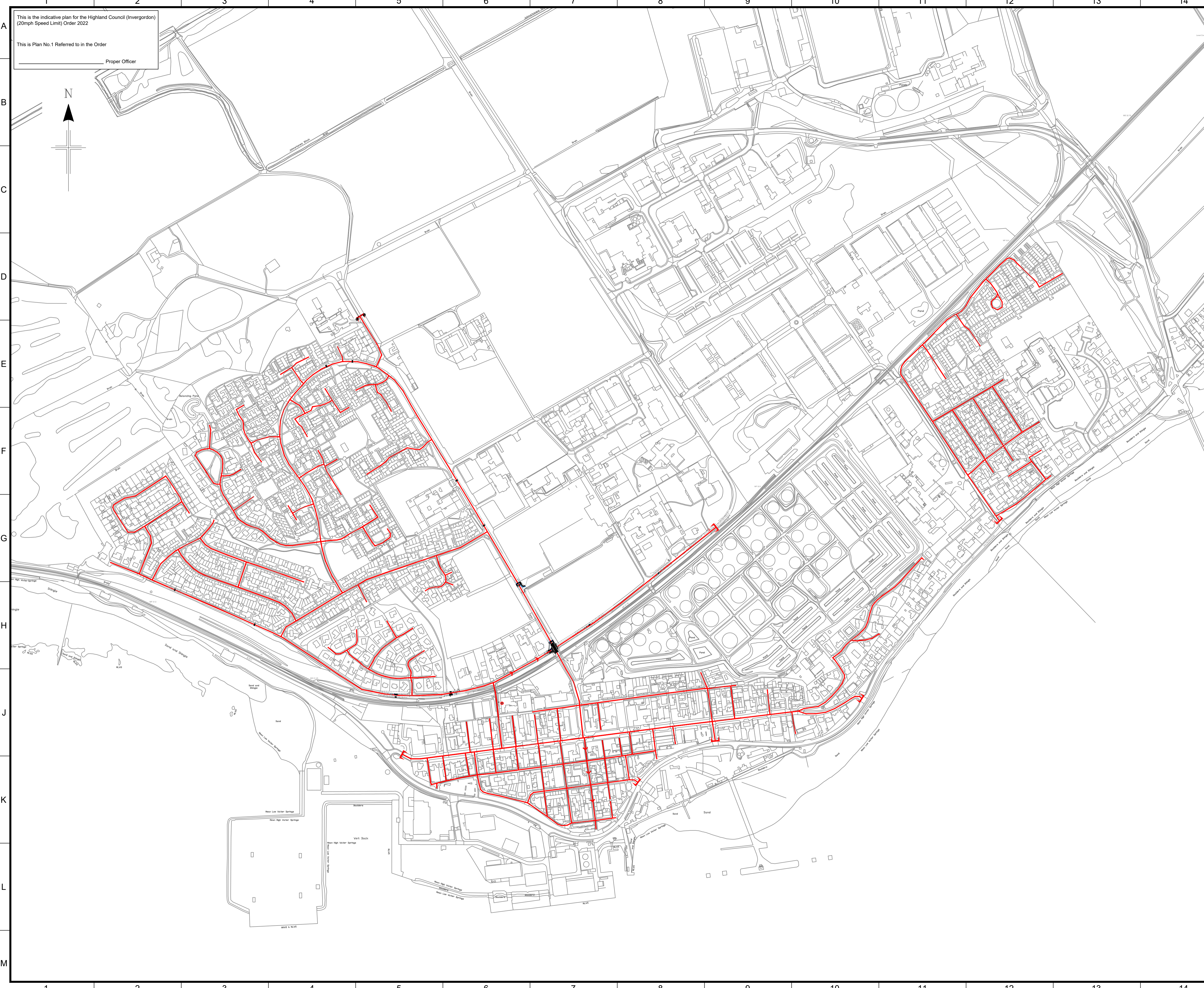

This is the indicative plan for the Highland Council (Invergordon) (20mph Speed Limit) Order 2022
 This is Plan No.1 Referred to in the Order
 Proper Officer

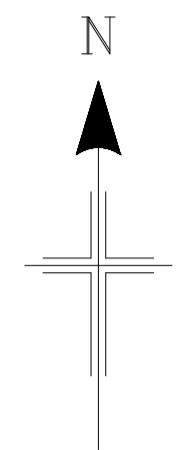

COPYRIGHT, DESIGNS and PATENTS ACT 1988:
 THIS DRAWING MAY NOT BE REPRODUCED, COPIED OR USED IN ANY WAY WITHOUT THE WRITTEN PERMISSION OF THE DIRECTOR OF DEVELOPMENT AND INFRASTRUCTURE.
 © THE HIGHLAND COUNCIL
 © CROWN COPYRIGHT AND DATABASE RIGHTS 2019 OS 100023369. YOU ARE GRANTED A NON-EXCLUSIVE, ROYALTY FREE, REVOCABLE LICENCE SOLELY TO VIEW THE LICENSED DATA FOR NON-COMMERCIAL PURPOSES FOR THE PERIOD WHICH THE HIGHLAND COUNCIL MAKES IT AVAILABLE. YOU ARE NOT PERMITTED TO COPY, SUB-LICENSE, DISTRIBUTE, SELL OR OTHERWISE MAKE AVAILABLE THE LICENSED DATA TO THIRD PARTIES IN ANY FORM. THIRD PARTY RIGHTS TO ENFORCE THE TERMS OF THIS LICENCE SHALL BE RESERVED TO THE OS.

DO NOT SCALE FROM DRAWING.
 ALL DIMENSIONS ARE IN mm UNLESS OTHERWISE STATED.

NOTES
 1. LEGEND

— 20MPH LIMIT

CONSULTATION
 ISSUE

01	CONSULTATION ISSUE	CF	BS	21/10/21
REV	REVISION DETAILS	DRAWN BY	CHECK BY	DATE

The Highland Council
Comhairle na Gàidhealtachd
INFRASTRUCTURE, ENVIRONMENT & ECONOMY
 ROAD SAFETY TEAM
 HQ
 GLENURQUHART ROAD
 INVERNESS IV3 5NX
 PHONE: 01349 886610
 E-MAIL: road.safety@highland.gov.uk

PROJECT
**INVERGORDON
 20MPH Speed Limit
 TRO PLAN**

TITLE
PLAN VIEW

	SCALE 1:4000	ORIGINAL SIZE A1 (594 x 841)
DRAWN	CJS	DATE 24/06/2021
CHECKED	BJS	DATE 24/06/21
PROJECT No.	YCHAS3012	
DRAWING No.	TRO	REVISION 01