

PLAN

SCALE 1:10,000

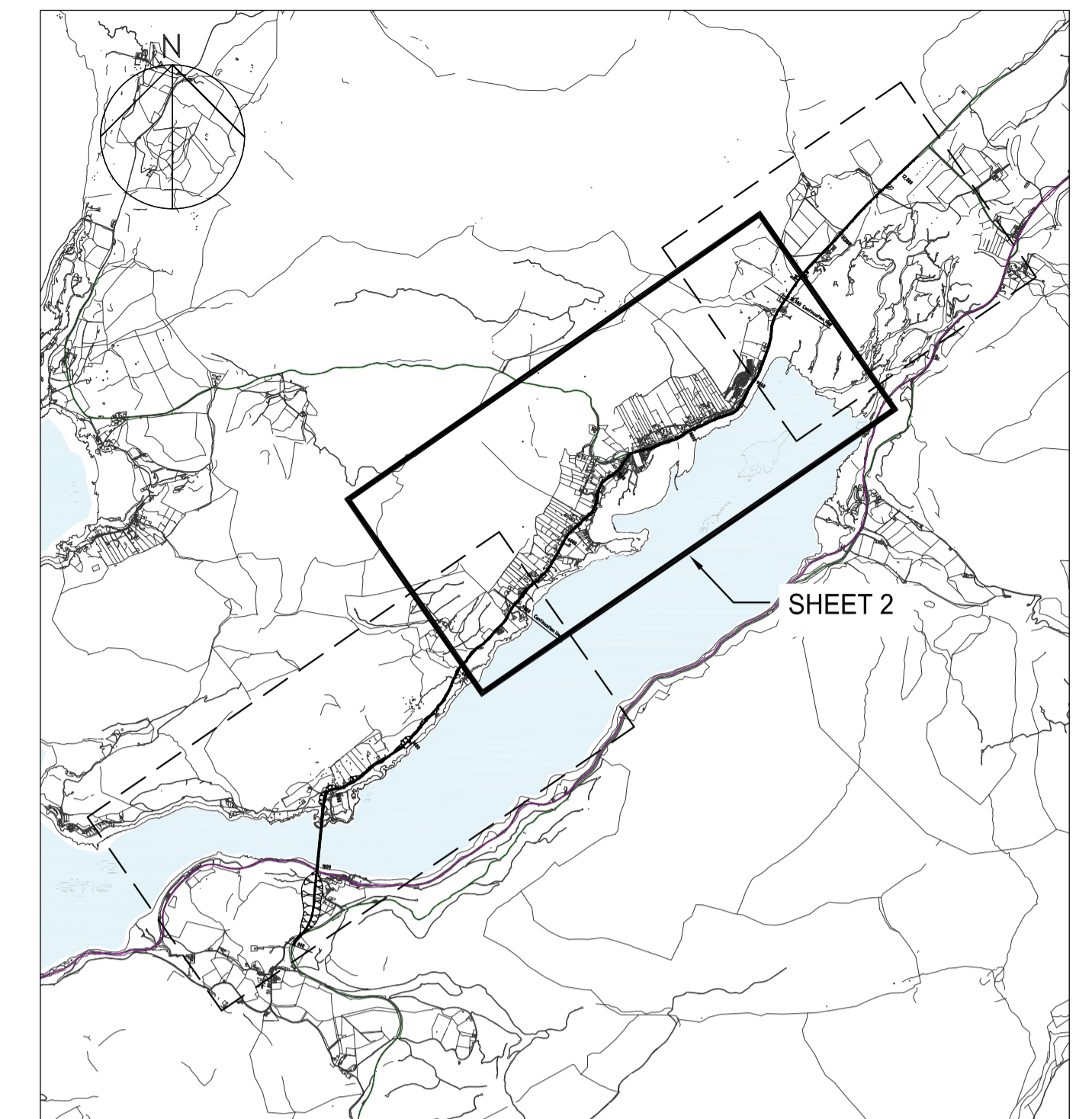

KEY PLAN

KEY

- Existing Railway
- Existing "A" Roads

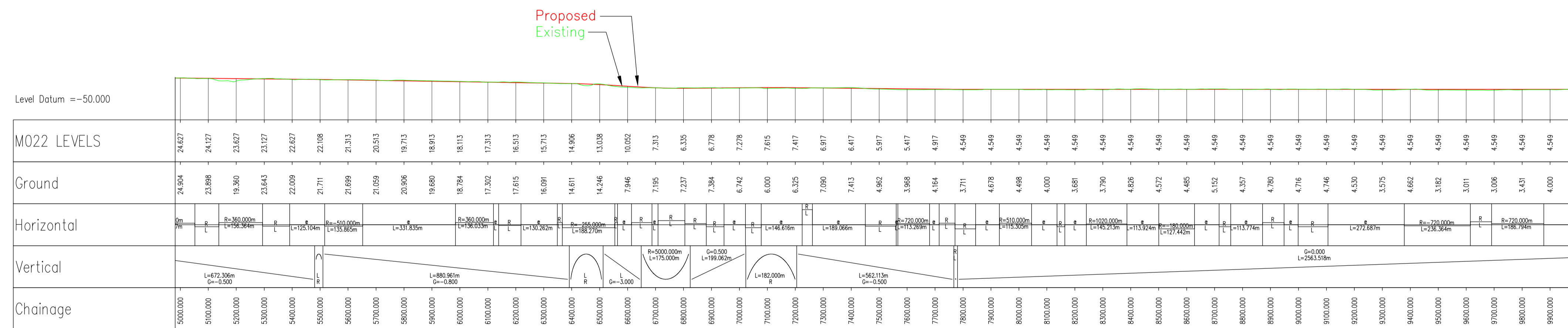

PROFILE

SCALE 1:10,000H, 1:5000V

This drawing is for preliminary purposes only and is subject to amendment during design development. UNDER NO CIRCUMSTANCES MUST THIS DRAWING BE USED FOR CONSTRUCTION PURPOSES

NOTES  
 Reproduced from the Ordnance Survey mapping with the permission of the Controller of Her Majesty's Stationary Office © Crown Copyright. Unauthorised reproduction infringes Crown Copyright and may lead to prosecution or civil proceedings.  
 Highland Council License No 100023369

CONSTRUCTION RISKS  
 MAINTENANCE / CLEANING  
 DEMOLITION RISKS  
 In addition to the hazards/risks normally associated with the types of work detailed on this drawing take note of above.  
 It is assumed that all works on this drawing will be carried out by a competent contractor working, where appropriate, to an appropriate method statement.  
 SAFETY, HEALTH AND ENVIRONMENTAL INFORMATION BOX



Project Title  
**STROME FERRY APPRAISAL**

Drawing Title  
**OPTION - N6b  
 PLAN AND PROFILE  
 SHEET 2 OF 3**

Drawn: JH  
 Checked: JH  
 Approved: DT  
 Date: MARCH 2013  
 URS Internal Project No: 47065084  
 Scale @ A1: 1:10,000H, 1:5,000V  
 Zone / Mileage

URS Infrastructure & Environment Limited  
 6 Ardross Street  
 Inverness  
 IV3 5NN  
 0141 354 6050  
 www.urscorp.eu  
 Drawing Number: **47065084 - 5032**  
 Rev: **0**

**FINAL ISSUE**