

PLAN

SCALE 1:10,000

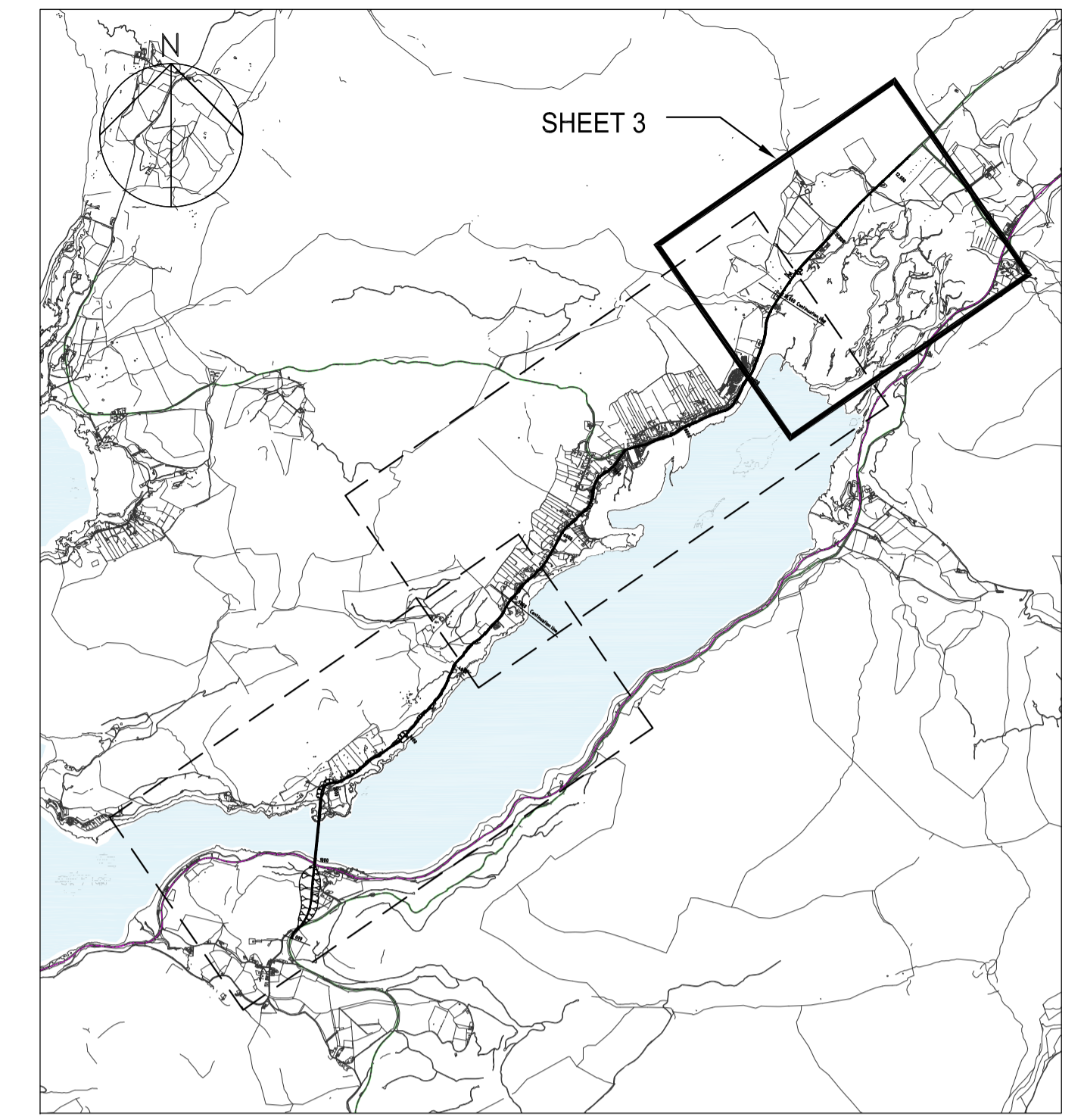

KEY PLAN

KEY

- Existing Railway
- Existing "A" Roads

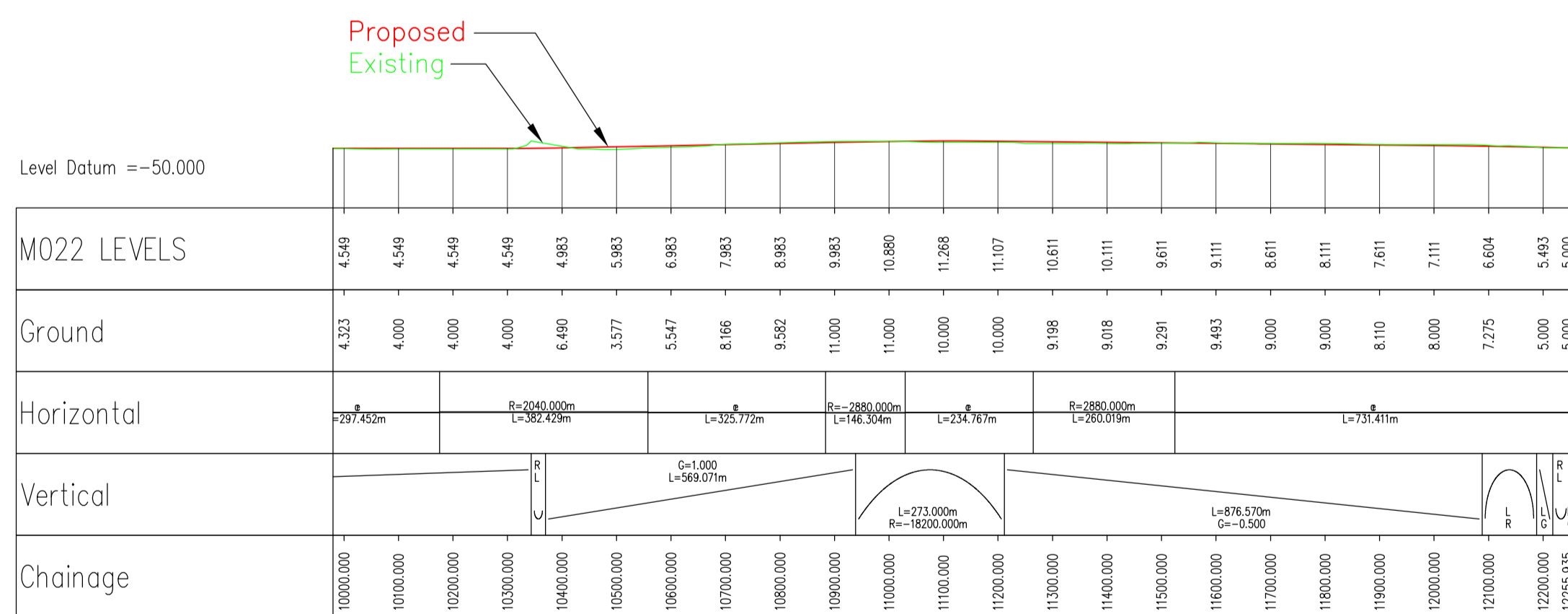

PROFILE

SCALE 1:10,000H, 1:5000V

This drawing is for preliminary purposes only and is subject to amendment during design development. UNDER NO CIRCUMSTANCES MUST THIS DRAWING BE USED FOR CONSTRUCTION PURPOSES

NOTES

Reproduced from the Ordnance Survey mapping with the permission of the Controller of Her Majesty's Stationary Office © Crown Copyright. Unauthorised reproduction infringes Crown Copyright and may lead to prosecution or civil proceedings.
Highland Council License No 100023369

CONSTRUCTION RISKS MAINTENANCE / CLEANING DEMOLITION RISKS

In addition to the hazards/risks normally associated with the types of work detailed on this drawing take note of above.
It is assumed that all works on this drawing will be carried out by a competent contractor working, where appropriate, to an appropriate method statement.
SAFETY, HEALTH AND ENVIRONMENTAL INFORMATION BOX

Purpose of Issue

PRELIMINARY



Client

Project Title

STROME FERRY APPRAISAL

Drawing Title

OPTION - N6b
PLAN AND PROFILE
SHEET 3 OF 3

Drawn

Checked

Approved

Date

URS Infrastructure & Environment Limited

JH

JL

DT

MARCH 2013

URS Internal Project No.

47065084

Subsidiary

6 Ardross Street

Inverness

IV3 5NN

0141 354 6050

www.urscorp.eu



Scale @ A1

1:10,000H, 1:5,000V

Zone / Mileage

This document has been prepared in accordance with the scope of URS' appointment with its client and is subject to the terms of that appointment. URS accepts no liability for any use of this document other than by its client and only for the purposes for which it was prepared and provided. Only written dimensions shall be used.
© URS Infrastructure & Environment Limited

Drawing Number

47065084 - 5033

Rev

0

FINAL ISSUE