

PLAN

SCALE 1:10,000

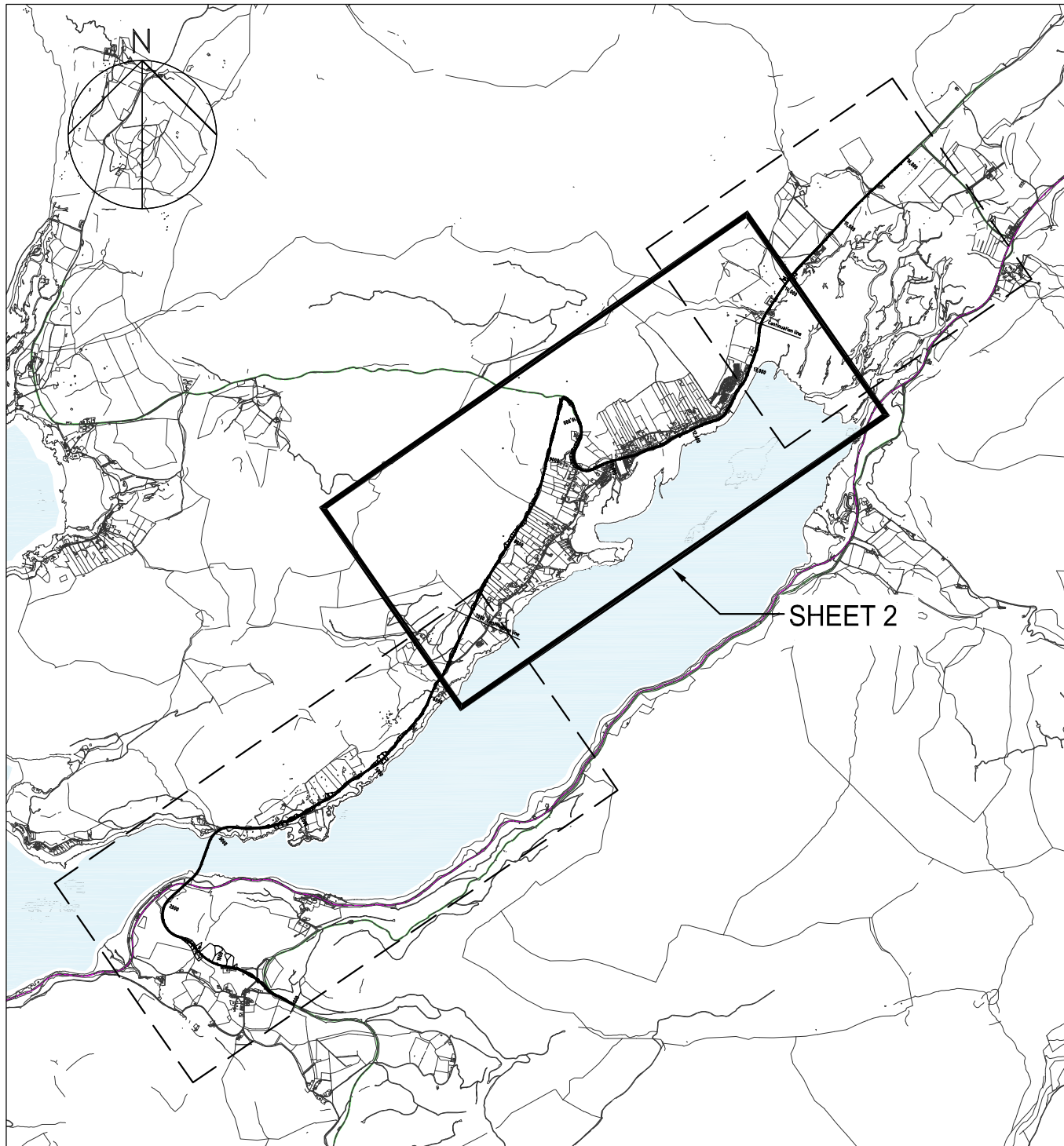

KEY PLAN

KEY

- Existing Railway
- Existing "A" Roads

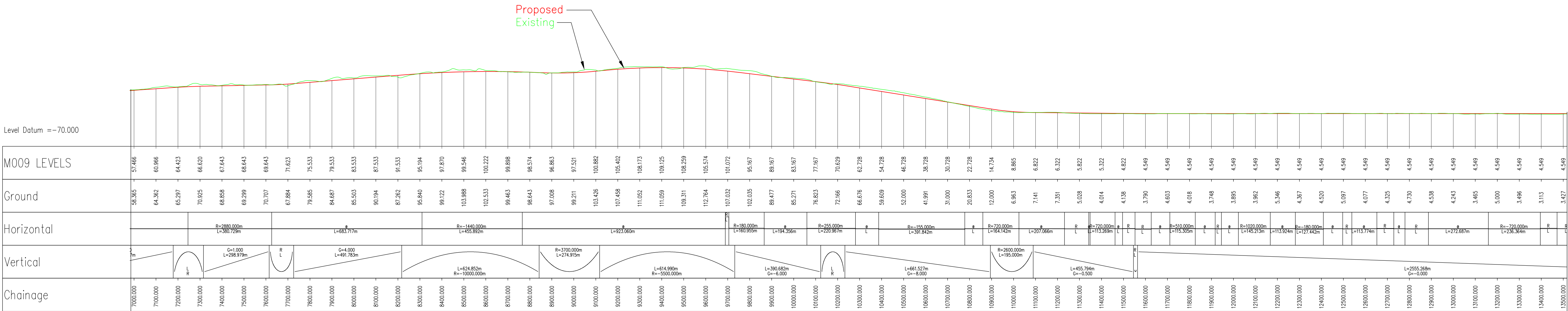

PROFILE

SCALE 1:10,000H, 1:5000V

FINAL ISSUE

This drawing is for preliminary purposes only and is subject to amendment during design development. UNDER NO CIRCUMSTANCES MUST THIS DRAWING BE USED FOR CONSTRUCTION PURPOSES

NOTES

Reproduced from the Ordnance Survey mapping with the permission of the Controller of Her Majesty's Stationary Office © Crown Copyright. Unauthorised reproduction infringes Crown Copyright and may lead to prosecution or civil proceedings.
Highland Council License No 100023369

CONSTRUCTION RISKS

MAINTENANCE / CLEANING RISKS

DEMOLITION RISKS

In addition to the hazard/risks normally associated with the types of work detailed on this drawing take note of above.
It is assumed that all works on this drawing will be carried out by a competent contractor working, where appropriate, to an appropriate method statement.
SAFETY, HEALTH AND ENVIRONMENTAL INFORMATION BOX

PRELIMINARY



Project Title

STROME FERRY APPRAISAL

Drawing Title

OPTION - N2b
PLAN AND PROFILE
SHEET 2 OF 3

Drawn

JH

Checked

JL

Approved

DT

Date

MARCH 2013

URS Internal Project No.

47065084

Scale @ A1

1:10,000H, 1:5,000V

Suitability

Zone / Mileage

URS Infrastructure & Environment Limited

6 Ardross Street

Inverness

IV3 5NN

0141 354 6050

www.urscorp.eu



Drawing Number

47065084 - 5012

Rev

0