

PLAN

SCALE 1:10,000

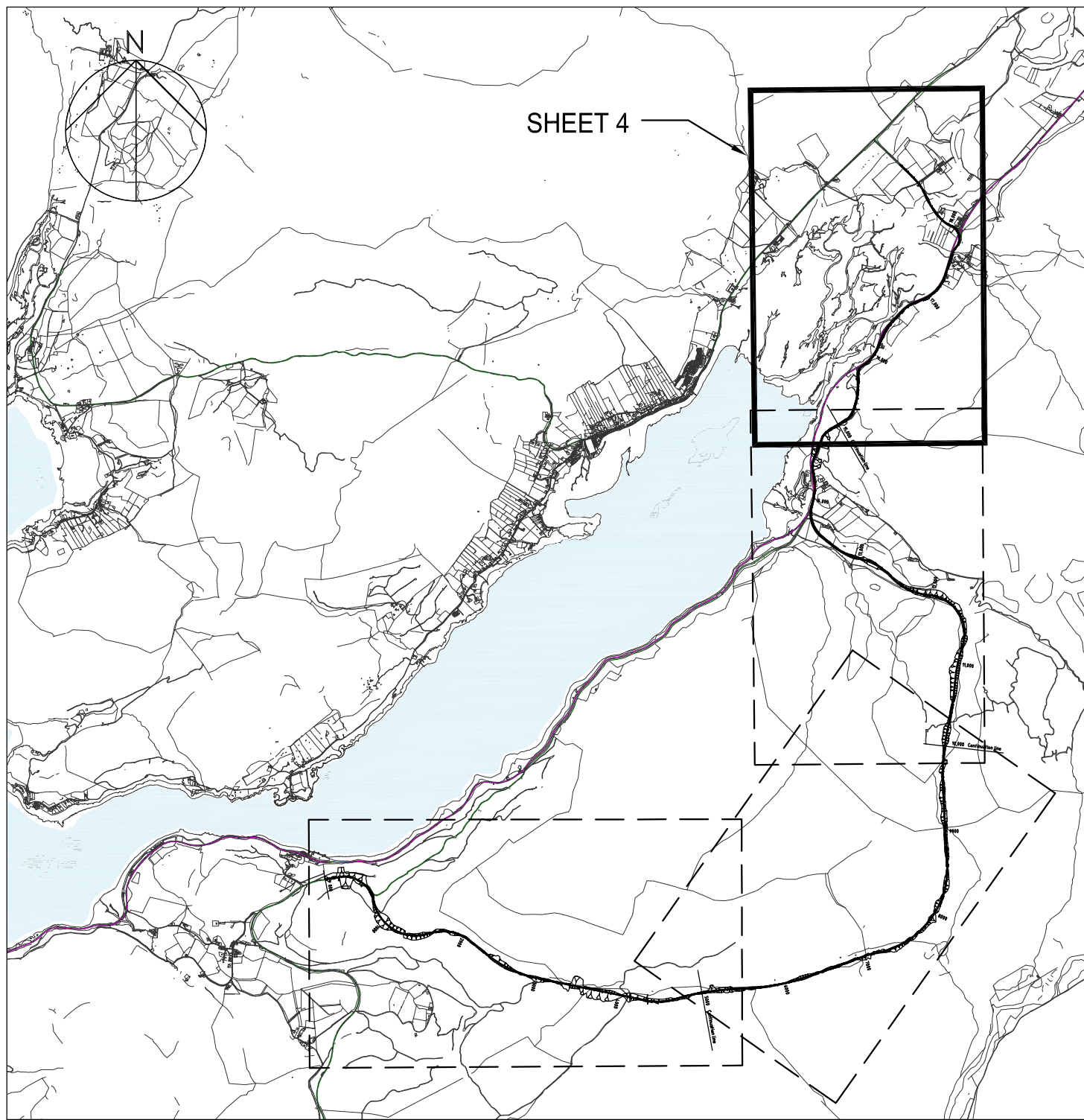

KEY PLAN

KEY

- Existing Railway
- Existing "A" Roads

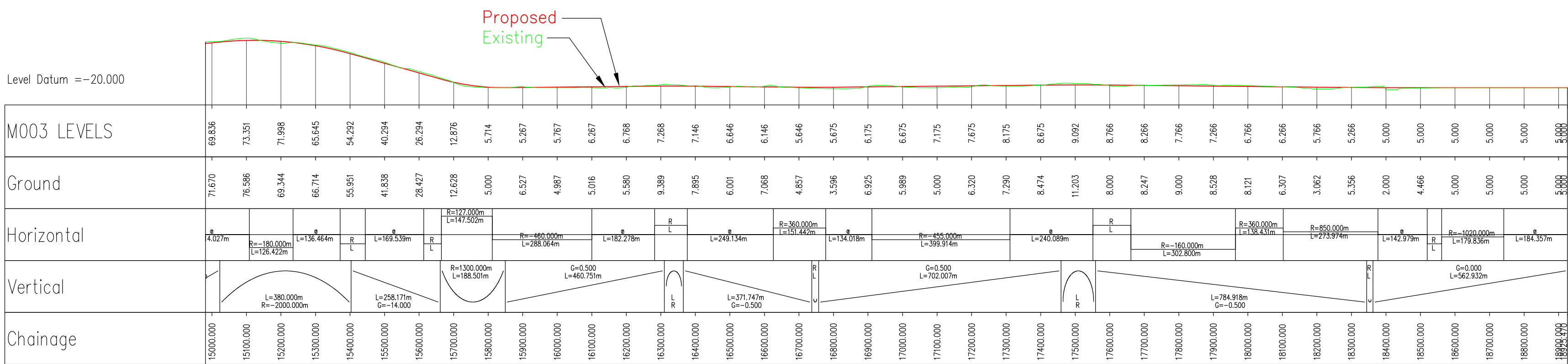

PROFILE

SCALE 1:10,000H, 1:5000V

FINAL ISSUE

This drawing is for preliminary purposes only and is subject to amendment during design development. UNDER NO CIRCUMSTANCES MUST THIS DRAWING BE USED FOR CONSTRUCTION PURPOSES

NOTES

Reproduced from the Ordnance Survey mapping with the permission of the Controller of Her Majesty's Stationary Office. Crown Copyright. Unauthorised reproduction infringes Crown Copyright and may lead to prosecution or civil proceedings.
Highland Council License No 100023369

CONSTRUCTION RISKS	MAINTENANCE / CLEANING RISKS	DEMOLITION RISKS
In addition to the hazard/risks normally associated with the types of work detailed on this drawing take note of above. It is assumed that all works on this drawing will be carried out by a competent contractor working, where appropriate, to an appropriate method statement. SAFETY, HEALTH AND ENVIRONMENTAL INFORMATION BOX		

PRELIMINARY



STROME FERRY APPRAISAL

OPTION - S1
PLAN AND PROFILE
SHEET 4 OF 4

Drawn JH	Checked JL	Approved DT	Date MARCH 2013
URS Internal Project No. 47065084		Suitability	
Scale @ A1 1:10,000H, 1:5000V		Zone / Mileage	
This document has been prepared in accordance with the scope of URS' appointment with its client and is subject to the terms of that appointment. URS accepts no liability for any use of this document other than by its client and only for the purposes for which it was prepared and provided. Only written dimensions shall be used. © URS Infrastructure & Environment Limited			

URS Infrastructure & Environment Limited
6 Ardross Street
Inverness
IV3 5NN
0141 354 6050
www.urscorp.eu



Drawing Number
47065084 - 5124

Rev
0