

PLAN

SCALE 1:10,000

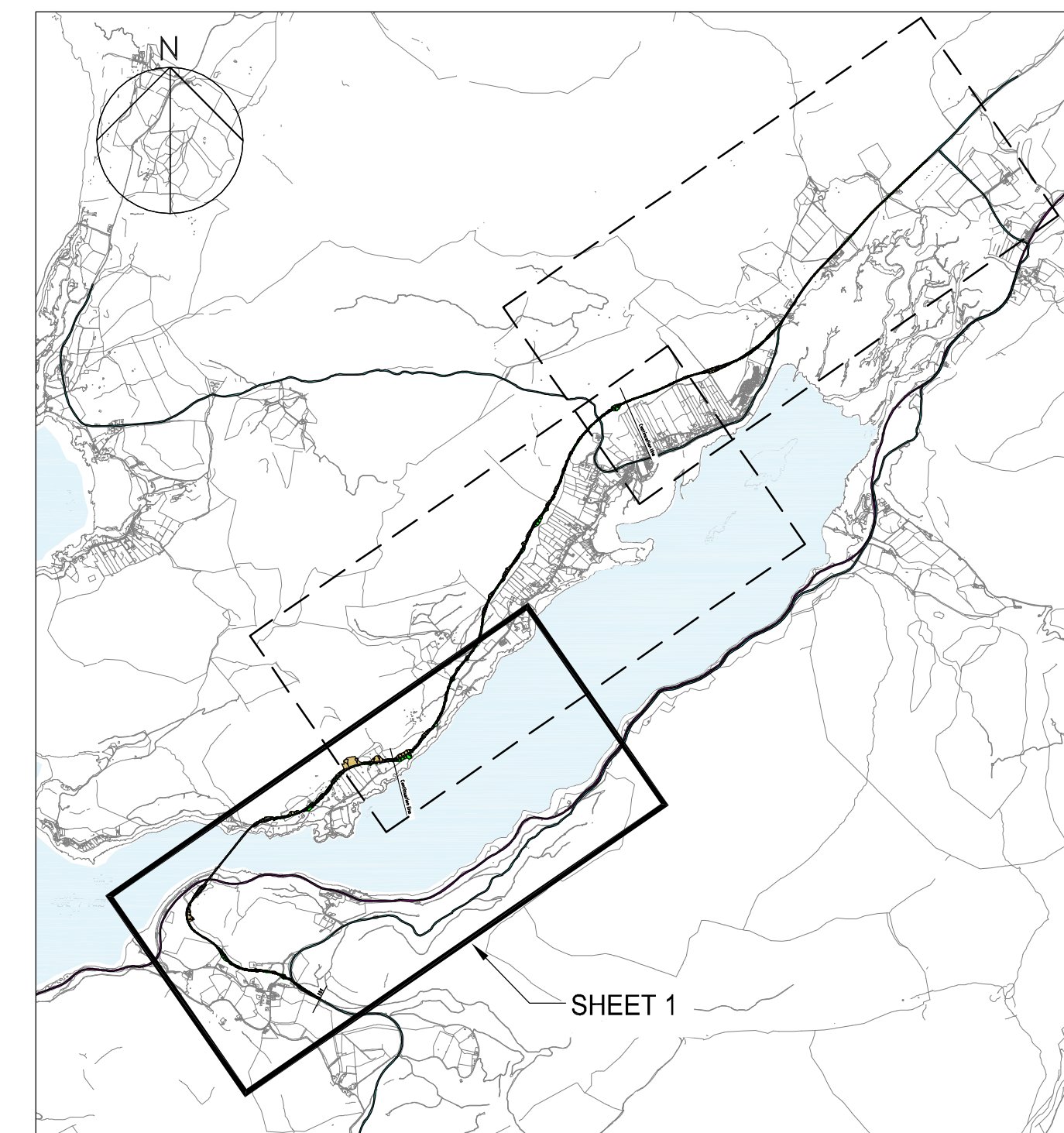

KEY PLAN

KEY

- Existing Railway
- Existing "A" Roads

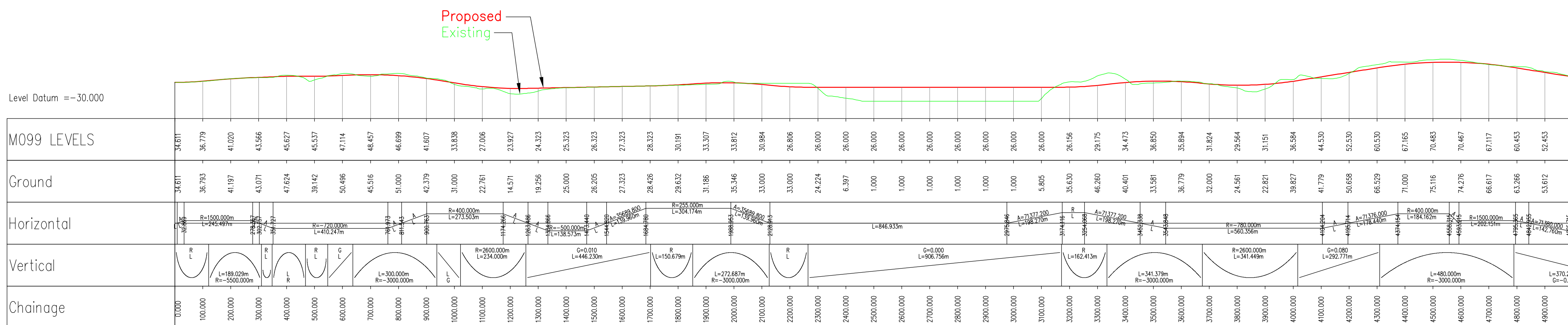

PROFILE

SCALE 1:10,000H, 1:5000V

This drawing is for preliminary purposes only and is subject to amendment during design development. UNDER NO CIRCUMSTANCES MUST THIS DRAWING BE USED FOR CONSTRUCTION PURPOSES

NOTES

Reproduced from the Ordnance Survey mapping with the permission of the Controller of Her Majesty's Stationary Office. Crown Copyright. Unauthorised reproduction infringes Crown Copyright and may lead to prosecution or civil proceedings.
Highland Council License No 100023369

CONSTRUCTION RISKS MAINTENANCE/CLEANING RISK DEMOLITION RISKS
In addition to the hazard/risks normally associated with the types of work detailed on this drawing take note of above.
It is assumed that all works on this drawing will be carried out by a competent contractor working, where appropriate, to an appropriate method statement.
SAFETY, HEALTH AND ENVIRONMENTAL INFORMATION BOX

PRELIMINARY



Project Title

STROMEFERRY STAGE 2

Drawing Title

NORTH PLAN AND PROFILE SHEET 1 OF 3

Drawn JH	Checked JL	Approved DT	Date MARCH 2014
URS Internal Project No. 47065084	Suitability -	Zone / Mtsage -	
Scale @ A1 1:10,000H, 1:5,000V	This document has been prepared in accordance with the scope of URS' appointment with its client and is subject to the terms of that appointment. URS accepts no liability for any use of this document other than by its client and only for the purposes for which it was prepared and provided. Only written dimensions shall be used. © URS Infrastructure & Environment Limited		

DRAFT ISSUE

URS Infrastructure & Environment Limited
6 Ainslie Street
Inverness
IV3 5NN
0141 354 6050
www.urscorp.eu



Drawing Number
47065084 - N1

Rev
0



PLAN

SCALE 1:10,000

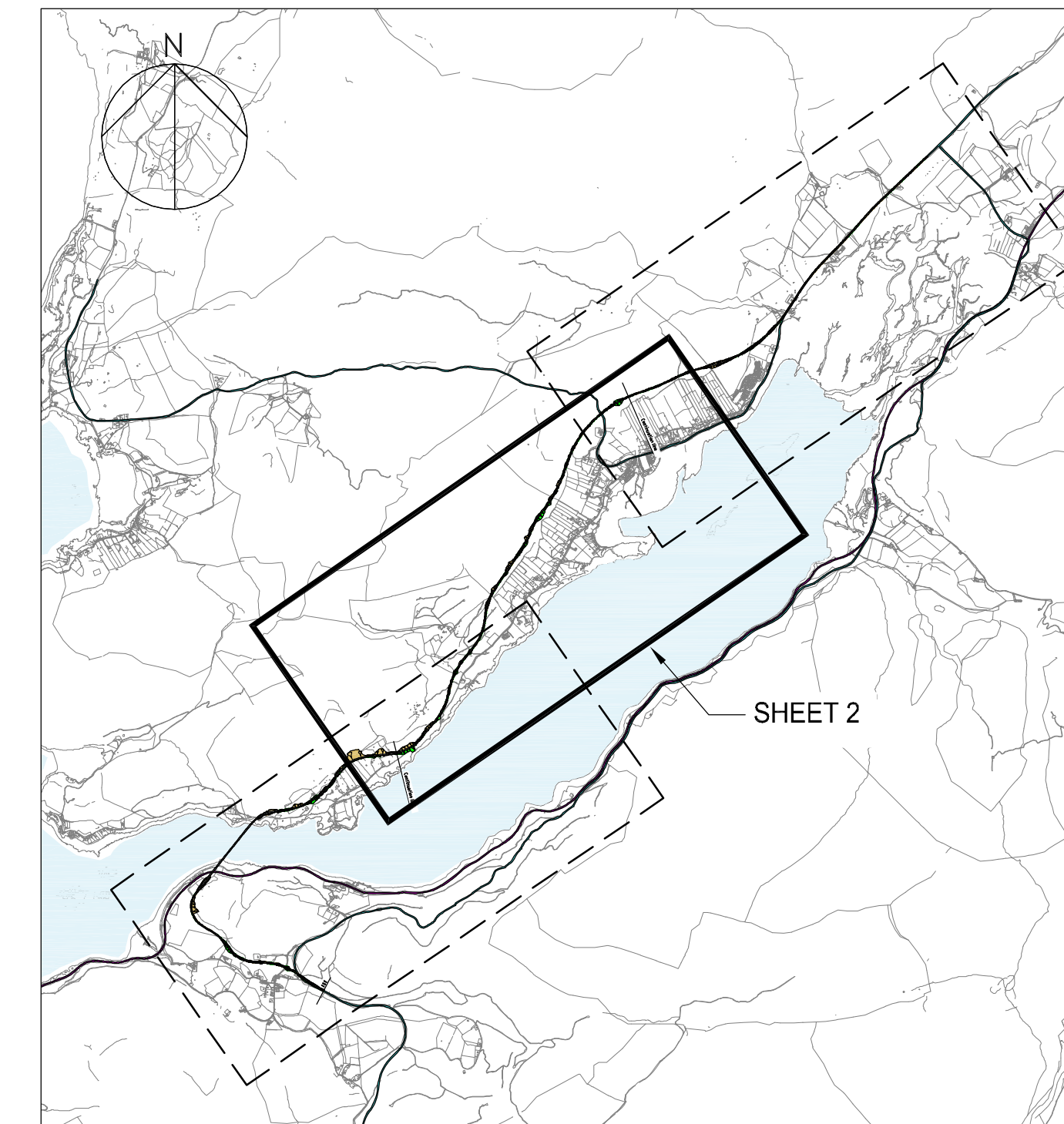

KEY PLAN

KEY

- Existing Railway
- Existing "A" Roads

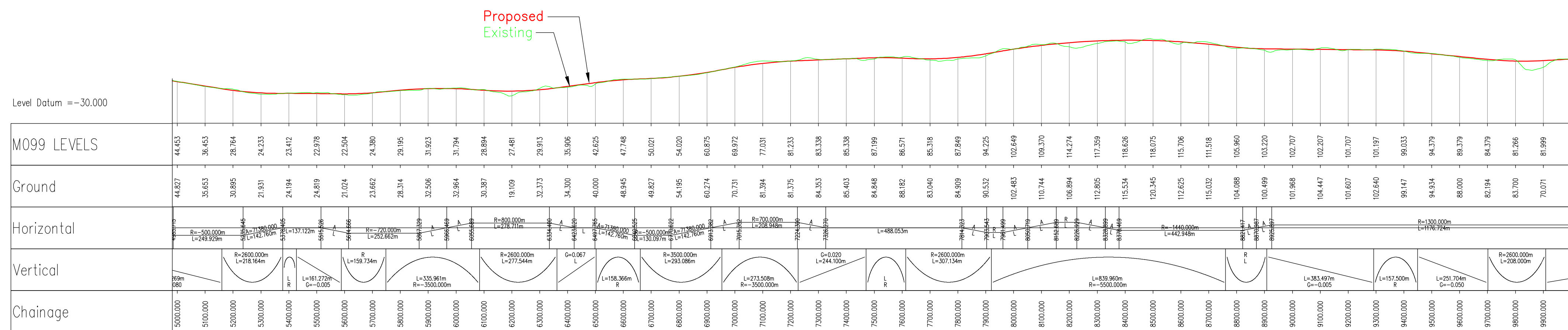

PROFILE

SCALE 1:10,000H, 1:5000V

DRAFT ISSUE

This drawing is for preliminary purposes only and is subject to amendment during design development. UNDER NO CIRCUMSTANCES MUST THIS DRAWING BE USED FOR CONSTRUCTION PURPOSES

NOTES
 Reproduced from the Ordnance Survey mapping with the permission of the Controller of Her Majesty's Stationary Office © Crown Copyright. Unauthorised reproduction infringes Crown Copyright and may lead to prosecution or civil proceedings.
 Highland Council License No 100023369

CONSTRUCTION RISKS	MAINTENANCE/CLEANING RISK	DEMOLITION RISKS
In addition to the hazard/risks normally associated with the types of work detailed on this drawing take note of above.		
It is assumed that all works on this drawing will be carried out by a competent contractor working, where appropriate, to an appropriate method statement.		
SAFETY, HEALTH AND ENVIRONMENTAL INFORMATION BOX		

Purpose of Issue: **PRELIMINARY**

Client: **The Highland Council**
Comhairle na Gàidhealtachd

Project Title: **STROMEFERRY STAGE 2**

Drawing Title: **NORTH PLAN AND PROFILE SHEET 2 OF 3**

Drawn: JH	Checked: JH	Approved: DT	Date: MARCH 2014
URS Internal Project No: 47065084	Suitability: -	Zone / Mts: -	
Scale: @ A1 1:10,000H, 1:5,000V	This document has been prepared in accordance with the scope of URS' appointment with its client and is subject to the terms of that appointment. URS accepts no liability for any use of this document other than by its client and only for the purposes for which it was prepared and provided. Only written dimensions shall be used. © URS Infrastructure & Environment Limited		

URS Infrastructure & Environment Limited
 6 Acrece Street
 Inverness
 IV3 5NN
 0141 354 6050
 www.urscorp.eu

URS

Drawing Number: **47065084 - N2**

Rev: **0**



PLAN
SCALE 1:10,000

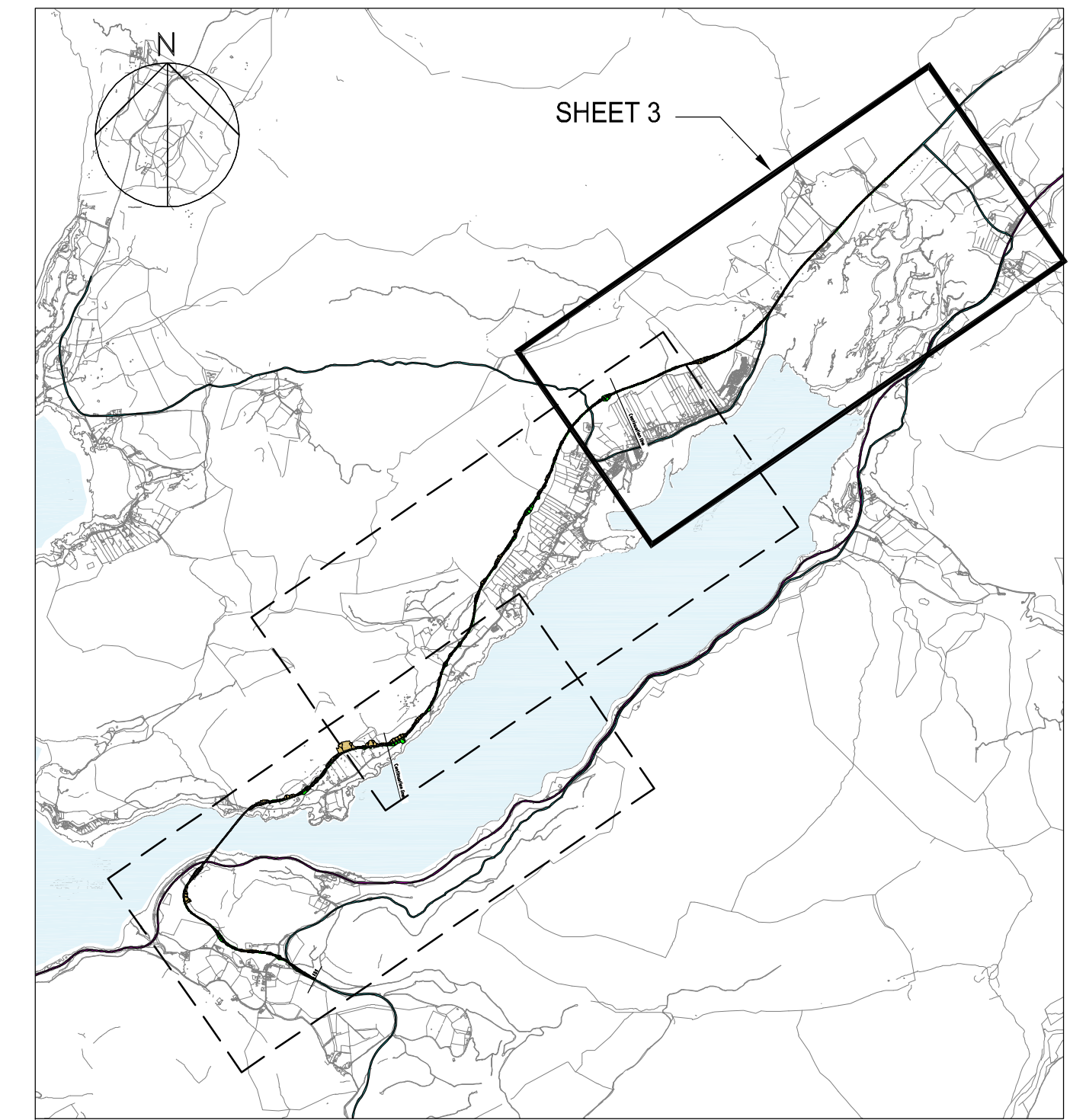

KEY PLAN

KEY

- Existing Railway
- Existing "A" Roads

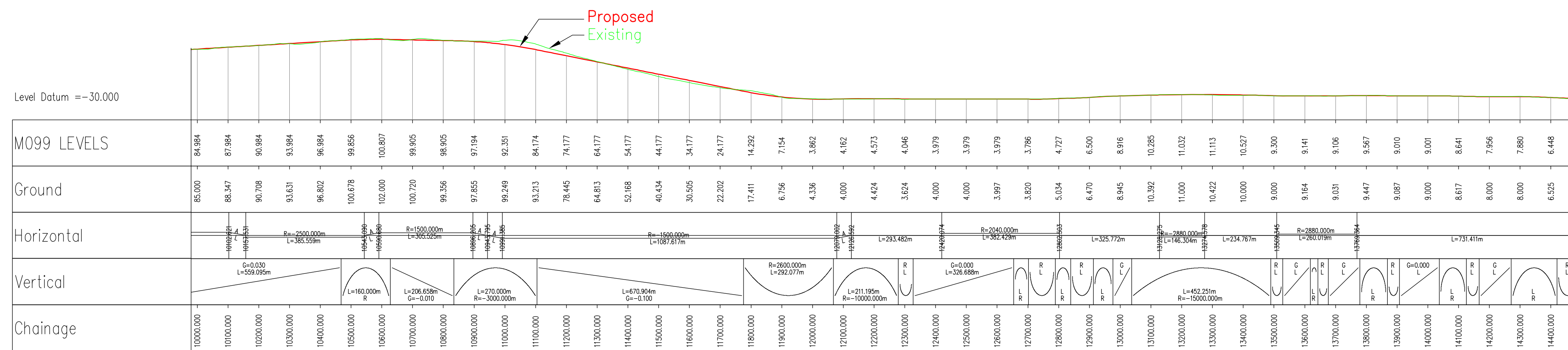

PROFILE
SCALE 1:10,000H, 1:5,000V

This drawing is for preliminary purposes only and is subject to amendment during design development. UNDER NO CIRCUMSTANCES MUST THIS DRAWING BE USED FOR CONSTRUCTION PURPOSES

By	Check	Date	Suffix

CONSTRUCTION RISKS	MAINTENANCE/CLEANING RISK	DEMOLITION RISKS

Purpose of Issue: **PRELIMINARY**

Client: **The Highland Council**
Comhairle na Gàidhealtachd

Project Title: **STROME FERRY STAGE 2**

Drawing Title: **NORTH PLAN AND PROFILE SHEET 3 OF 3**

Drawn	Checked	Approved	Date
JH	JL	DT	MARCH 2014

URS Internal Project No: 47065084
Scale: A1
1:10,000H, 1:5,000V

URS Infrastructure & Environment Limited
6 Access Street
D3 5NN
0141 354 6050
www.urscorp.au

URS

Drawing Number: **47065084 - N3**

Rev: **0**

DRAFT ISSUE