

This drawing should be read in conjunction with the NBS and all Architects, Structural Engineer, Mechanical engineer and specialist Equipment Suppliers Drawings. All drawing numbers quoted on drawing are to be read as current revisions, refer to drawing register for associated drawing nos. & revisions. Refer to details for construction information. Architect should be notified of any discrepancies prior to construction. **These drawings should not be scaled.**

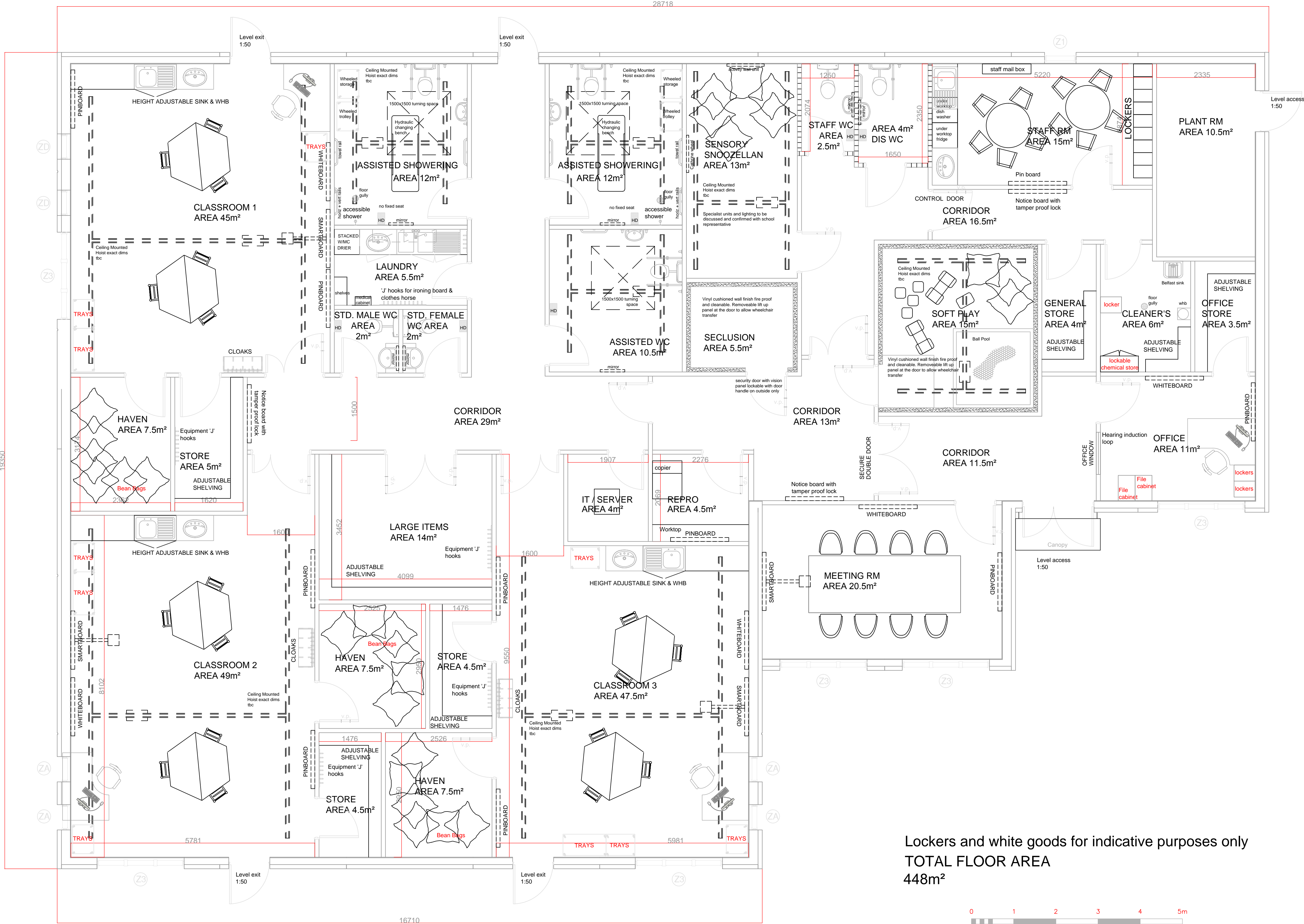

Lockers and white goods for indicative purposes only
TOTAL FLOOR AREA
448m²

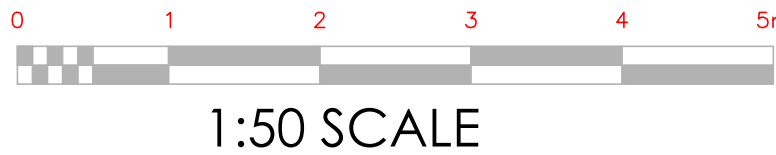

New Lane Huntington York YO32 9PT
01904 611655
www.portakabin-group.com

A Member Of The Portakabin Group

Client Robertson Northern	COLIN ARMSTRONG ASSOCIATES Chartered Architects				Drawing Title Floor Plan			
Project New Temporary Classroom Annexe St Clements School, Dingwall					Scale 1:50	A1	Date 25/03/14	Drawn by EH/SL
	LYLE HOUSE, PAVILION 1, FAIRWAYS BUSINESS PARK, INVERNESS, IV2 6AA.		TEL NO: 01463 712288 / FAX NO: 01463 712055 / EMAIL: architects@colinarmstrong.com		Job Number 1453		Drwg. No. P100(1)	Revision