

# SKETCH DESIGN ONE

timber sleepers

Sketch Design One is based on the principle that a coach can make a continuous 360 degree loop of the turning circle without overhanging private property. Materials have been suggested in line with the existing palette of materials, but with a renewed sense of style and creativity. Public art and interpretation provide inspirational and educational 'moments' throughout the site, which, together with the use of materials, help to unify and identify Chanonry Point as an attractive and pleasurable place to visit.

## illustrative cross-sections

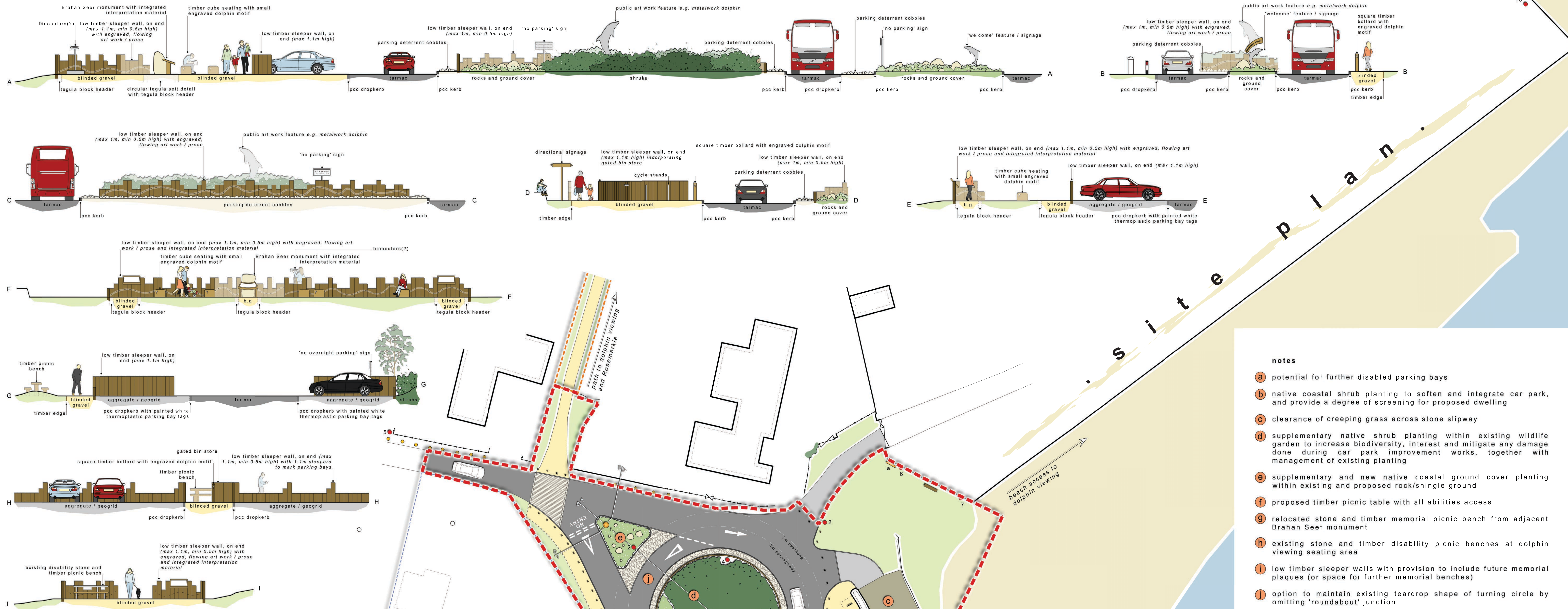

- main site boundary
- additional site boundary
- private land
- existing building
- existing wall
- existing timber fence
- existing gate
- existing post
- existing reflective post
- existing and proposed signage (refer to appropriate notes and survey photos)
- proposed timber bollard - square (lockable bollards hatched black with dashed outer line - key holders to be confirmed)
- existing/relocated picnic bench/seating
- proposed timber picnic bench/seating
- proposed timber cube seating
- proposed cycle stands (showing allowable space with dashed line)
- proposed gated bin store (2no. 360L wheely bins)
- proposed interpretation material (refer to appropriate notes)
- proposed public art/feature (refer to appropriate notes)
- proposed timber sleeper low wall (varying heights)
- proposed precast concrete kerb
- proposed precast concrete drop kerb (parking bays marked with painted thermoplastic tags along kerb)
- proposed timber edge
- proposed tegula sett/block edge
- proposed tegula block crossing detail
- proposed locally sourced rock and cobble parking deterrent (max height 150mm set in concrete)
- tarmac (existing and proposed)
- locally sourced aggregate (strengthened with geogrid)
- blinded gravel (existing and proposed)
- proposed native tree planting
- existing shrub planting
- proposed native shrub and ground cover planting (refer to appropriate notes)
- note
- illustrative cross-sections

- ### notes
- a - potential for further disabled parking bays
  - b - native coastal shrub planting to soften and integrate car park, and provide a degree of screening for proposed dwelling
  - c - clearance of creeping grass across stone slipway
  - d - supplementary native shrub planting within existing wildlife garden to increase biodiversity, interest and mitigate any damage done during car park improvement works, together with management of existing planting
  - e - supplementary and new native coastal ground cover planting within existing and proposed rock/shingle ground
  - f - proposed timber picnic table with all abilities access
  - g - relocated stone and timber memorial picnic bench from adjacent Brahan Seer monument
  - h - existing stone and timber disability picnic benches at dolphin viewing seating area
  - i - low timber sleeper walls with provision to include future memorial plaques (or space for further memorial benches)
  - j - option to maintain existing teardrop shape of turning circle by omitting 'roundabout' junction
- a - lighthouse interpretation material mounted on lighthouse stone wall
- b - proposed coastal interpretation material, including the relocation of existing material at the dolphin viewing area - b(8), displayed and installed tastefully within/on low timber sleeper wall
- c - proposed orientation interpretation material displayed and installed tastefully within/on low timber sleeper wall
- d - proposed historical interpretation material, including information on the Brahan Seer, displayed and installed tastefully around Brahan Seer monument stone
- e - proposed binoculars/compass point (?)
- 1 - existing/proposed directional signage
  - 2 - relocated 'no parking' signage
  - 3 - relocated 'no overnight parking' sign
  - 4 - relocated Ness Road street signage
  - 5 - proposed pedestrian warning signage - Dia No 544.1
  - 6 - existing life ring
  - 7 - existing 'Danger' sign
  - 8 - existing 'Danger' sign
- b(9) - relocated coastal interpretation material
- 10 - existing 'footpath to car park' and 'private no entry wall unsafe' signage

