

ROAD TRAFFIC REGULATION ACT 1984

THE HIGHLAND COUNCIL (OFF-STREET PARKING PLACES)
(DECRIMINALISED PARKING ENFORCEMENT AND CONSOLIDATION)
VARIATION FOUR ORDER 2025

THE HIGHLAND COUNCIL in exercise of its powers under Sections 1(1), 2(1) to (3), 4, 32, 33, 35, 35A, 35B and Part IV of Schedule 9 of the Road Traffic Regulation Act 1984 (“the 1984 Act”) as amended and of the Road Traffic Act 1991 (“the 1991 Act”) and the Road Traffic (Permitted Parking Area and Special Parking Area) (The Highland Council) Designation Order 2016 and of all other enabling powers, and after consultation with the Chief Constable of Police Scotland in accordance with Part III of Schedule 9 to the 1984 Act, hereby makes the following Order.

1. This Order shall come into operation on the 10th day of July 2026 and may be cited as “The Highland Council (Off-Street Parking Places) (Decriminalised Parking Enforcement and Consolidation) Variation Four Order 2025”
2. The Interpretation Act 1978 shall apply for the interpretation of this Order as it applies for the Interpretation of an Act of Parliament.
3. The prohibitions and restrictions imposed by this Order shall be in addition to and not in derogation from any restriction or requirement imposed by any regulation made or having effect as if made under the 1984 Act or by or under any other enactment provided that where a prohibition or restriction which is imposed, varied or revoked by this Order is in conflict with a prohibition or restriction imposed by a previous Order, then the provision of this Order shall prevail.
4. If a court, Transport Scotland or the Parking and Bus Lane Tribunal Service for Scotland declares any part of this Order to be invalid or un-enforceable, such declaration shall not invalidate the remainder of this Order.

5. The Highland Council (Off-Street Parking Places) (Decriminalised Parking Enforcement and Consolidation) Order 2016 as amended (hereinafter referred to as the "Principal Order") is hereby varied as follows: the details specified in Schedule 1 of this Order annexed and signed as relative hereto are added and substituted and incorporated into Schedule 1 to the Principal Order.
6. The Principal Order is hereby varied as follows: the details specified in Schedule 2 of this Order annexed and signed as relative hereto are added and substituted and incorporated into Schedule 2 to the Principal Order.
7. The Principal Order is hereby varied as follows: the parking place reference numbers specified and attached in Schedule 3 of this Order annexed are deleted from Schedule 3 to the Principal Order.
8. The Principal Order is hereby varied as follows: the plans specified in Schedule 4 of this order annexed and signed relative hereto are added and substituted and incorporated into Schedule 4 to the Principal Order

This Order and the Schedules annexed hereto are sealed with the Common Seal of The Highland Council and subscribed for and on behalf of The Highland Council by Emma Linn, Solicitor and Proper Officer, at Inverness on the 29th day of June 2026.



..... Proper Officer

This is the Schedule 1 referred to in the foregoing The Highland Council (Off-Street Parking Places) (Decriminalised Parking Enforcement and Consolidation) Variation Four Order 2025

SCHEDULE 1 – PAYMENT PARKING PLACES

Plan Ref. No. of Parking Place	Location of Parking Place	Name of Parking Place	Special classes of vehicle (if any) which can be parked in the Parking Place	Car Parking Charging Hours (Days and hours when charges will be made)	Days and hours of operation of controls and maximum stay in the Parking Place
CP0091	Fort William	Nevis Centre - Car Park		Mon to Sun 24 hours	Monday to Sunday inclusive. 24 hours. 10 hrs Max Stay.
CP0241	Arisaig	Camusdarach - Car Park	No Vehicles from 10pm - 6am	Mon to Sun 24 hours	Monday to Sunday inclusive. 24 hours. 24 hrs Max Stay.
CP0239	Glen Etive	Glen Etive Road End - Car Park	Motorhomes 8am - 10pm	Mon to Sun 24 hours	Monday to Sunday inclusive. 24 hours. 24hrs Max Stay.
CP0143	Glen Nevis	Glen Nevis Road End - Car Park	Motorhomes 8am - 10pm	Mon to Sun 24 hours	Monday to Sunday inclusive. 24 hours. 24hrs Max Stay.
CP0206	Lochaber	Achintee Road End - Car Park	Motorhomes 8am - 10pm	Mon to Sun 24 hours	Monday to Sunday inclusive. 24 hours. 24hrs Max Stay.
CP0094	Ben Nevis	Ben Nevis Visitor Centre - Car Park	Motorhomes 8am - 10pm	Mon to Sun 24 hours	Monday to Sunday inclusive. 24 hours. 24hrs Max Stay.

 Proper Officer

This is the Schedule 2 referred to in the foregoing The Highland Council (Off-Street Parking Places) (Decriminalised Parking Enforcement and Consolidation) Variation Four Order 2025

SCHEDULE 2 – OFF STREET CAR PARK TABLE OF TARIFFS

Plan ref.no. of Parking Place	Location of Parking Place	Scale of Charges	
CP0091	Fort William, Nevis Centre - Car Park Pay & Display No Motorhomes	Up to 15 mins (With Free ticket)	£0.00
		Up to 1 Hrs	£1.00
		Up to 2 Hrs	£2.00
		Up to 4 Hrs	£3.00
		Up to 10 Hrs	£5.00
CP0241	Arisaig, Camusdarach - Car Park Pay & Display No Vehicles from 10pm-6am	Up to 1 Hr (with FREE Ticket)	£0.00
		Up to 3 Hrs	£3.00
		Up to 6 Hrs	£4.00
		Up to 12 Hrs	£5.00
CP0239	Glen Etive, Road End - Car Park Pay & Display No Motorhomes 10pm-8am	Up to 3 Hrs	£3.00
		Up to 6 Hrs	£4.00
		Up to 12 Hrs	£5.00
		Up to 24 Hrs	£10.00
CP0143	Glen Nevis, Road End - Car Park Pay & Display No Motorhomes 10pm-8am	Up to 3 Hrs	£3.00
		Up to 6 Hrs	£4.00
		Up to 12 Hrs	£5.00
		Up to 24 Hrs	£10.00
CP0206	Lochaber, Achintee Road End - Car Park Pay & Display No Motorhomes 10pm-8am	Up to 3 Hrs	£3.00
		Up to 6 Hrs	£4.00
		Up to 12 Hrs	£5.00
		Up to 24 Hrs	£10.00
CP0094	Ben Nevis Visitor Centre - Car Park Pay & Display No Motorhomes 10pm-8am	Up to 1 Hrs	£2.00
		Up to 2 Hrs	£4.00
		Up to 3 Hrs	£6.00
		Up to 24 Hrs	£8.00

 Proper Officer

This is the Schedule 3 referred to in the foregoing The Highland Council (Off-Street Parking Places) (Decriminalised Parking Enforcement and Consolidation) Variation Four Order 2025

SCHEDULE 3

Off Street Parking Places with the following Reference Numbers thereon are deleted from the Table in Schedule 3 from The Highland Council (Off-Street Parking Places) (Decriminalised Parking Enforcement and Consolidation) Order 2016 as amended

CP0143

CP0241

..... Proper Officer

This is the Schedule 4 referred to in the foregoing The Highland Council (Off-Street Parking Places) (Decriminalised Parking Enforcement and Consolidation) Variation Four Order 2025

SCHEDULE 4 – PLANS OF CAR PARKS

The following Plans thereon are added and substituted and incorporated into Schedule 4 to The Highland Council (Off-Street Parking Places) (Decriminalised Parking Enforcement and Consolidation) Order 2016 as amended

CP0091

CP0094

CP0143

CP0206

CP0239

CP0241

..... Proper Officer

CAR PARK NAME: Nevis Centre Car Park, Fort William

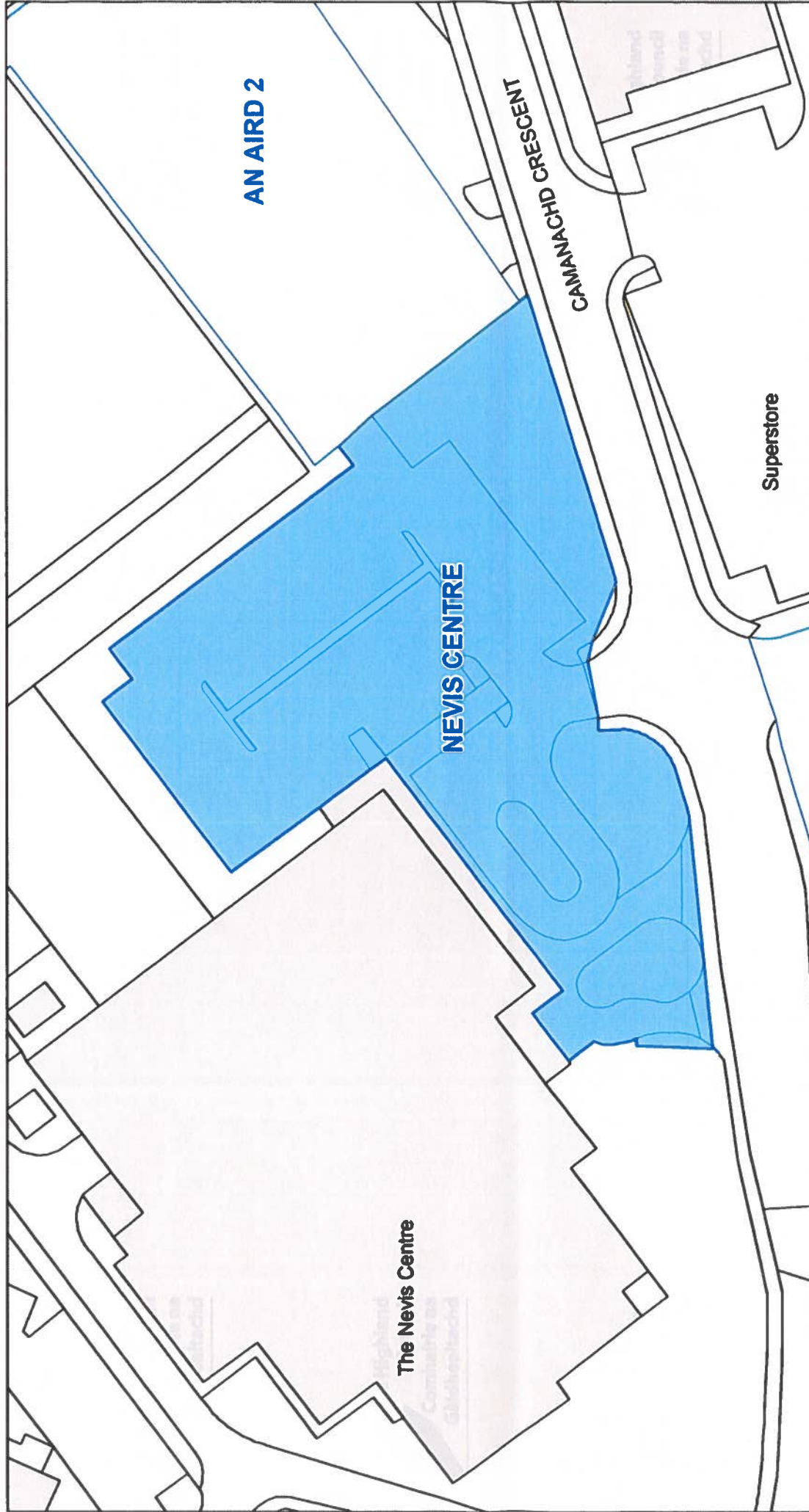

SCALE	1:500
DATE	10/07/2026
REFERENCE NUMBER	CP0091

**The Highland Council**
Comhairle na Gàidhealtachd

The Highland Council
Headquarters
Glenquhart Rd
Inverness
IV35NX





This is the Off-Street Plan (CP0091) referred in the foregoing

The Highland Council (Off-Street Parking Places) (Decriminalised Parking Enforcement and Consultation) (Variation Four) Order 2026

Signed by Proper Officer

© Crown copyright and database right 2025 Ordnance Survey 1000504327
The extent of the restrictions are 716.620 to 774.277 metres eastings, and 718.817 to 774.625 northings along the Inverness Road (P1005 27700)

CAR PARK NAME: Ben Nevis Visitor Centre Car Park, Glen Nevis

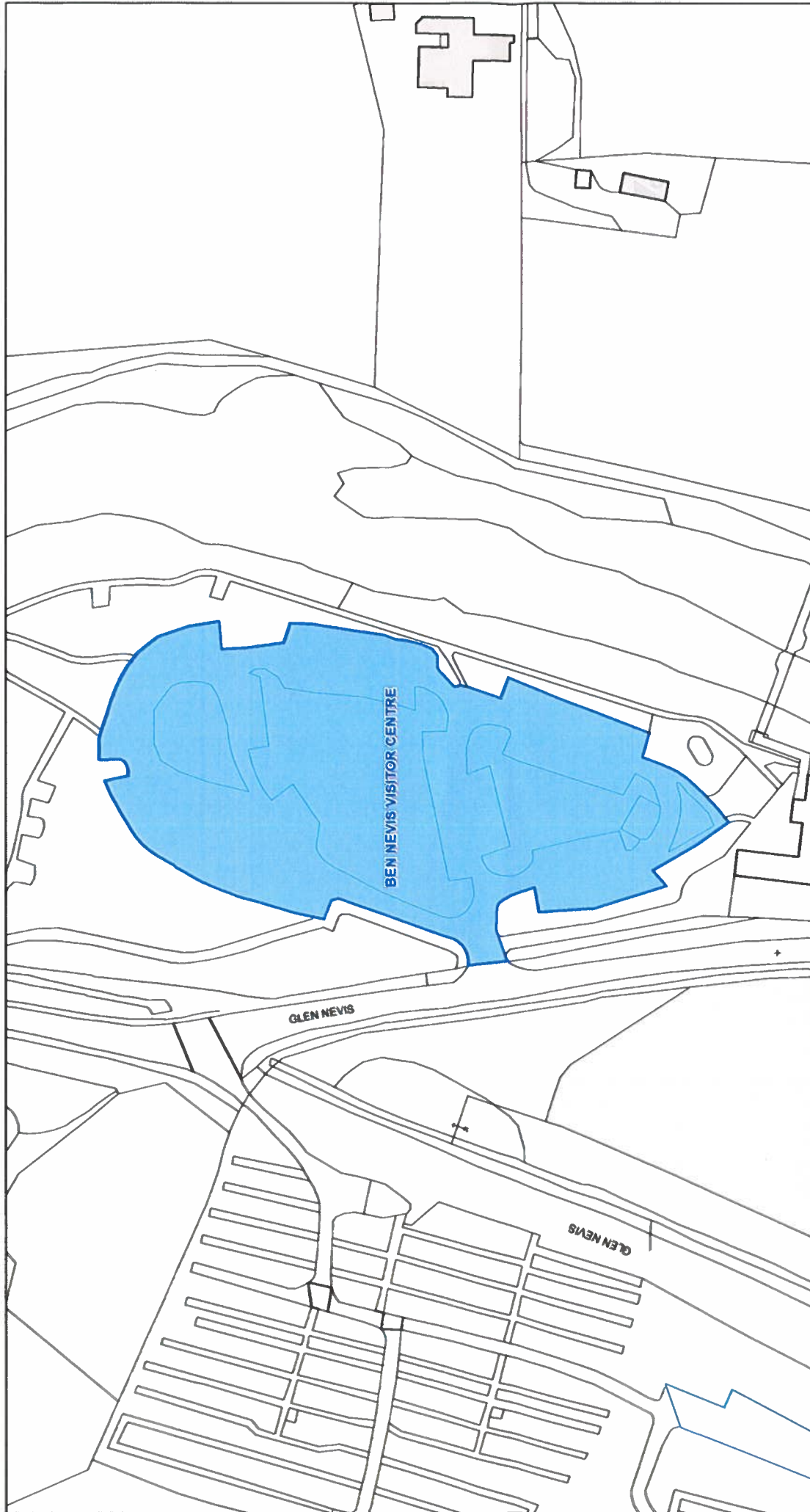

SCALE	1:900
DATE	10/07/2026
REFERENCE NUMBER	CP0094







The Highland Council
 Comhairle na Gàidhealtachd
 The Highland Council
 Headquarters
 Glenquhart Rd
 Inverness
 IV35NX

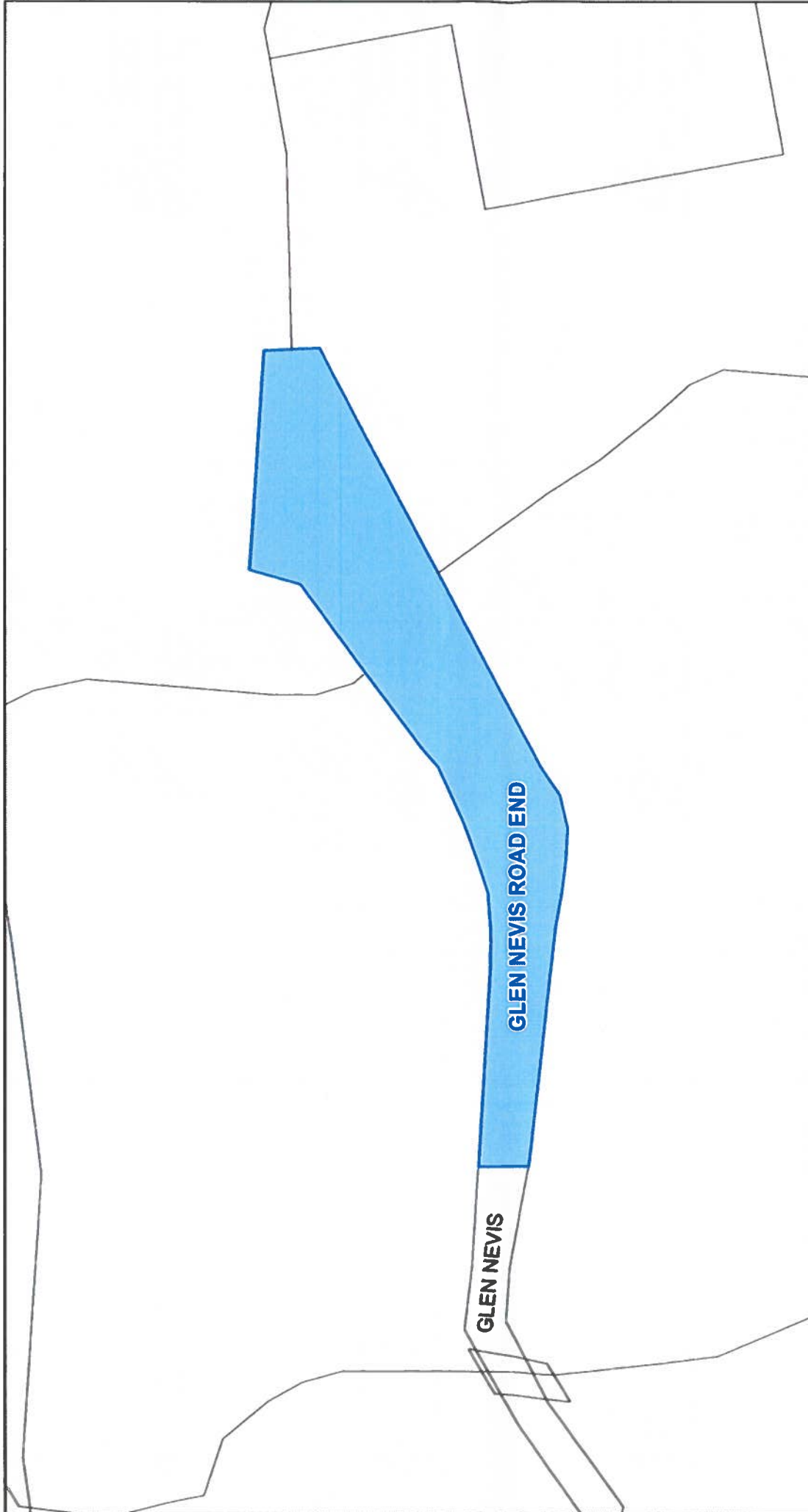

 This is the Off-Street Plan (CP0094) referred in the foregoing
 The Highland Council
 (Off-Street Parking Places)
 (Decentralised Parking Enforcement and Consultation)
 (Variation Four) Order 2025
 Signed by Proper Officer
© Crown copyright and database rights. Scottish Census Survey AC202004432
 The extent of the restrictions are 212, 128 to 772 004 metres
 eastings, 668 212, 628 to 772, 128
 northings using the British National Grid (EPSG: 27701).

CAR PARK NAME: Glen Nevis Road End Car Park, Glen Nevis

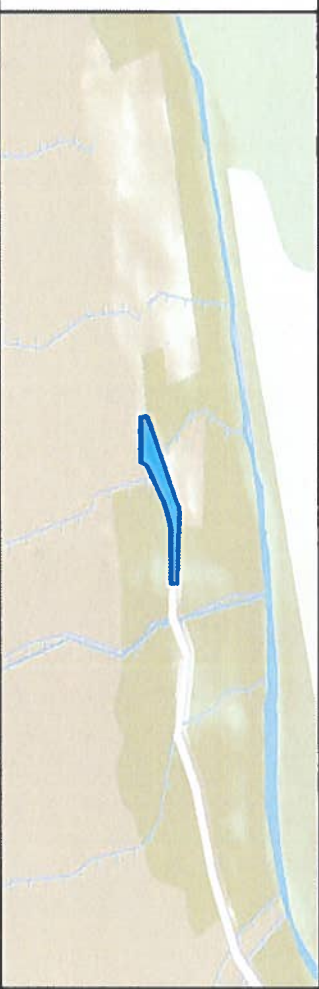

SCALE 1:500	DATE 10/07/2026	REFERENCE NUMBER CP0143	
 The Highland Council Comhairle na Gàidhealtachd The Highland Council Headquarters Inverness IV35NX			
			
<p>This is the Off-Street Plan (CP0143) referred in the foregoing</p> <p>The Highland Council (Off-Street Parking Places) (Discriminated Parking Enforcement and Consolidation) (Variation Four) Order 2026</p> <p></p> <p>Signed by Proper Officer</p> <p><small>© Crown Copyright and database rights 2025 Ordnance Survey 1000303432</small></p> <p><small>The extent of the restrictions are 273.753 to 337.870 metres eastwards and 274.070 to 657.770 metres northwards using the British National Grid (EPSG: 27700).</small></p>			

CAR PARK NAME:

Glen Etive Car Park, Glen Etive

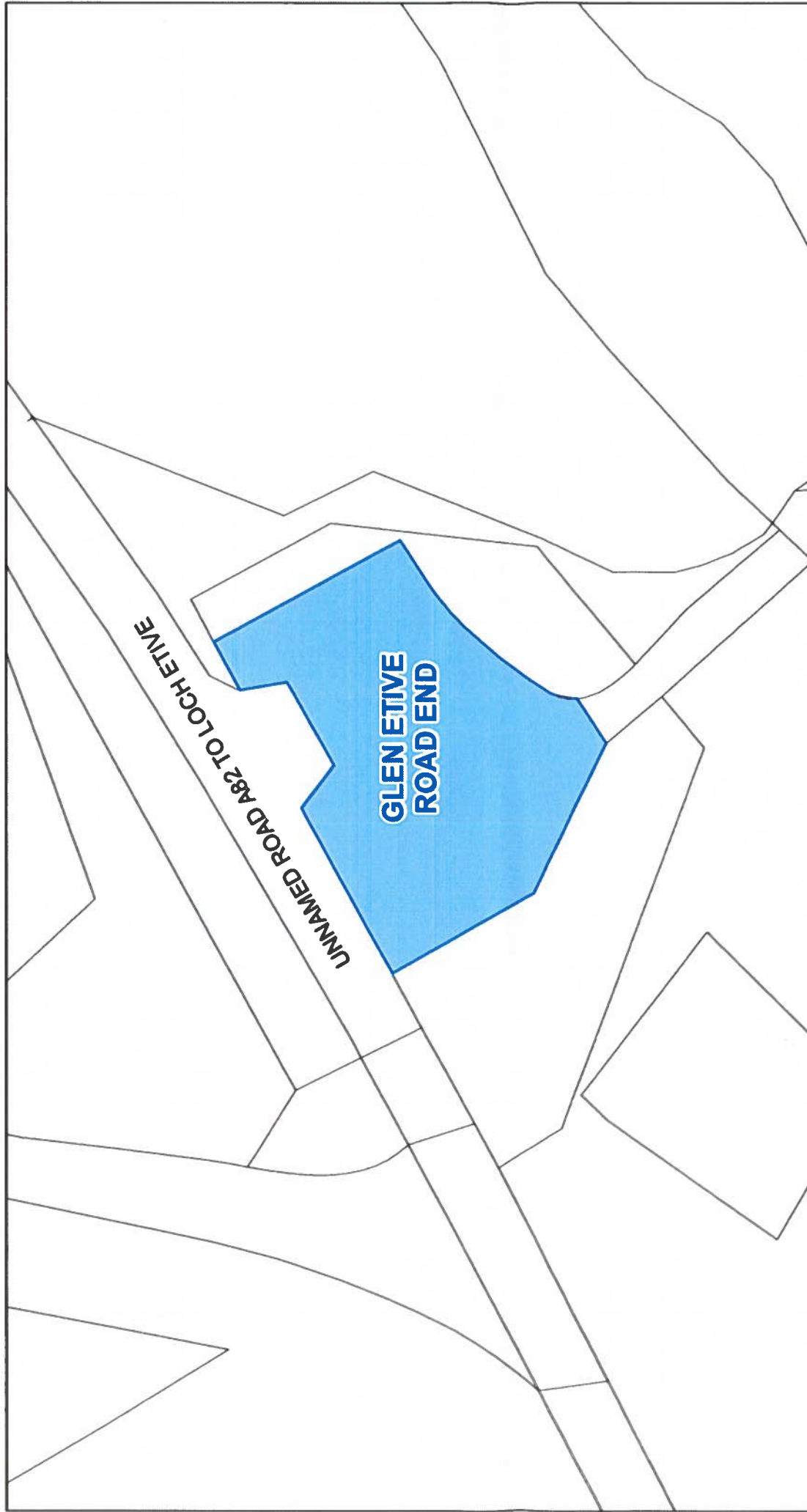



This is the Off-Street Plan (CP0239) referred in the foregoing

The Highland Council (Off-Street Parking Places) (Decentralised Parking Enforcement and Consolidation) (Variation Four) Order 2025

Signed by Proper Officer

© Crown copyright and database right 2025 Ordnance Survey. All rights reserved. Licence number: 100019070. The information is provided as a service to the public and is not intended to be used for any other purpose.





The Highland Council
Comhairle na Gàidhealtachd

The Highland Council
Headquarters
Glenquhart Rd
Inverness
IV35NX

SCALE	1:300
DATE	10/07/2026
REFERENCE NUMBER	CP0239
	

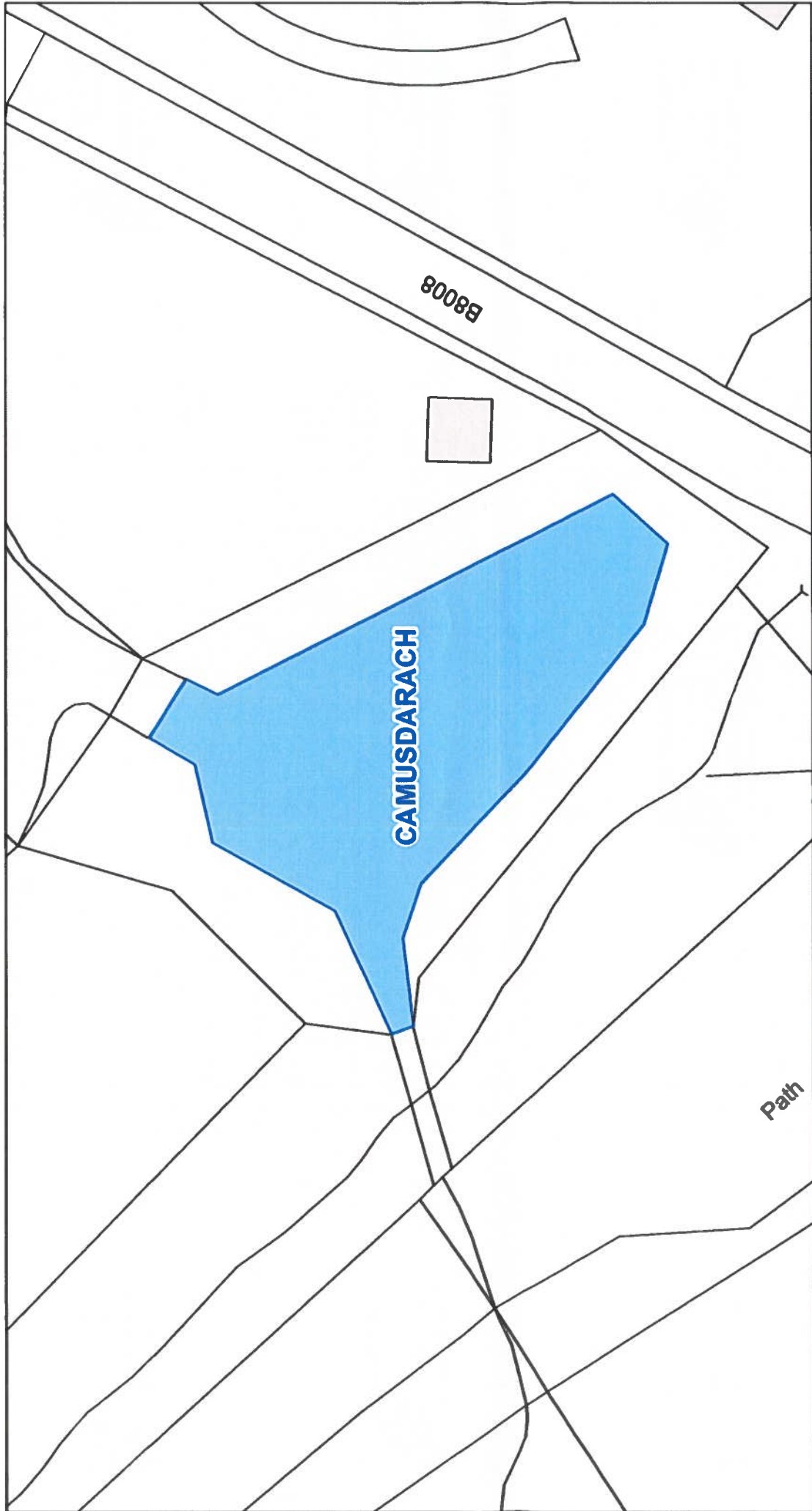
CAR PARK NAME: Camusdarach Car Park, Camusdarach



SCALE	1:275
DATE	10/07/2026
REFERENCE NUMBER	CP0241

The Highland Council
Comhairle na Gàidhealtachd
The Highland Council
Headquarters
Glenquhart Rd
Inverness
IV35NX





This is the Clif-Street Plan (CP0241) referred in the foregoing

The Highland Council (Clif-Street Parking Places) (Decriminalised Parking Enforcement and Consolidation) (Variation Four) Order 2025

Signed by Proper Officer

© Crown copyright and database rights 2025 Ordnance Survey 100046437
The extent of the restrictions are 211,427 to 745,310 metres eastwards and 211,220 to 745,252 westwards along the length of the Clif-Street (CP0241)